



# Quadrangle Tower

Cambridge Square, W2

Asking Price £745,000

Situated on the 14th floor of the sought-after Quadrangle Tower, this well-proportioned two-bedroom apartment offers 812 sq ft of bright, south-facing living space with stunning views over Hyde Park.

**CHESTERTONS**

## Quadrangle Tower, Cambridge Square, W2

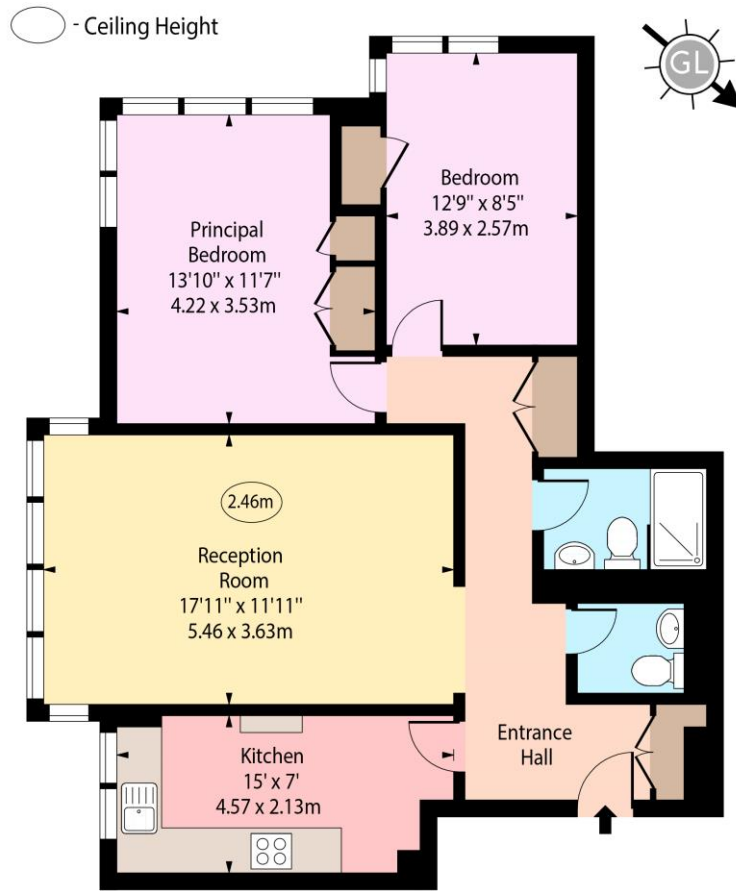

Fourteenth Floor

Approx Gross Internal Area      812 Sq Ft - 75.43 Sq M

For Illustration Purposes Only - Not To Scale  
www.goldens.co.uk  
Ref. No. 027647E

**Tenure:** Leasehold 150 years 7 months (24/12/2175)

**Service Charge:** £10140 per annum (hotwater and heating included)

**Ground Rent:** None

**Local Authority:** City of Westminster

**Council Tax Band:** G

Score	Energy rating	Current	Potential
92+	A		
81-91	B		
69-80	C	74 C	81 B
55-68	D		
39-54	E		
21-38	F		
1-20	G		

### *Chestertons Hyde Park & Marylebone Sales*

40 Connaught Street  
London  
W2 2AB  
hydepark@chestertons.co.uk  
020 7298 5900  
chestertons.co.uk

Chesterton UK Services Limited trading as Chestertons for themselves and for the vendor of this property whose agents they are, give notice that (i) these particulars do not constitute any part of an offer or contract, (ii) all statements contained within these particulars are made without responsibility on the part of Chestertons or the vendor, (iii) whilst made in good faith, none of the statements contained within these particulars are to be relied upon as a statement or representation of fact, (iv) any intending purchasers must satisfy themselves by inspection or otherwise as to the correctness of each of the statements contained within these particulars, (v) the vendor does not make or give either Chestertons or any person in their employment any authority to make or give representation or warranty whatsoever in relation to this property. Wide angle lenses may be used. ©Copyright Chestertons | Chesterton UK Services Limited | Registered Office 40 Connaught Street, Hyde Park, London W2 2AB Registered Company Number 05334580.

