



41 Princes Drive, Pontefract, WF8 4SP

Nestled on the desirable Princes Drive in Pontefract, this stunning detached house offers a perfect blend of modern living and comfort. Built in 2017, the property boasts a generous 1,313 square feet of well-designed space, making it an ideal family home.

Upon entering, you are greeted by two spacious reception rooms that provide ample space for relaxation and entertaining. The heart of the home features a contemporary design, ensuring a warm and inviting atmosphere. With four double bedrooms, there is plenty of room for family members or guests, each offering a peaceful retreat at the end of the day.

The property includes two well-appointed bathrooms, providing convenience for busy mornings and ensuring that everyone has their own space. The landscaped garden is a delightful outdoor area, perfect for enjoying sunny days, hosting barbecues, or simply unwinding in a tranquil setting.

Additionally, the double drive offers ample parking space, making it easy for you and your guests to come and go with ease. This home is not just a place to live; it is a sanctuary that combines style, comfort, and practicality in a sought-after location.

- A STUNNING 4 BED DETACHED HOME
- SOUGHT AFTER AREA
- 4 DOUBLE BEDROOMS
- EN SUITE
- LARGE OPEN PLAN KITCHEN DINER
- LANDSCAPED GARDEN
- DONT MISS THIS ONE!!

£405,000

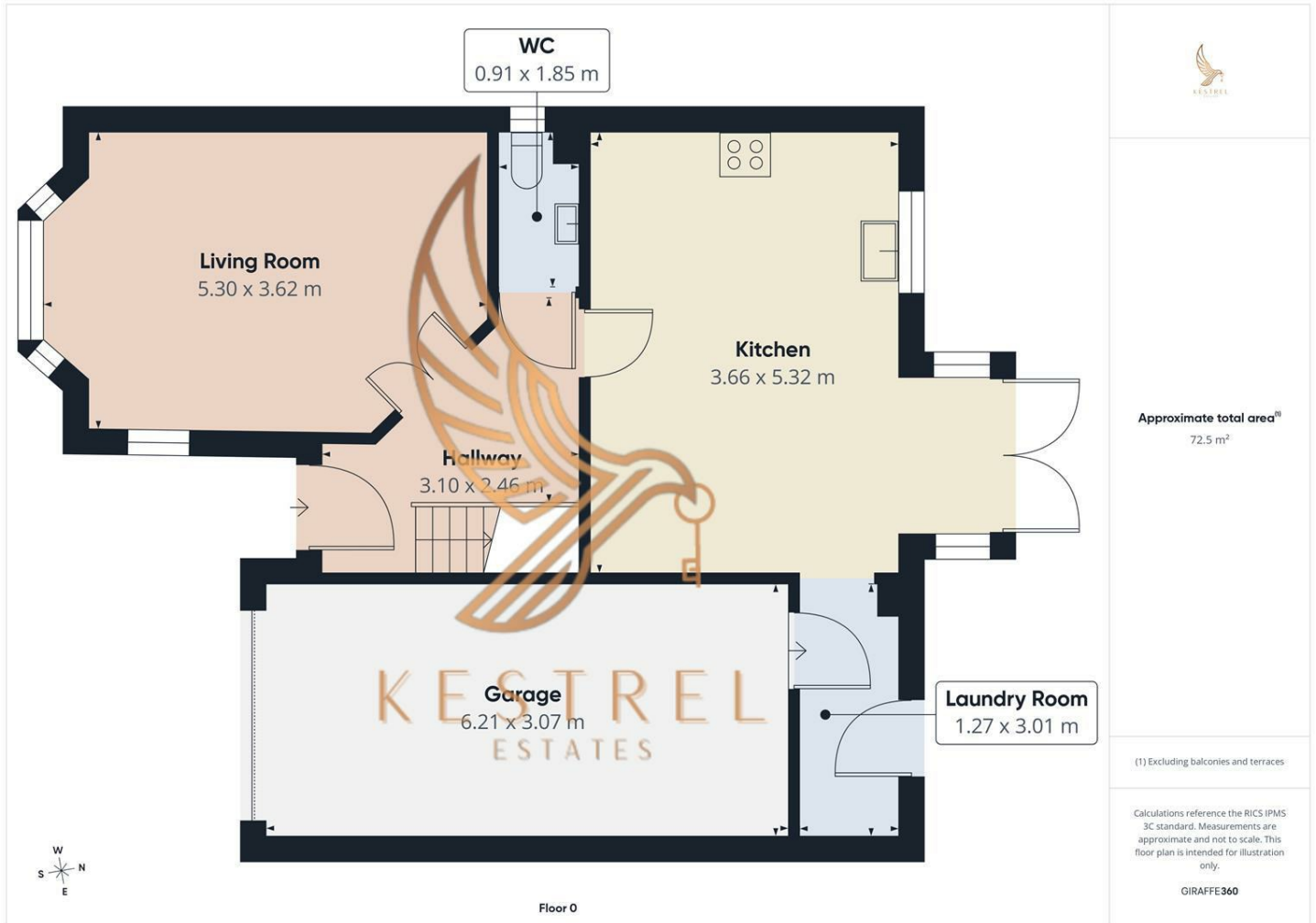

Energy Efficiency Rating		Current	Potential
Very energy efficient - lower running costs			
(92 plus) A			
(81-91) B			
(69-80) C			
(55-68) D			
(39-54) E			
(21-38) F			
(1-20) G			
Not energy efficient - higher running costs			
England & Wales		EU Directive 2002/91/EC	