





**£172,500**

Situated in the heart of Aston Clinton offering easy access to all local amenities this one bedroom first floor apartment has been well maintained and benefits include gas central heating and no onward chain.

# Property Description

## **COMMUNAL ENTRANCE**

Double glazed door to communal hall. Part glazed door to:

## **ENTRANCE HALL**

Stairs rising to first floor.

## **LANDING**

Double glazed window to side aspect. Access to loft space.

## **LOUNGE**

Double glazed bay window to front aspect. Radiator.

## **KITCHEN**

Double glazed window to front aspect. Fitted with a range of floor and wall-mounted units with work surface over, double bowl stainless steel sink units with mixer tap, plumbing for washing machine, built-in oven and hob with extractor fan over, part tiled walls, wall-mounted gas boiler.

## **BEDROOM ONE**

double glazed window to rear aspect. Radiator, built-in cupboard.

## **BATHROOM**

Double glazed window. White suite comprising panelled bath with mixer tap and shower attachment, pedestal wash hand basin, low level WC, part tiled walls, radiator.

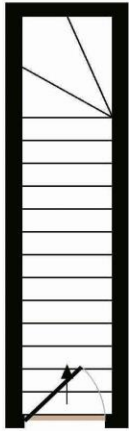

GROUND FLOOR

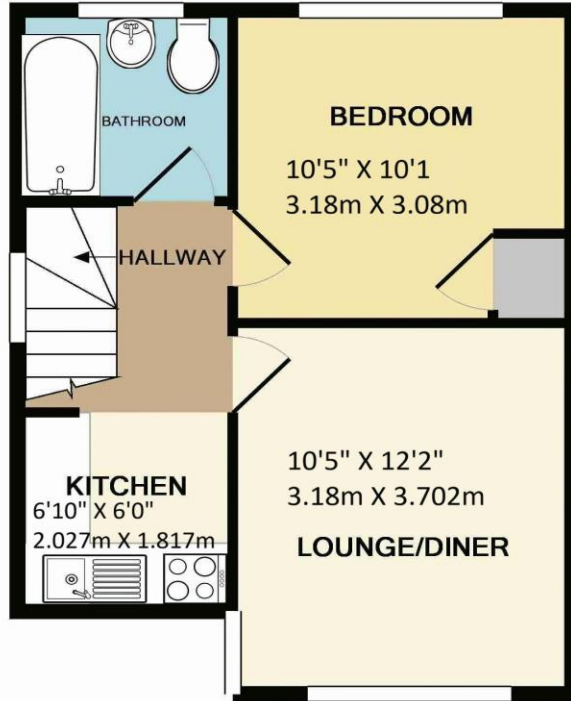

386 sqft  
117.56 sqm

1ST FLOOR

Whilst every attempt has been made to ensure the accuracy of the floor plan contained here, measurements of doors, windows, rooms and any other items are approximate and no responsibility is taken for any error, omission, or mis-statement. This plan is for illustrative purposes only and should be used as such by any prospective purchaser. The services, systems and appliances shown have not been tested and no guarantee as to their operability or efficiency can be given  
Made with Metropix ©2013

MONEY LAUNDERING REGULATIONS 2017 intending purchasers will be asked to produce identification and proof of financial status when an offer is received. We would ask for your co-operation in order that there will be no delay in agreeing the sale.

THE CONSUMER PROTECTION REGULATIONS 2008 The Agent has not tested any apparatus, equipment, fixtures and fittings or services and so cannot verify that they are in working order or fit for the purpose. A Buyer is advised to obtain verification from their Solicitor or Surveyor. References to the Tenure of a Property are based on information supplied by the Seller. The Agent has not had sight of the title documents. A Buyer is advised to obtain verification from their Solicitor. You are advised to check the availability of this property before travelling any distance to view. We have taken every precaution to ensure that these details are accurate and not misleading. If there is any point which is of particular importance to you, please contact us and we will provide any information you require. This is advisable, particularly if you intend to travel some distance to view the property. The mention of any appliances and services within these details does not imply that they are in full and efficient working order. These particulars are in draft form awaiting Vendors confirmation of their accuracy. These details must therefore be taken as a guide only and approved details should be requested from the agents

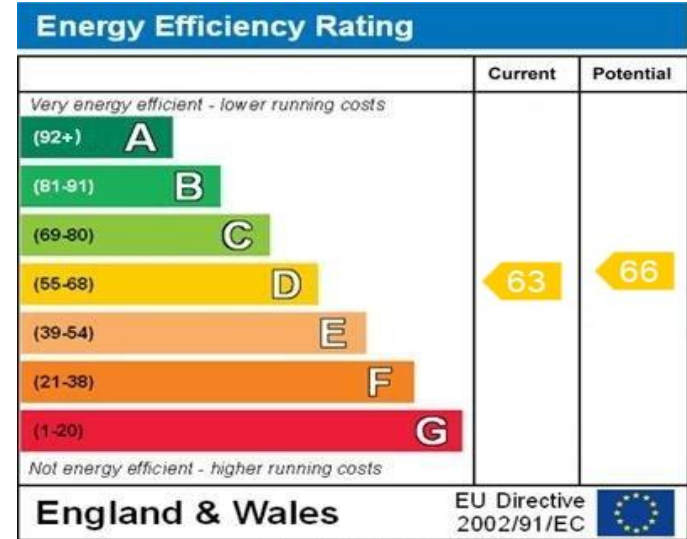

WWW.EPC4U.COM