

Acheson Road, Hall Green

Offers In Region Of £325,000

3 1 1



Modern Open-Plan Semi-Detached Home with Large Garden & Loads of Natural Light

Key Features

- Semi-detached family home
- Bright garden room with garden access
- Contemporary family bathroom
- Utility room for added convenience
- Detached garage to the rear
- Modern open-plan kitchen/diner
- Three bedrooms (two doubles, one single)
- Separate front lounge
- Large rear garden with excellent potential
- Ideal for families, first-time buyers, or upsizers

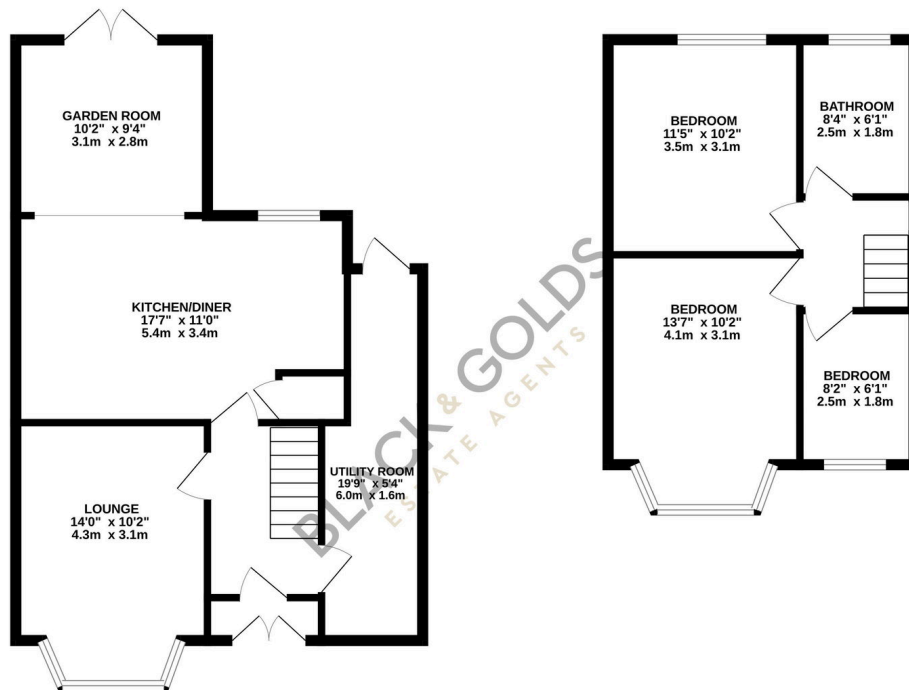

TOTAL FLOOR AREA: 968 sq.ft. (89.9 sq.m.) approx.

Whilst every attempt has been made to ensure the accuracy of the floorplan contained here, measurements of doors, windows, rooms and any other items are approximate and no responsibility is taken for any error, omission or mis-statement. This plan is for illustrative purposes only and should be used as such by any prospective purchaser. The services, systems and appliances shown have not been tested and no guarantee as to their operability or efficiency can be given.

Made with Metropix ©2026