



34 HIGH STREET, CHIPPENHAM, ELY, CB7 5PR  
£175,000

[TYLERS.NET](https://www.tylers.net)



**\*No onward chain\*** A 2-bedroom period cottage of about 570 sq ft, centrally positioned on the High Street in this beautiful and pretty village, with easy access to Newmarket and the A14.



Chippenham is a small pretty village located approximately 4 miles from Newmarket. The village has a range of facilities and activities including a Church, tennis and cricket clubs and a public house. Primary schooling is available in the nearby villages of Fordham and Kennett with secondary education in Newmarket.

- No onward chain
- Living room with fireplace
- First floor bathroom
- Council Band B



## Accommodation

This property has attractive period character features and combines modern conveniences.

The living room has a stone block floor, fireplace and window to the front. This room leads through into the kitchen/diner where there is a ceramic sink, woodburning stove, eye and base level units, tiled flooring and a stable door leading to a sheltered area with access to the brick store.

Upstairs are two bedrooms, a double bedroom and a single bedroom, and a bathroom. Electric heating and double glazing.

Outside, on street parking is available and storage shed. There is no garden with this property.

Tenure: Freehold

EPC: E

Council tax band: B

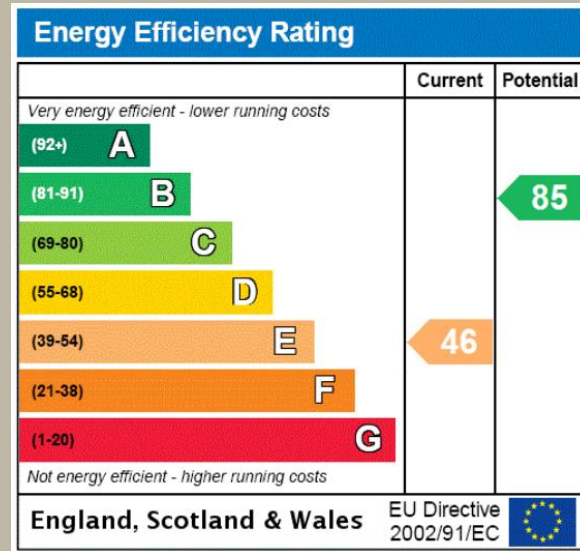

### Cambridge

104 Cherry Hinton Road  
Cambridge CB1 7AJ  
01223 214400

### Histon

19 High Street, Histon  
Cambridge CB24 9JD  
01223 235111

### Willingham

Stocks Corner, High Street  
Willingham, Cambs CB24 5ES  
01954 260952

### Newmarket

16a High Street  
Newmarket, Suffolk CB8 8LB  
01638 660303



GROUND FLOOR

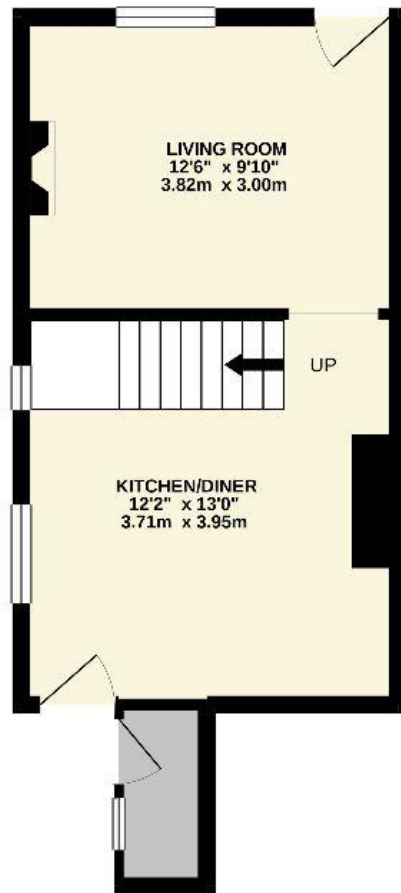

1ST FLOOR

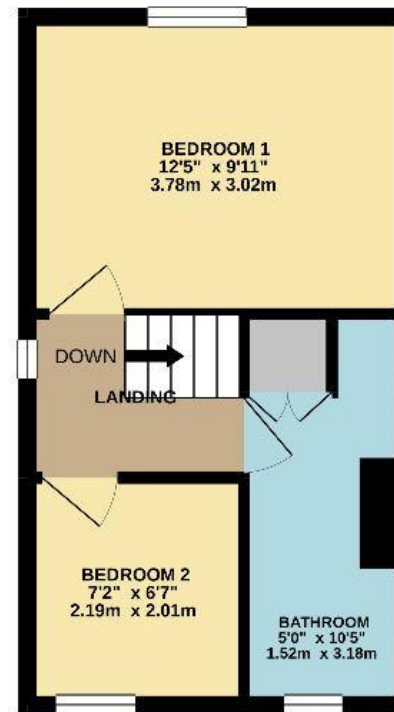

Whilst every attempt has been made to ensure the accuracy of the floor plan contained here, measurements of doors, windows, rooms and any other items are approximate and no responsibility is taken for any error, omission or mis-statement. This plan is for illustrative purposes only and should be used as such by any prospective purchaser. The services, systems and appliances shown have not been tested and no guarantee as to their operability or efficiency can be given.

As the sellers agent we are not surveyors or conveyancing experts and as such we cannot and do not comment on the condition of the property, or issues relating to title or other legal issues that may affect this property, unless we have been made aware of such matters. Interested parties should employ their own professionals to make such enquiries before making any transactional decisions.

Tylers for themselves and for the Vendors or Lessors of this property declare that these particulars are given as a general outline and whilst intended to be accurate do not constitute nor form any part of an offer or contract. Intending purchasers or tenants must satisfy themselves by personal inspection or otherwise as to the correctness of each statement. Fixtures, fittings and appliances have not been tested by Tylers. No person in the employment of Tylers has the authority to make or give any representation or warranty whatsoever in relation to this property. All measurements are approximate.



Tylers Independent Estate Agents is a trading name of Tylers Property Partnership Ltd  
Registered address; Salisbury House, Station Road, Cambridge, CB1 2LA Company Number 7535939 VAT Number 934 673 206

