



119, Club Garden Road, Sheffield, S11 8BW

# 119, Club Garden Road

Sheffield, S11 8BW

## Description

A larger than average five double bedroom terraced property that offers accommodation over three floors. This property is let as a five bed HMO at present, Returning £24'440 per annum. The location is popular, close to excellent local amenities on London Road, good transport links and within an easy walk of the city centre.

- Five double bedrooms.
- Two bath/shower rooms.
- Modern offshot kitchen.
- Dining room/lounge area.
- No onward chain but let until June 2026.
- Perfect for both owner occupiers and investors/landlords.
- Gas central heating and UPVC double glazing combining to produce an EPC rating of D55.
- Popular location, close to excellent local shops, transport links etc...
- Freehold, Council Tax Band A.
- Currently let as a 5 bed HMO until June 2026, returning £24'440 per annum.





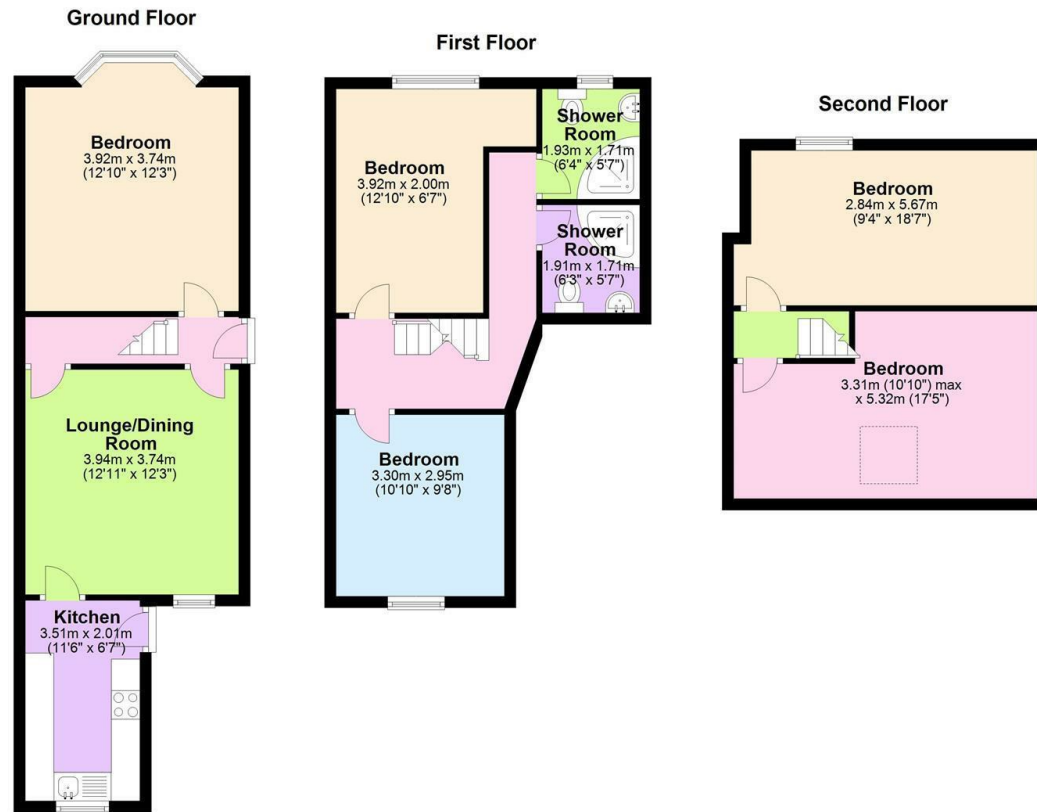

**Bakewell**  
 3 Royal Oak Place  
 Matlock Street  
 Bakewell DE45 1HD  
 T: 01629 700699  
 E: bakewell@elr.co.uk

**Banner Cross**  
 888 Ecclesall Road  
 Banner Cross  
 Sheffield S11 8TP  
 T: 01142 683388  
 E: bannercross@elr.co.uk

**Dore**  
 33 Townhead Road  
 Sheffield  
 S17 3GD  
 T: 0114 2362420  
 E: dore@elr.co.uk

**Hathersage**  
 Main Road, Hathersage  
 Hope Valley  
 Derbyshire S32 1BB  
 T: 01433 651888  
 E: peakdistrict@elr.co.uk

**Rotherham**  
 149 Bawtry Road  
 Wickersley  
 Rotherham S66 2BW  
 T: 01709 917676  
 E: wickersley@elr.co.uk

