



106 Kingston Avenue
, Leicester, LE18 1HN
Guide Price £220,000

106 Kingston Avenue

, Leicester, LE18 1HN

Two bedroom semi-detached property located off Welford Road within the popular Wigston Fields area, to the south of Leicester city centre. No upwards chain.

Location

Tenure

Council Tax Band

Important Notice

Measurements and Other Information





Floor Plan

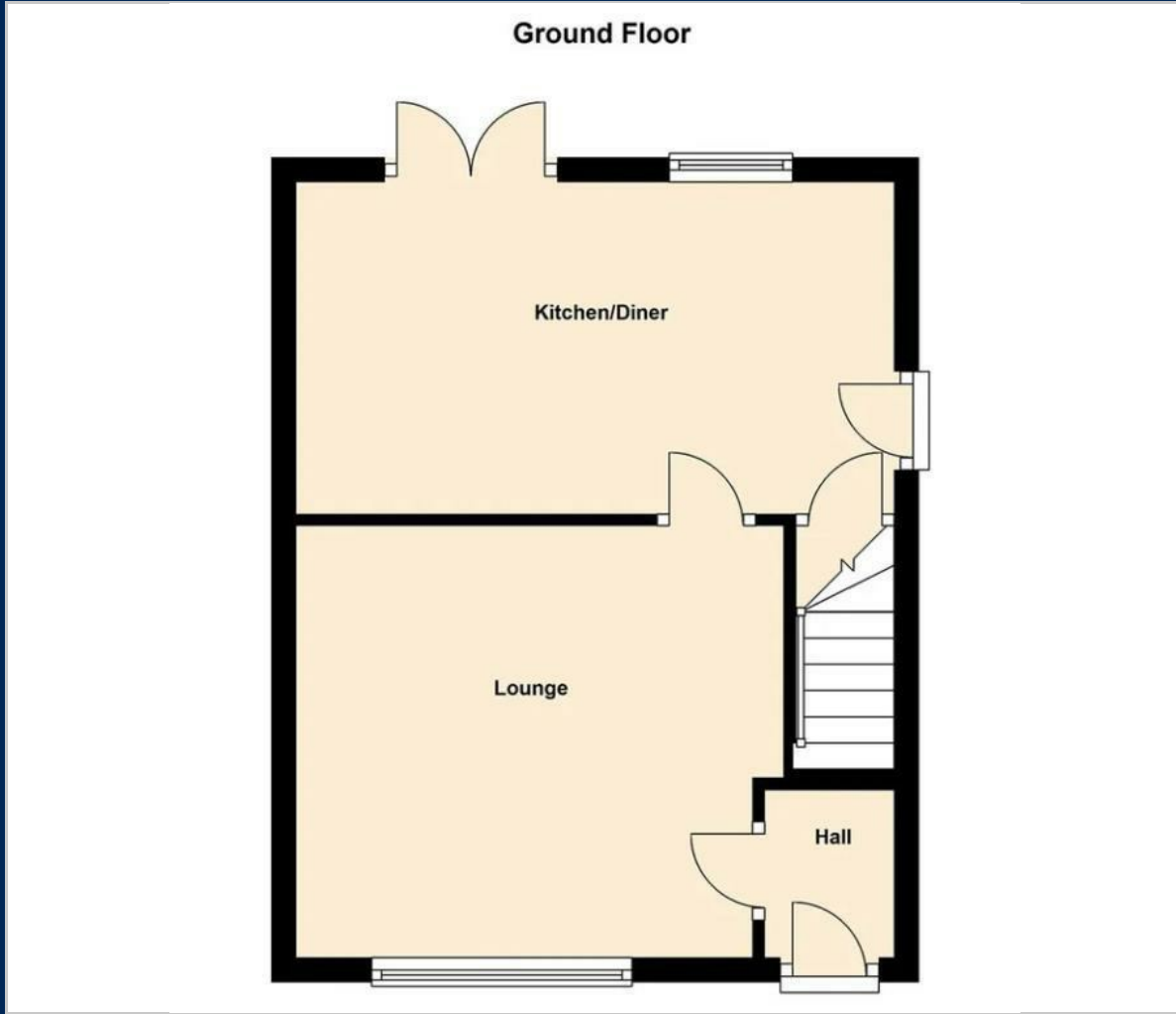

Viewing

Please contact our Priya Properties Office on 0116 255 9950 if you wish to arrange a viewing appointment for this property or require further information.

These particulars, whilst believed to be accurate are set out as a general outline only for guidance and do not constitute any part of an offer or contract. Intending purchasers should not rely on them as statements of representation of fact, but must satisfy themselves by inspection or otherwise as to their accuracy. No person in this firm's employment has the authority to make or give any representation or warranty in respect of the property.

78 Hinckley Road, Leicester, LE3 0RD
Tel: 0116 255 9950 Email: findmeahome@priyaproperties.co.uk www.findmeahome@priyaproperties.co.uk

Area Map

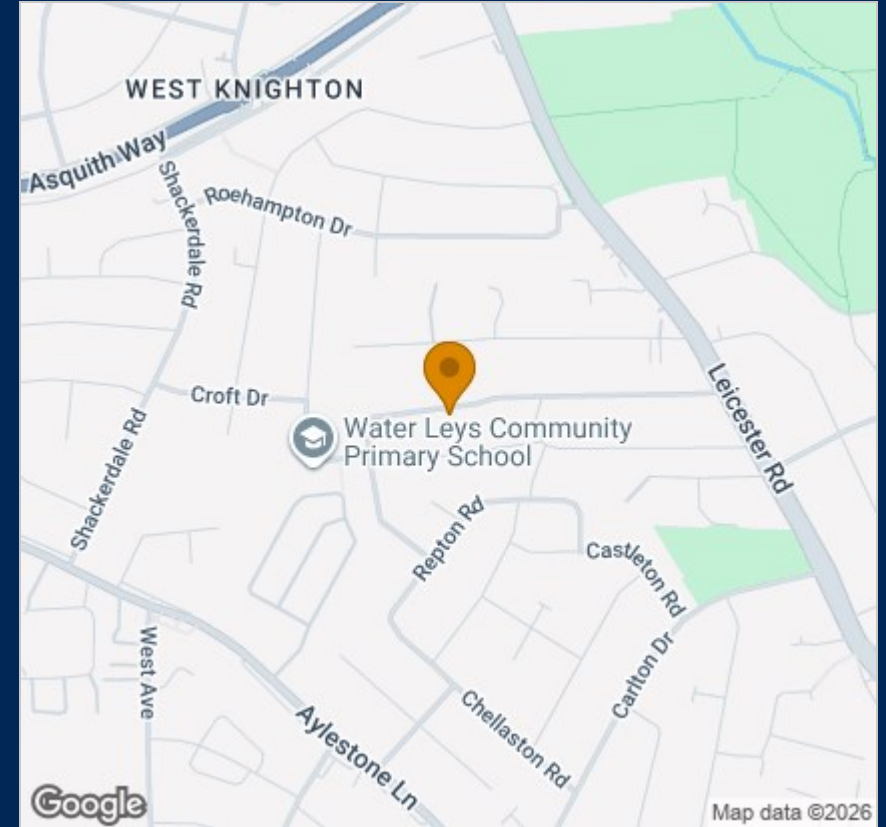

Energy Efficiency Graph

