



WICKHAM ROAD, SE4

£350,000

Ground floor flat
One double bedroom
Communal garden
Share of freehold
Brockley conservation area
Energy rating: d

@marshandparsons
marshandparsons.co.uk

MARSH &
PARSONS



ABOUT THE PROPERTY

A beautifully presented share of freehold apartment, set to the ground floor of a handsome Victorian townhouse, found in the Brockley Conservation Area.

The home commands attractive views to the rear over the well-tended Westerly aspect communal gardens. Ideally located for a choice of stations and the popular award winning Brockley Farmers Market.



STEP INSIDE WICKHAM ROAD

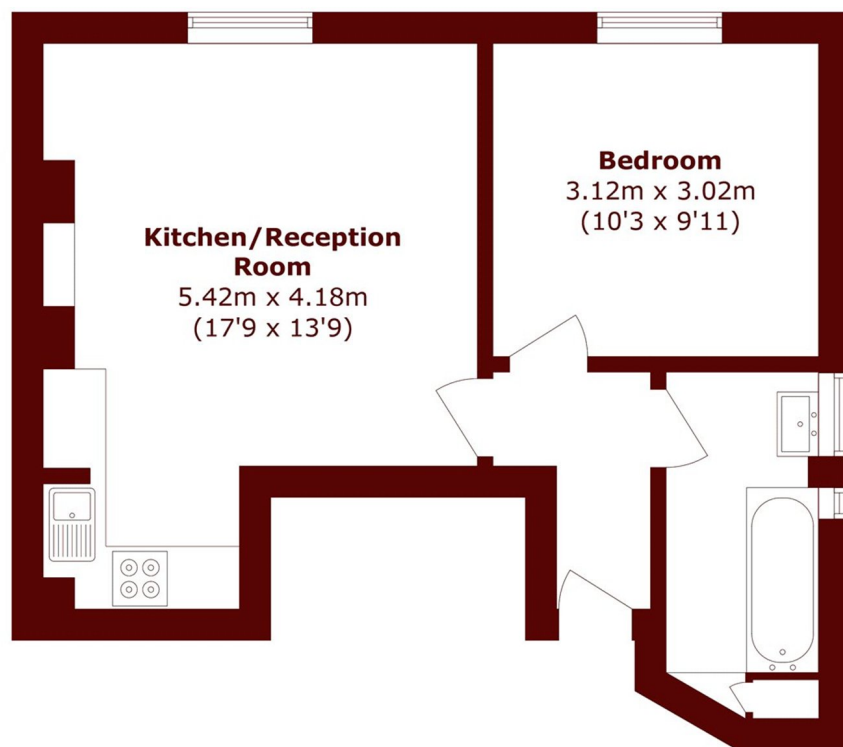

Total area (approx.): 37.4 sq. m (402.5 sq. ft)

Brockley
020 8629 8164

Energy Rating: D We aim to make our particulars both accurate and reliable. However, they are not guaranteed; nor do they form part of an offer or contract. If you require clarification on any points then please contact us, especially if you're traveling some distance to view. Please note that appliances and heating systems have not been tested and therefore no warranties can be given as to their good working order

**MARSH &
PARSONS**