



3 Bedrooms | 1 Bathrooms | 2 Reception Rooms

Purley Vale | Purley | CR8 2DU

£2,000 Per month

LOFT

Purley Vale |
Purley | CR8 2DU
£2,000 Per month

- Three well-proportioned bedrooms, ideal for families
- Spacious and bright living and dining room with ample natural light
- Close to local shops, supermarkets, cafes and everyday amenities
- Peaceful, leafy neighbourhood with a strong family-friendly appeal
- Private rear garden, perfect for outdoor entertaining and family use

This well-presented three-bedroom home offers comfortable and spacious accommodation for families. The property features a large and generously sized living and dining area, enhanced by an abundance of natural light, creating a welcoming space for both relaxing and entertaining. Conveniently located close to local shops, supermarkets, cafes, and a range of everyday amenities, the home provides excellent access to everything you need. Situated in a peaceful and family-friendly neighbourhood, it offers a quiet setting while remaining well connected to local services. To the rear, a private garden provides the perfect outdoor space for family activities and entertaining guests.

- External**
- Hallway**
- Reception room**
11'4 x 10'8 (3.45m x 3.25m)
- Dining room**
13'1 x 10'2 (3.99m x 3.10m)
- Kitchen**
9'9 x 6'7 (2.97m x 2.01m)
- Bathroom**
- Bedroom 1**
12'2 x 11'5 (3.71m x 3.48m)
- Bedroom 2**
14'1 x 11'5 (4.29m x 3.48m)

- Bedroom 3**
8'3 x 6'1 (2.51m x 1.85m)
- Garden**



Purley Vale, CR8

Approximate Gross Internal Area
81.5 sq m / 877 sq ft

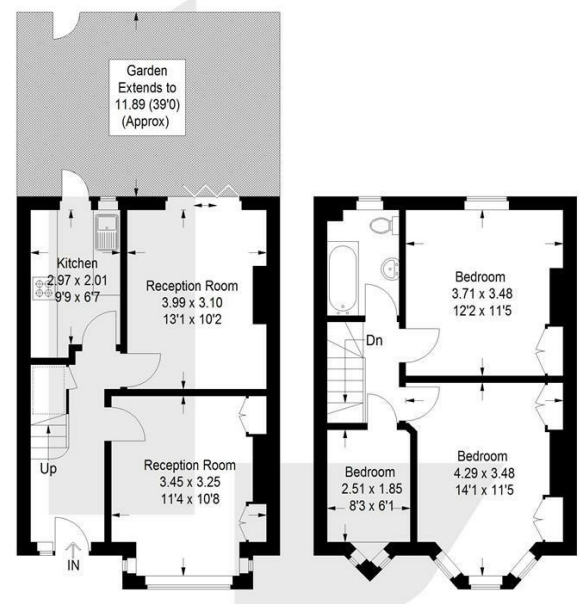

Legend: = Reduced headroom below 1.5 m / 5'0

This plan is for layout guidance only. Not drawn to scale unless stated. Windows and door openings are approximate. Whilst every care is taken in the preparation of this plan, please check all dimensions, shapes and compass bearings before making any decisions reliant upon them. (ID1312583)



EPC Rating:

hello@loft-estates.co.uk
020 8660 8070