

## Brock Street, London NW1

Price £750 per week - Furnished

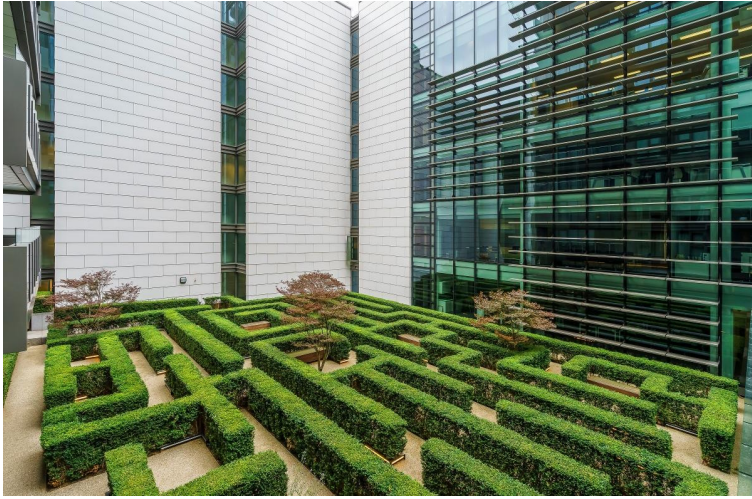





## Description

A stunning seventh floor flat (with lift) in this new development in Brock Street. The property consists of one double bedroom, one bathroom, a large reception room and a fully fitted kitchen. Further benefits include tiled flooring in the reception room, a wonderful terrace and 24 hour concierge service. The building is conveniently located moments from the transport amenities of Warren Street and the open spaces of Regent's Park.

Council tax band: D. Rent is payable on a monthly basis, and you may be required to pay more than a month's rent in advance for tenancies with annual rents exceeding £100,000. You will be required to pay a 1 week holding deposit following a successful offer. Tenancies with annual rents up to £50,000 will require a 5 weeks' security deposit, while those exceeding this threshold will require a 6 weeks' deposit. Utility bills, council tax, telephone line and broadband are not included in the rent. As well as paying the rent, you may also be required to make some additional permitted payments. If your tenancy does not qualify as an APT, additional fees may apply. Please visit [jll.co.uk/fees](http://jll.co.uk/fees) for details of fees that may be payable when renting a property. To check broadband and mobile phone coverage please visit Ofcom here [ofcom.org.uk/phones-telecoms-and-internet/advice-for-consumers/advice/ofcom-checker](http://ofcom.org.uk/phones-telecoms-and-internet/advice-for-consumers/advice/ofcom-checker)

- 1 Double bedroom
- 1 Bathroom
- Reception room
- Fully fitted kitchen
- Terrace
- Seventh floor
- Lift
- 24 Hour concierge
- Approx. 555 sq ft (51 sq m)
- Furnished

# Floorplan

555 sq ft | 52 sq m

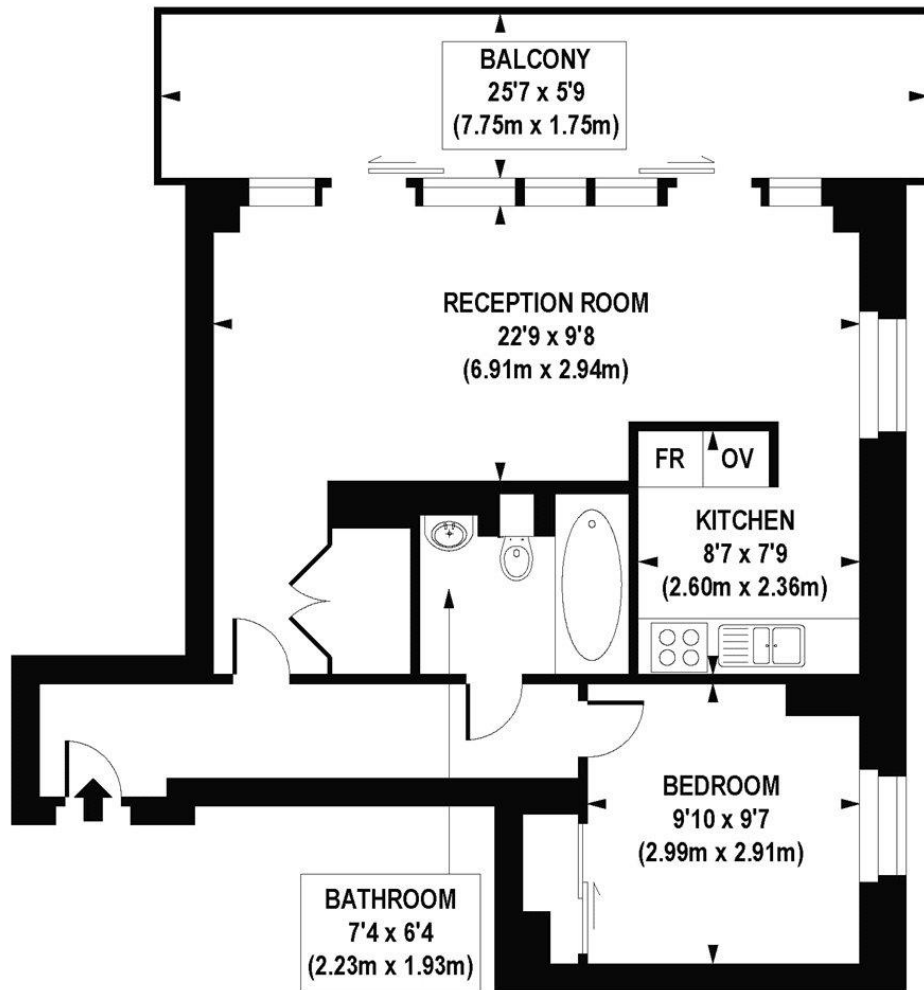

SEVENTH FLOOR

APPROX. GROSS INTERNAL FLOOR AREA 555 sq. ft / 51.59 sq. m

COMPLIANT WITH RICS CODE OF MEASURING PRACTICE Floorplan is for illustrative purposes only and is not to scale. Every attempt has been made to ensure the accuracy of the floorplan shown, however all measurements, fixtures, fittings and data shown are an approximate interpretation for illustrative purposes only. Liability for errors, omissions or mis-statement through negligence or otherwise is hereby excluded.



Mayfair and Marylebone  
St George Street,  
London W1S 2FQ  
+44 207 399 5550  
mayfair@jll.com

*Urban living, your way.*

[jll.co.uk/residential](http://jll.co.uk/residential)

© 2019 Jones Lang LaSalle IP, Inc. All rights reserved. All information contained herein is from sources deemed reliable; however, no representation or warranty is made to the accuracy thereof.

