



Aylesbury Street, Wolverton, Milton Keynes, MK12
Milton Keynes

Guide Price
£260,000

Bedrooms: | Bathrooms: | Receptions:
3 | 1 | 2

Council Tax Band: B

Tenure: Freehold

Property Type: Terraced House

- Being Sold by EXP UK Modern Auction (BUY IT NOW Option Available) – Reservation Fee Applies
- Chain free with no onward chain
- Three bedroom mid terraced home set in the heart of Wolverton
- Flexible accommodation across three floors including useful basement space
- Two reception rooms offering versatile living or work from home potential
- Generous rear garden with rear alleyway access
- Approximate 11 minute walk to Wolverton train station with direct links to London Euston
- Less than a 2 minute walk to local shops, cafés, restaurants, and amenities
- Ideal first time buy in a well connected commuter location
- EG1332



ETHAN GAULTER

exp

EG1332

Located in the heart of Wolverton, Milton Keynes, this chain free three bedroom mid terraced home presents an excellent opportunity for first time buyers looking to get onto the property ladder with a spacious and well located home full of character.

Set across three levels including a useful basement, the property offers flexible and well proportioned accommodation that can easily adapt to different lifestyles. The ground floor features two reception rooms, giving buyers the option of a separate lounge and dining room, a home office, playroom, or additional family space depending on their needs. There is also a fitted kitchen and family bathroom on this level.

The first floor comprises the main bedroom alongside two further bedrooms, making this an ideal home for young families, couples planning ahead, or buyers wanting guest space or a work from home setup. The basement provides valuable additional space, ideal for storage, hobbies, a gym area, or other practical uses.

Outside, the property benefits from a generous rear garden with the added convenience of rear alleyway access, perfect for bikes, bins, gardening access, or simply making day to day life that bit easier.

Location is a major advantage here. Positioned less than a two minute walk from local shops, cafés, and restaurants, everything you need is close by. Wolverton train station is approximately an eleven minute walk away, offering direct rail links into London Euston, making this a fantastic option for commuters wanting affordability without losing connectivity.

For first time buyers, this home offers space that is often hard to find at this price point, a convenient town centre location, and the benefit of no onward chain to help make the moving process smoother.

Property Photo Disclaimer:

Please note that some images have been digitally enhanced and may include virtual staging, edited finishes, or improvements such as changes to furniture layout, flooring, carpets and landscaping to demonstrate how the property could look when fully furnished or presented. These images are for illustration purposes only and do not represent items included in the sale. The owners have assured ourselves as the agent that the floorboards will be repainted in preparation for completion. If you are travelling from a distance, we recommend arranging a virtual viewing or contacting us prior to your journey to ensure everything is arranged for your visit.



Approx Gross Internal Area
104 sq m / 1115 sq ft

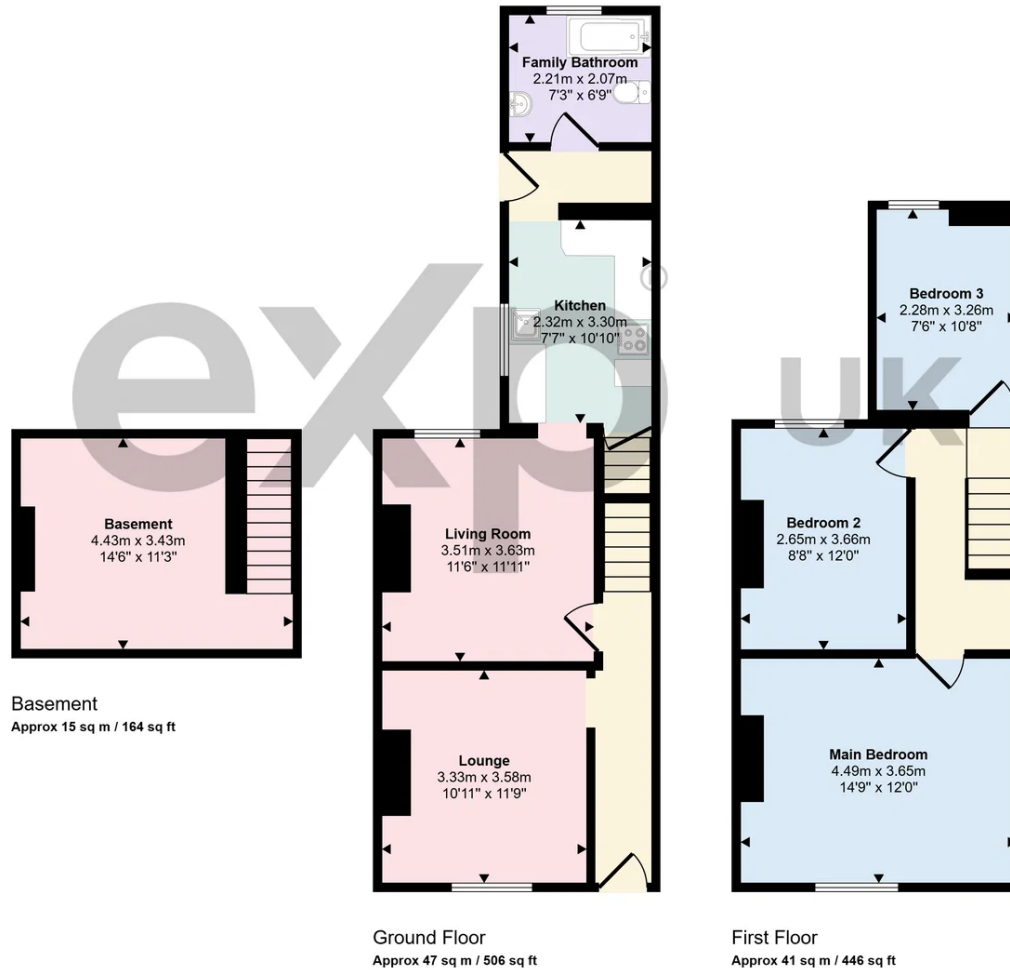

This floorplan is only for illustrative purposes and is not to scale. Measurements of rooms, doors, windows, and any items are approximate and no responsibility is taken for any error, omission or mis-statement. Icons of items such as bathroom suites are representations only and may not look like the real items. Made with Made Snappy 360.



Energy Efficiency Rating		
	Current	Potential
Very energy efficient - lower running costs		
(92 plus) A		
(81-91) B		86
(69-80) C		
(55-68) D	66	
(39-54) E		
(21-38) F		
(1-20) G		
Not energy efficient - higher running costs		
England & Wales	EU Directive 2002/91/EC	

Ethan Gaulter
Local Estate Agent
01908 464 950
Ethan.Gaulter@exp.uk.com
<https://ethangaulter.exp.uk.com>

ETHAN GAULTER

