

GROUND FLOOR
499 sq.ft. (46.3 sq.m.) approx.

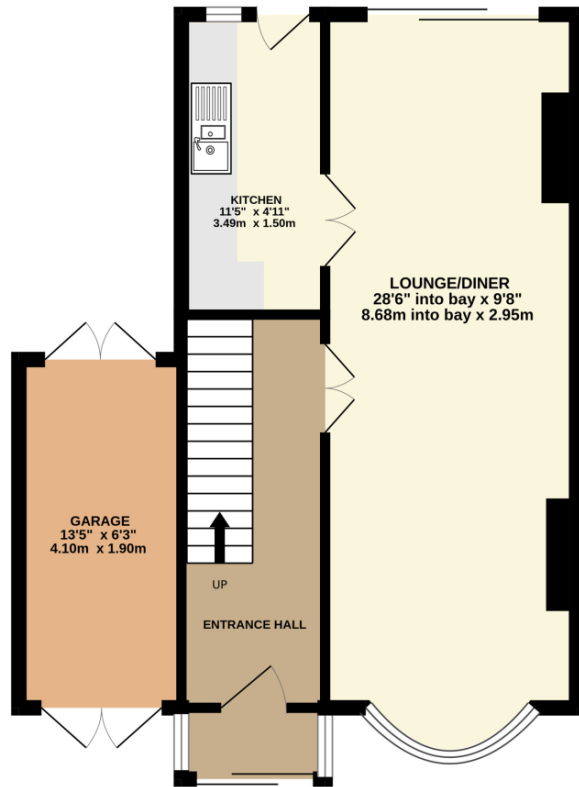

1ST FLOOR
402 sq.ft. (37.3 sq.m.) approx.

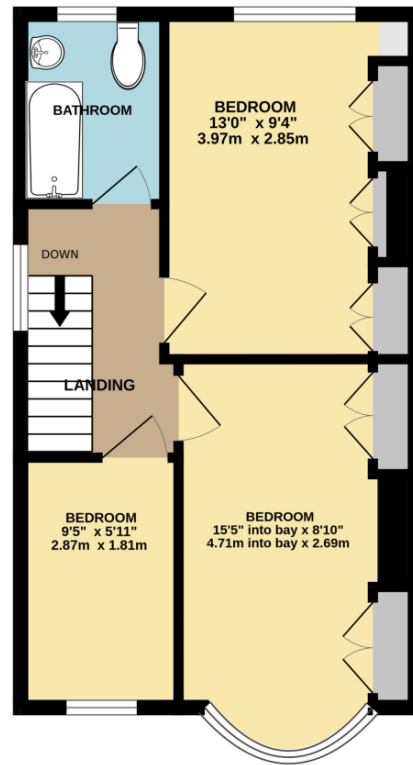

TOTAL FLOOR AREA: 901 sq.ft. (83.7 sq.m.) approx.

Whilst every attempt has been made to ensure the accuracy of the floorplan contained here, measurements of doors, windows, rooms and any other items are approximate and no responsibility is taken for any error, omission or mis-statement. This plan is for illustrative purposes only and should be used as such by any prospective purchaser. The services, systems and appliances shown have not been tested and no guarantee as to their operability or efficiency can be given.
Made with Metropix ©2025

Energy Efficiency Rating		Current	Potential
Very energy efficient - lower running costs			
(92+)	A		
(81-91)	B		
(69-80)	C		80
(55-68)	D	57	
(39-54)	E		
(21-38)	F		
(1-20)	G		
Not energy efficient - higher running costs			
England, Scotland & Wales		EU Directive 2002/91/EC	

Address: Montrose Avenue, Welling, DA16

NO PHOTO



Montrose Avenue, Welling, DA16

Anthony James Estate Agents are pleased to offer to the market this spacious well presented three bedroom end of terrace house in Welling. The property is situated on a quiet and sought after residential road in Welling. Its location is ideal for the local shops, Welling High Street, Welling and Falconwood Train Stations, schools, bus routes and parks.

Asking Price £450,000



AJR Property
2 Bellegrove Road, Welling DA16 3PR
T: +442083040666 | E: hello@ajrproperty.com
<http://www.ajrproperty.com/>

AJR Property
2 Bellegrove Road, Welling DA16 3PR
T: +442083040666 E: hello@ajrproperty.com
<http://www.ajrproperty.com/>



Features

- Three bedroom end of terrace house
- Three good size bedrooms
- Property has the potential to extend subject to planning permission.
- Close to Welling train station
- Close to local school including Bexley Grammar
- Large through lounge
- Garage
- Double glazing and gas central heating
- Close to Welling town centre
- EPC D