



## Eden Grove, NW10

£375,000



- Two-bedroom apartment
- Off-street parking
- Gated, private development
- Communal gardens
- Great location
- First floor flat

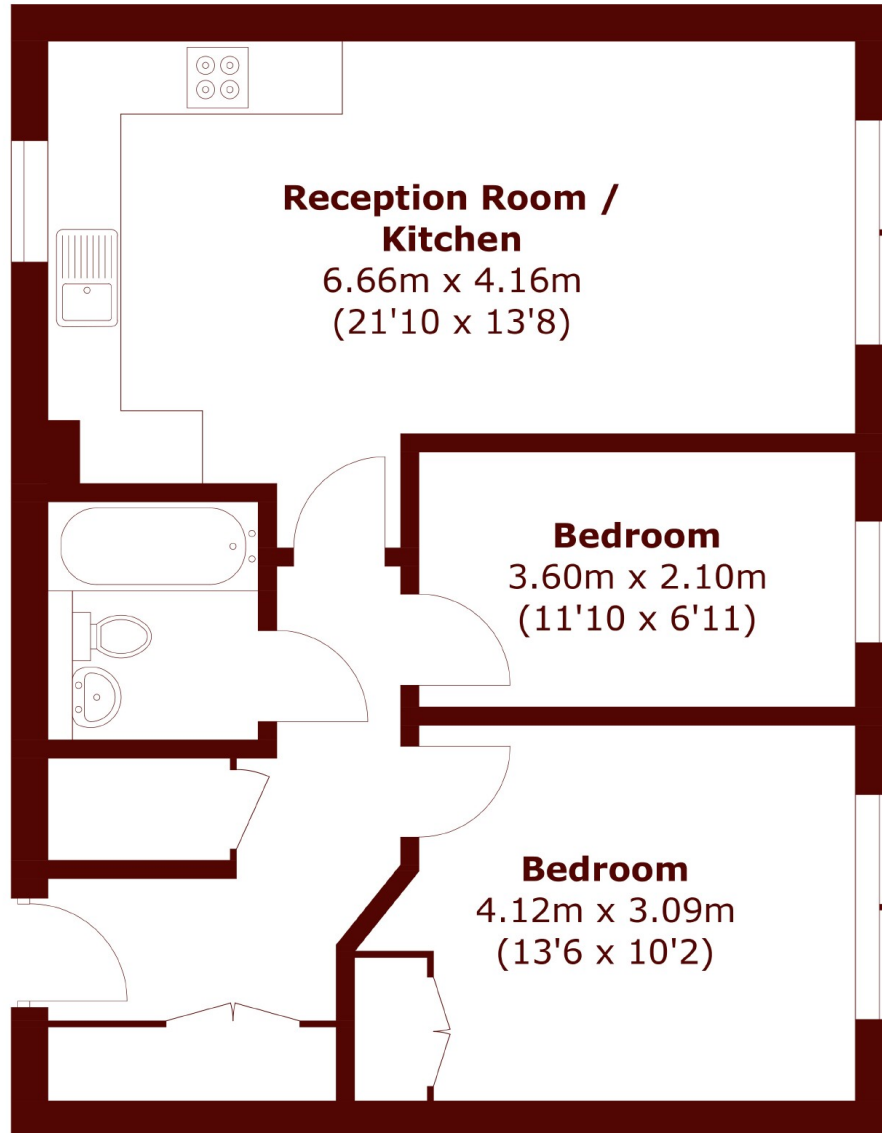

Total area (approx.): 58.0 sq. m (624.3 sq. ft)

**Marsh & Parsons Willesden Green**

291-293 Willesden Lane,  
London, NW2 5HY  
020 8451 0420