



402 Westmark Tower 1 Newcastle Place, London, W2 1DB

£715 Per week



A beautifully presented one-bedroom apartment located on the second floor of Westmark Tower, part of the prestigious West End Gate development in Paddington.

The property offers a spacious double bedroom, a sleek and contemporary bathroom, and a bright open-plan kitchen and living area that leads onto a private balcony—perfect for relaxing or entertaining.

Residents benefit from an exceptional range of amenities, including a 24-hour concierge, lift access, state-of-the-art gym, swimming pool, private cinema, meeting room, residents' lounge, and an elegant private dining room available for hire.

Developed by St Edward, West End Gate is finished to an outstanding standard throughout. The property is ideally positioned within easy walking distance of Paddington Station, providing excellent transport links across London and beyond.

Minimum contract: 12 months
Change of contract fee: £50 including VAT
Council Tax: Westminster- E
Lift access | Cladding: EWS1 Certificate
Ask Agent
Holding Deposit - £715 (1 weeks rent, subject to offer agreed)

Electricity supply – Mains | Cold Water supply – Mains | Sewerage – Mains | Hot water & heating – Mains | Internet: Fibre
To check broadband and mobile phone coverage please visit Ofcom.

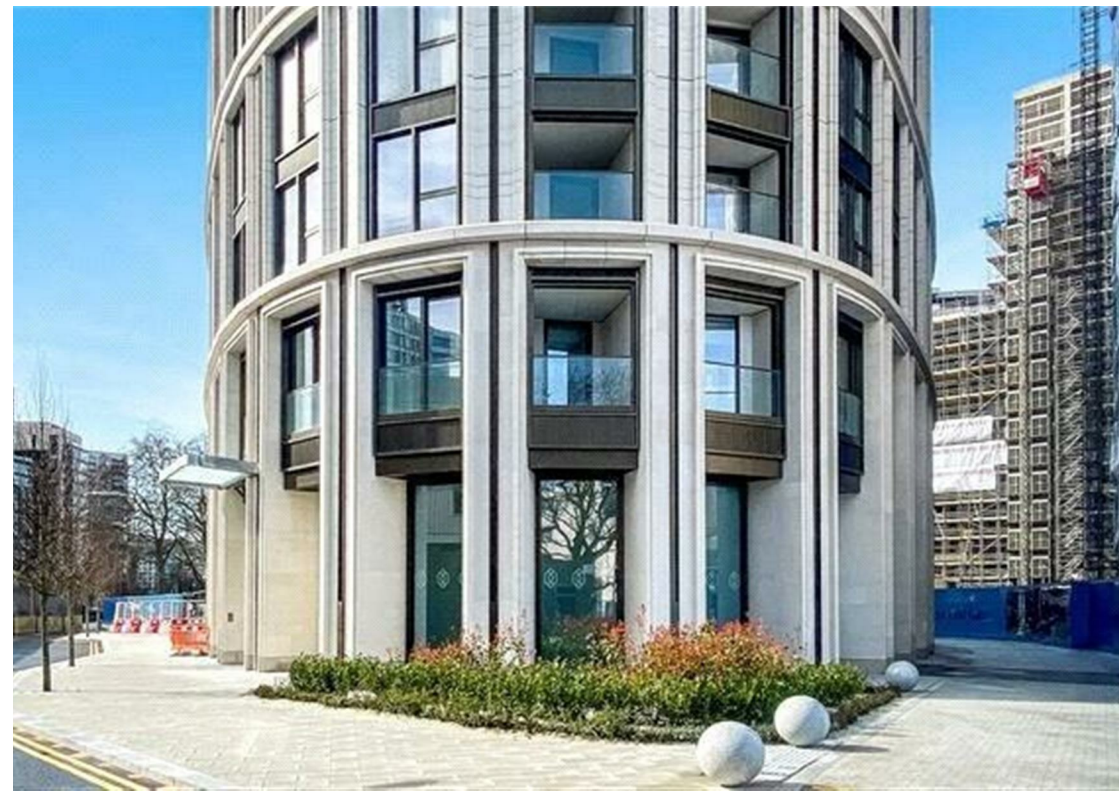



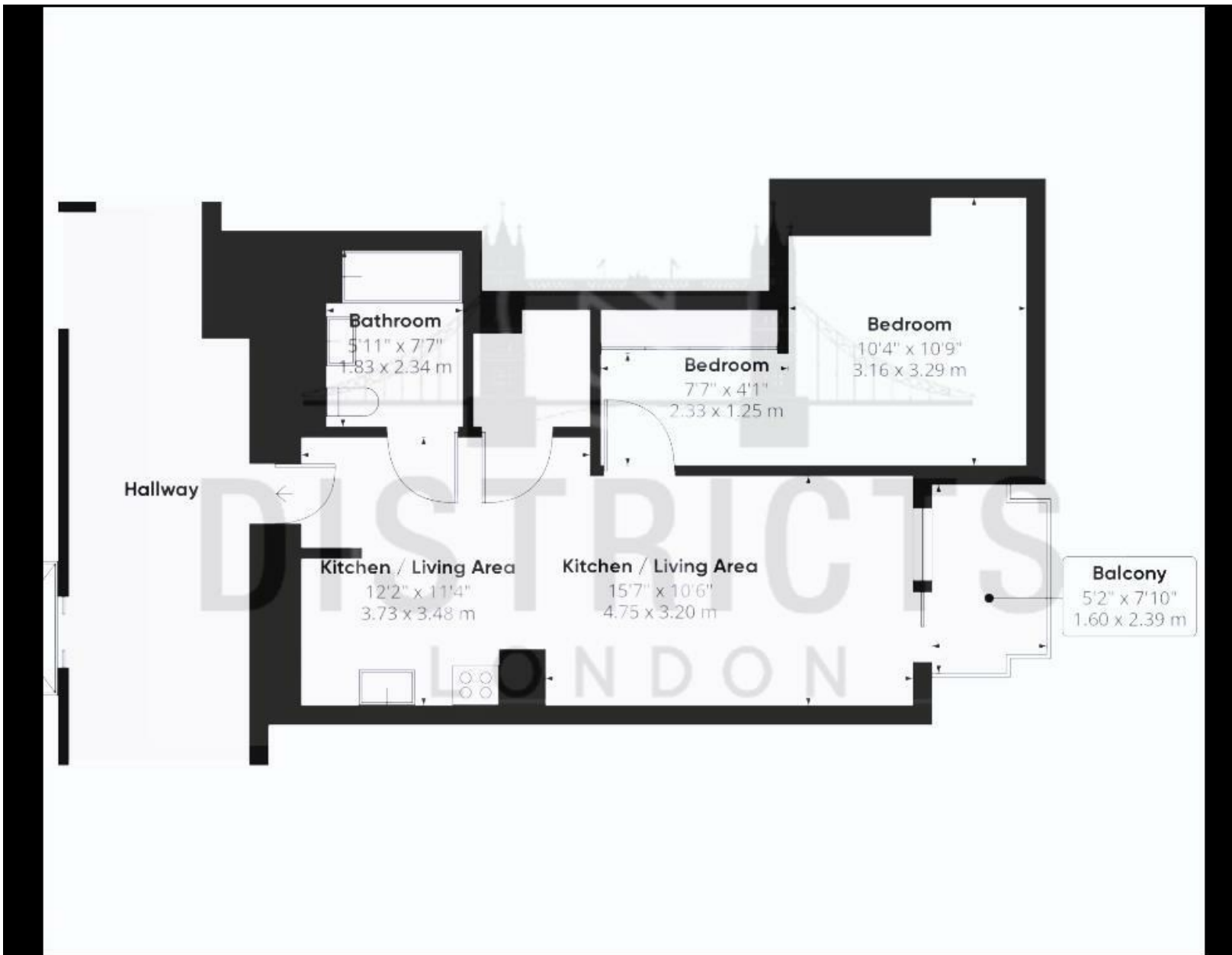

Energy Efficiency Rating		
	Current	Potential
Very energy efficient - lower running costs		
(92 plus) A		
(81-91) B	86	86
(69-80) C		
(55-68) D		
(39-54) E		
(21-38) F		
(1-20) G		
Not energy efficient - higher running costs		
England & Wales	EU Directive 2002/91/EC 	

These particulars, whilst believed to be accurate are set out as a general outline only for guidance and do not constitute any part of an offer or contract. Intending purchasers should not rely on them as statements of representation of fact, but must satisfy themselves by inspection or otherwise as to their accuracy. No person in this firm's employment has the authority to make or give any representation or warranty in respect of the property.