



Royal Court, Birmingham Road, Sutton Coldfield, B72 1LY

£75,000

1 1 1



This appealing one-bedroom over 60's retirement apartment, situated within the esteemed Royal Court development on Birmingham Road, offers comfortable and secure living for those seeking an independent lifestyle in Sutton Coldfield.

Nestled in a convenient Sutton Coldfield location, Royal Court provides residents with easy access to local amenities, including shops, eateries, and public transport links. The development is well-serviced and offers a peaceful environment, perfect for enjoying a relaxed pace of life while remaining connected to the vibrant local community.

The apartment features a welcoming entrance hall, a bright open-plan living/dining room leading to a well-appointed kitchen, a spacious master bedroom, and a modern shower room. Residents also benefit from a range of excellent communal facilities, including landscaped gardens and parking.

Early viewing is recommended to appreciate the quality and convenience this property offers.



ANDREW
**DOWNING
BOOTH**
ESTATE AGENTS



ANDREW
**DOWNING
BOOTH**
ESTATE AGENTS

Approx Gross Internal Area
43 sq m / 461 sq ft

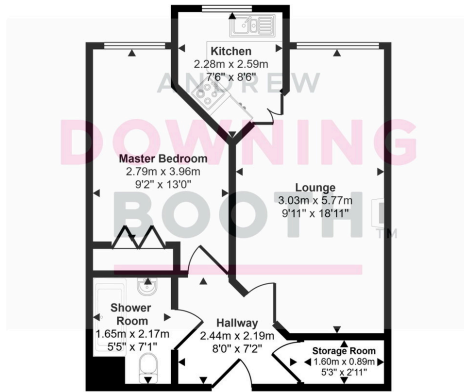

Floorplan

This floorplan is only for illustrative purposes and is not to scale. Measurements of rooms, doors, windows, and any items are approximate and no responsibility is taken for any error, omission or mis-statement. Icons of items such as bathroom suites are representations only and may not look like the real items. Made with Made Snappy 360.

- Retirement Property For Over 60's
- Communal Lounge, Guest Bedroom & Laundry
- Master Bedroom With Built-In Wardrobes
- EPC Rating: D
- One Bedroom Flat
- On Site Management & 24hr Intercom System
- Communal Landscaped Gardens
- Council Tax Band: C

