



RAVENSBURY TERRACE, SW18

£500,000

- Open plan kitchen/living
- One double bedroom
- Built in storage
- Private balcony
- Central Earlsfield location
- Energy rating: B





ABOUT THE HOME

A beautifully presented, one double bedroom apartment located in a sought after development in Central Earlsfield.

This property offers a bright and spacious open plan kitchen/living room, with floor to ceiling sliding doors leading out onto the large private balcony as well as letting in floods of natural light. There is a generous double bedroom with built in storage and further access to the balcony. The property features a modern bathroom as well as ample built in storage throughout. The property is being offered to the market with no onward chain.

Ravensbury Terrace is ideally located just a short distance from Earlsfield train station, offering excellent transport links into the city. It is also just moments from the green open spaces of King George's Park as well as the many cafe's, shops, bars and restaurants of Garratt Lane.





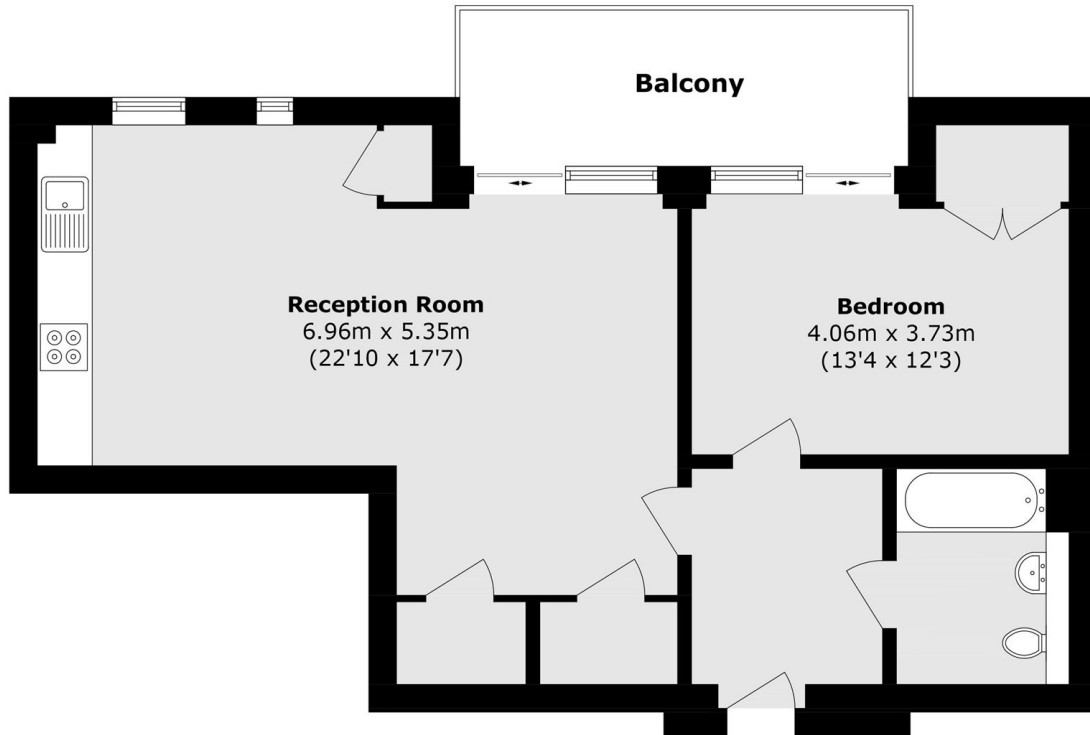

Total area (approx.): 55.5 sq. m (597.4 sq. ft)
Balcony area (approx.): 8.0 sq m (86.1 sq. ft)

JACKSONS EARLSFIELD

372-374 Garratt Lane,
Earlsfield, London, SW18 4ES
Sales: 020 8971 7979
Lettings: 020 8971 7070

Energy Rating: B We aim to make our particulars both accurate and reliable. However they are not guaranteed; nor do they form part of an offer or contract. If you require clarification on any points then please contact us, especially if you're traveling some distance to view. Please note that appliances and heating systems have not been tested and therefore no warranties can be given as to their good working order.