

RUSH
WITT &
WILSON



RUSH
WITT &

7 Mercatoria, Hastings, TN38 0EB
£695,000 Freehold

A stunning, recently restored double-fronted Victorian townhouse, beautifully positioned within the heart of central St Leonards, just moments from the beach, independent cafés, local parks and vibrant artisan amenities. This exceptional home has been sympathetically renovated to an outstanding standard, effortlessly blending period charm with stylish contemporary living. The property showcases exquisite décor throughout, with carefully retained original features and high-quality finishes that create a truly impressive home. You are immediately welcomed by striking parquet flooring that flows beautifully through the entrance and into the elegant living spaces. The ground floor offers a wonderfully sociable layout featuring a characterful reception room with feature fireplace, well-appointed kitchen area and a convenient cloakroom. To the rear, a sunroom seamlessly transitions into a conservatory, flooding the space with natural light and providing access to the charming courtyard garden an ideal setting for relaxing or entertaining. The lower ground floor presents a versatile and highly attractive space, arranged as a combined utility and additional living area. The first floor continues to impress with three beautifully presented bedrooms, all benefitting from original floorboards that enhance the property's Victorian heritage. The luxurious hotel-style family bathroom features a high specification suite with separate shower, whilst one of the bedrooms also enjoys the added benefit of its own stylish en-suite shower room. Occupying the entire second floor, the principal bedroom provides a truly spectacular retreat. This generous space enjoys far-reaching views and features a bespoke vanity sink area complete with integrated wine cooler. French doors open directly onto a delightful private rooftop garden, offering a unique and tranquil outdoor sanctuary with elevated views across St Leonards.







RUSH
WITT &
WILSON



RUSH
WITT &
WILSON



RUSH
WITT &
WILSON



RUSH
WITT &
WILSON



Floor -1



Floor 0



Floor 1

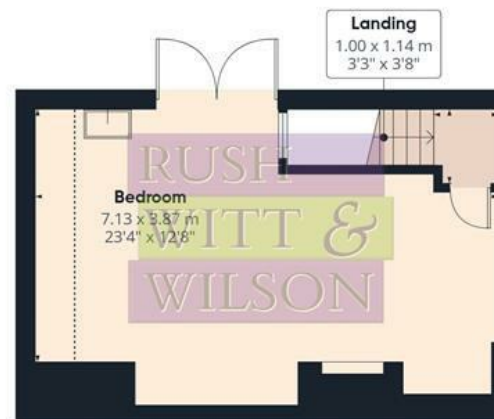

Floor 3

RUSH
WITT &
WILSON

Approximate total area⁽¹⁾

196.4 m²

2114 ft²

Reduced headroom

4 m²

43 ft²

(1) Excluding balconies and terraces

Reduced headroom

Below 1.5 m/5 ft

Calculations reference the RICS IPMS 3C standard. Measurements are approximate and not to scale. This floor plan is intended for illustration only.

GIRAFFE360

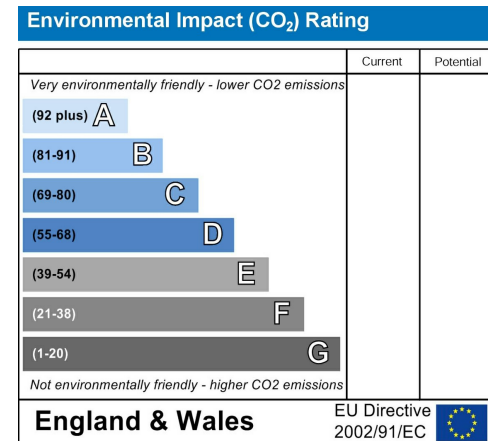
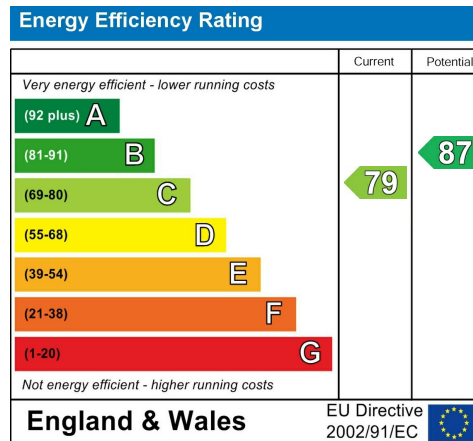
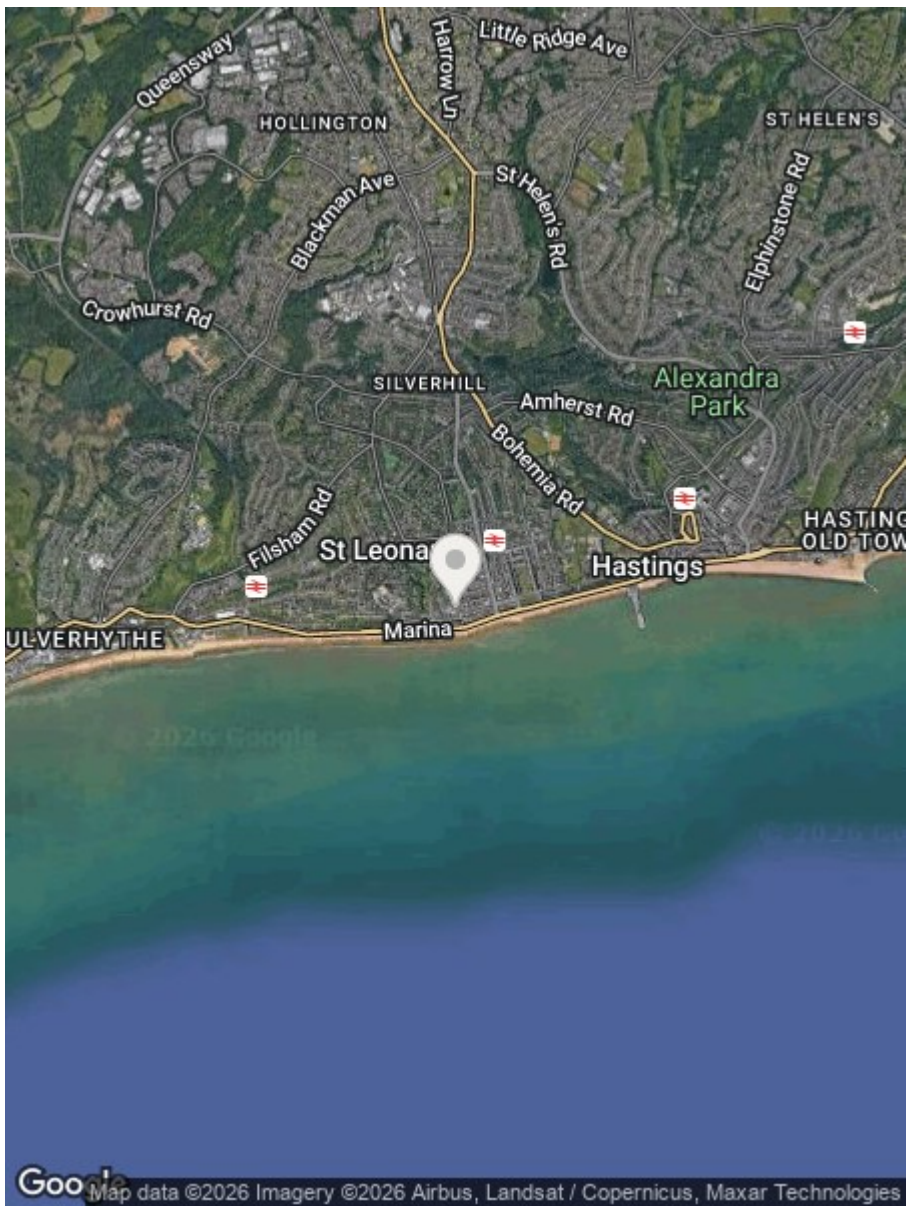

Council Tax Band - B

Fixtures and fittings: A list of the fitted carpets, curtains, light fittings and other items fixed to the property which are included in the sale (or may be available by separate negotiation) will be provided by the Seller's Solicitors.

Important Notice:

1. Particulars: These particulars are not an offer or contract, nor part of one. You should not rely on statements by Rush, Witt & Wilson in the particulars or by word of mouth or in writing ("information") as being factually accurate about the property, its condition or its value. Neither Rush, Witt & Wilson nor any joint agent has any authority to make any representations about the property, and accordingly any information given is entirely without responsibility on the part of the agents, seller(s) or lessor(s).
2. Photos, Videos etc: The photographs, property videos and virtual viewings etc. show only certain parts of the property as they appeared at the time they were taken. Areas, measurements and distances given are approximate only.
3. Regulations etc: Any reference to alterations to, or use of, any part of the property does not mean that any necessary planning, building regulations or other consent has been obtained. A buyer or lessee must find out by inspection or in other ways that these matters have been properly dealt with and that all information is correct.
4. VAT: The VAT position relating to the property may change without notice.
5. To find out how we process Personal Data, please refer to our Group Privacy Statement and other notices at <https://rushwittwilson.co.uk/privacy-policy>

**RUSH
WITT &
WILSON**

**Residential Estate Agents
Lettings & Property Management**



**Rother House Havelock Road
Hastings
East Sussex
TN34 1BP
Tel: 01424 442443
hastings@rushwittwilson.co.uk
www.rushwittwilson.co.uk**