



## Bailey Crescent, guide price £340,000- £350,000

- Guide Price £340,000 to £350,000
- Two Reception Rooms and Separate Dining Room
- Enclosed Rear Garden and Multicar Driveway
- Excellent Transport Links with Immediate Access to M4
- Family Bathroom, En-Suite to Master and Downstairs Wc
- Converted Garage Serving as a Reception Room/Fourth Bedroom
- EPC Rating: C



 3  2  1

**Pinkmove**

01633 746088  
team@pinkmove.co.uk



## About the property

This well-presented three/four-bedroom detached home on Bailey Crescent offers flexible living spaces, modern convenience and an excellent position within a highly sought-after area of Newport. Less than a minute's walk from similar homes of the same design, the property has been carefully maintained and adapted to suit a range of family lifestyles.

The ground floor features a bright, front-facing kitchen, a centrally located WC, and two generous reception rooms to the rear. The main lounge enjoys French doors opening onto the enclosed garden, creating a light and inviting family space. To the right, a separate dining room provides the perfect setting for everyday meals or entertaining. The former garage has been converted into a versatile third reception room or spacious fourth bedroom, ideal for homeworking, guests or a playroom. Durable tiled flooring runs throughout the ground floor, ensuring low-maintenance practicality.

Upstairs, three well-proportioned bedrooms are complemented by a modern family bathroom with an en-suite serving the master bedroom. Outside, the rear garden offers an enclosed space, ideal for relaxing or hosting. To the front, a multi-car driveway.

## Accommodation

### Kitchen

10' 3" x 8' 6" ( 3.12m x 2.59m )

### Downstairs Wc

3' 7" x 8' 6" ( 1.09m x 2.59m )

### Lounge

14' 1" x 12' 5" ( 4.29m x 3.78m )

### Dining Room

9' 8" x 10' ( 2.95m x 3.05m )

### Reception Room/Bedroom 4



Max Measurements

### Bedroom 2

8' 11" x 10' 6" ( 2.72m x 3.20m )

### Bedroom 3

9' 11" x 10' ( 3.02m x 3.05m )

Max Measurements

### Bathroom

6' 10" x 11' ( 2.08m x 3.35m )

16' 1" x 9' 1" ( 4.90m x 2.77m )

### Bedroom 1

12' 3" x 8' 10" ( 3.73m x 2.69m )

### En-Suite

6' 10" x 4' 11" ( 2.08m x 1.50m )

01633 746088

team@pinkmove.co.uk

**Pinkmove**

## Floorplan

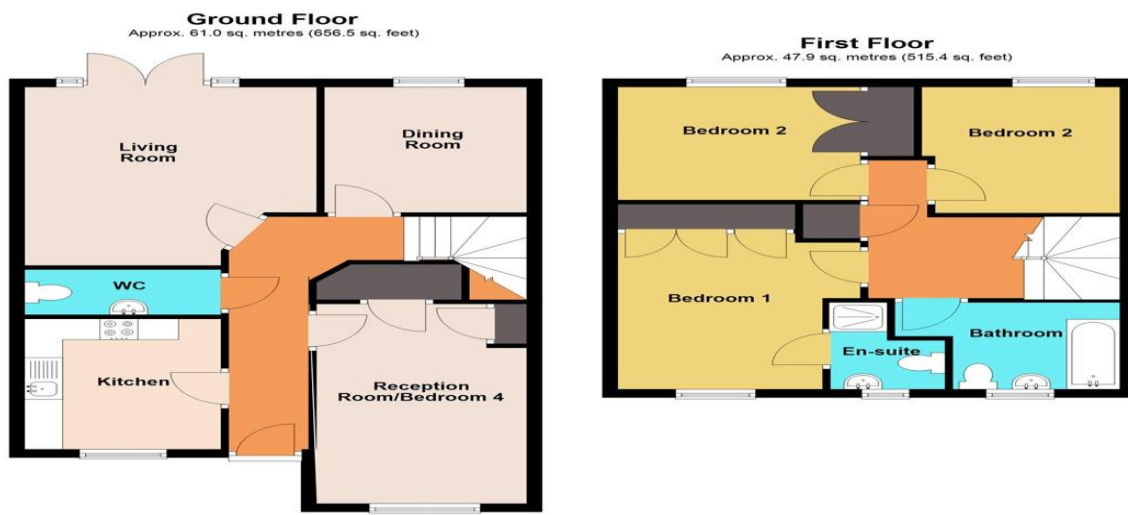

Total area: approx. 108.9 sq. metres (1171.9 sq. feet)  
**3 Bailey Crescent**

## Important Information

Note while we endeavour to make our sales details accurate and reliable, if there is any point which is of particular interest to you, please contact the office and we will be pleased to confirm the position for you. We have not personally tested any apparatus, equipment, fixtures, fittings or services and cannot verify they are in working order or fit for their purposes. Nothing in these particulars is intended to indicate that carpets or curtains, furnishings or fittings, electrical goods (whether wired or not). Gas fires or light fittings or any other fixtures not expressly included form part of the property offered for sale. This computer generated Floorplan, if applicable, is intended as a general guide to the layout and design of the property. It is not to scale and should not be relied upon for dimensions. Tenure: We cannot confirm the tenure of the property as we have not had access to the legal documents. The buyer is advised to obtain verification from their solicitor or surveyor.

Peter Alan Limited is registered in England and Wales under company number 2073153, Registered Office is Cumbria House, 16-20 Hockliffe Street, Leighton Buzzard, Bedfordshire, LU7 1GN. VAT Registration Number is 500 2481 05. For activities relating to regulated mortgages and non-investment insurance contracts, Peter Alan Limited is an appointed representative of Connells Limited which is authorised and regulated by the Financial Conduct Authority. Connells Limited's Financial Services Register number is 302221. Most buy-to-let

