

Maple Road

Harpenden, AL5 2DU

Handsome six bedroom, detached home of circa 3,450 sq ft in prime central location, The Avenues. Arranged over three floors, with generous reception rooms, study, private driveway and double garage. Built by highly renowned local developers, Plowright Homes.

Guide price £3,000,000

Maple Road

Harpenden, AL5 2DU



- Detached Home
- Six Bedrooms
- Three reception rooms
- Circa 3,457 sq ft
- Private driveway
- Built by Plowright Homes
- Arranged over three floors
- Double Garage
- Council Tax Band H

Porch

Reception Hall

Kitchen/Breakfast Room

17'9" x 13'1" (5.43 x 4.00)

Utility Room

13'1" x 6'3" (4.00 x 1.92)

Cloakroom

Dining Room

14'9" x 11'11" (4.52 x 3.64)

Living Room

21'2" x 15'1" (6.47 x 4.60)

Study

15'2" x 11'0" (4.63 x 3.37)

Double Garage

17'1" x 16'9" (5.23 x 5.11)

Landing

Bedroom One

16'7" x 15'1" (5.07 x 4.60)

En-suite bathroom

Dressing Room

11'6" x 10'0" (3.51 x 3.06)

Bedroom Two

17'1" x 12'2" (5.23 x 3.71)

En-suite shower room

Bedroom Three

17'2" x 10'0" (5.25 x 3.05)

En-suite bathroom

Bedroom Four

11'1" x 10'6" (3.39 x 3.22)

Bedroom Five

14'7" x 8'9" (4.47 x 2.67)

WC

Bedroom Six/Games Room

19'1" x 14'7" (5.84 x 4.47)





Floor Plan

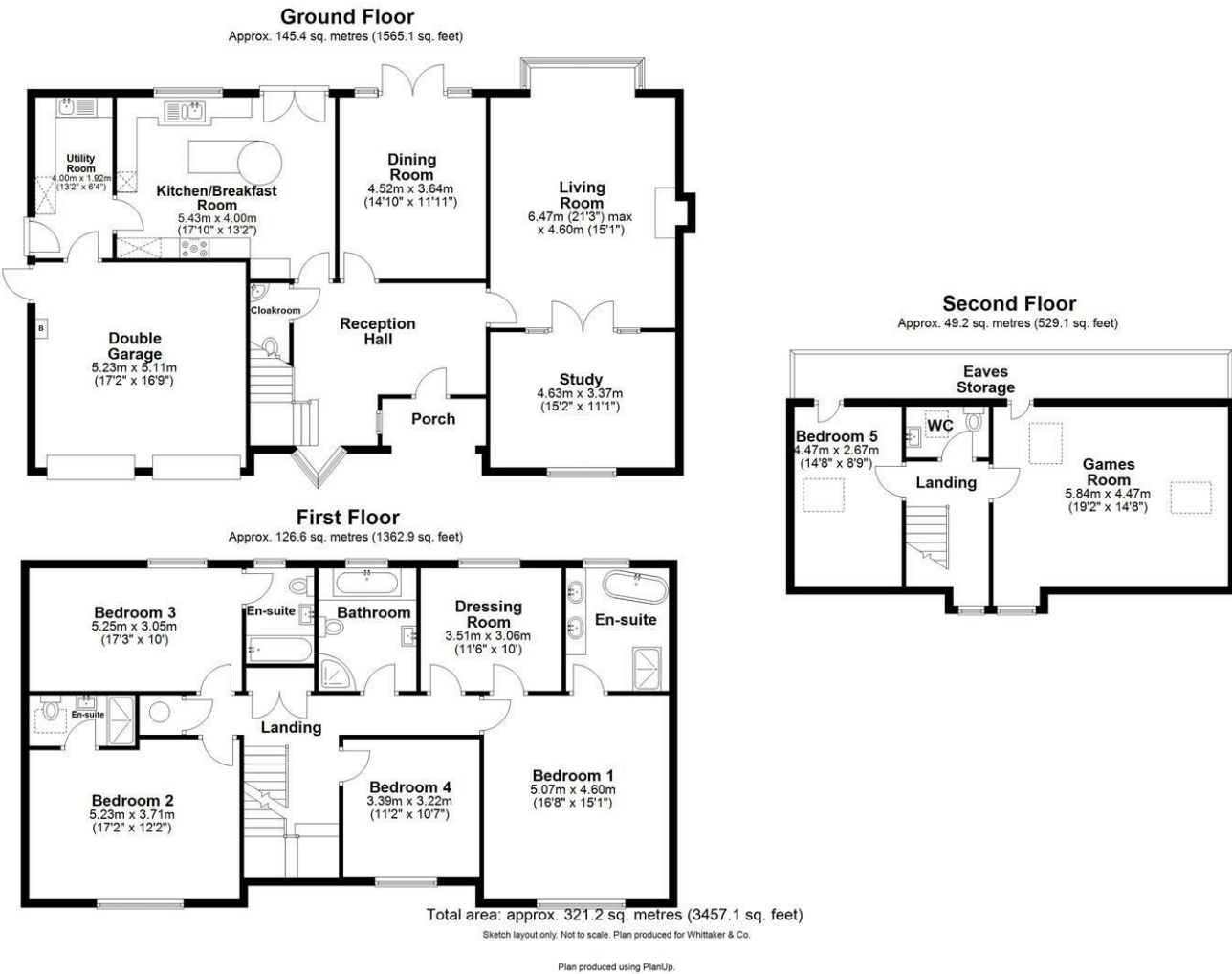

These particulars, whilst believed to be accurate are set out as a general outline only for guidance and do not constitute any part of an offer or contract. Intending purchasers should not rely on them as statements of representation of fact, but must satisfy themselves by inspection or otherwise as to their accuracy. No person in this firms employment has the authority to make or give any representation or warranty in respect of the property.

