

HJC

ESTATE AGENCY

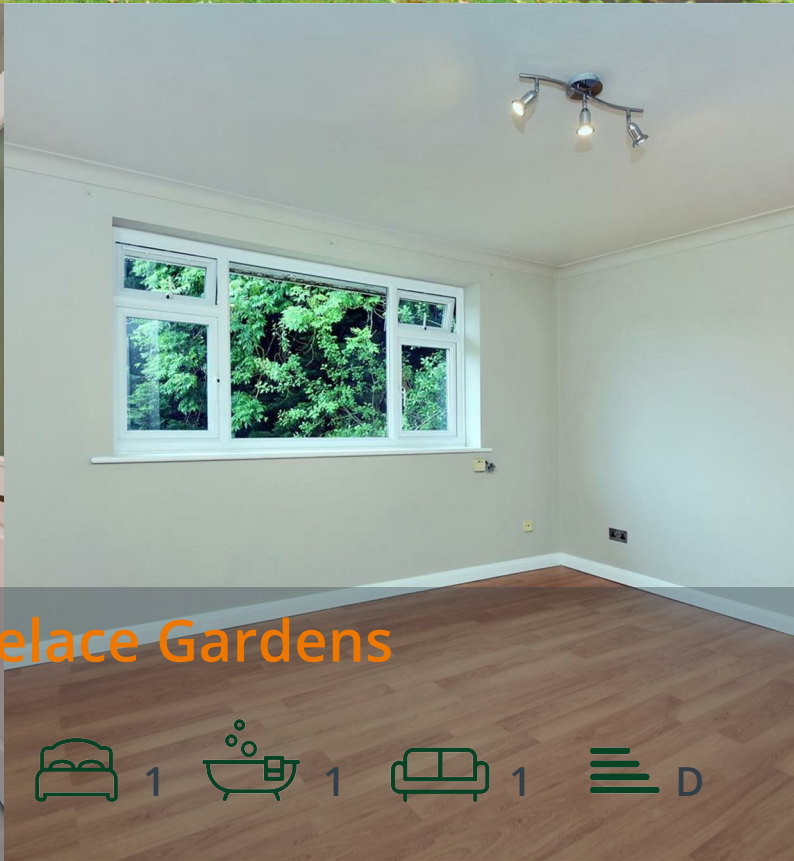

42 Palmerston Court, Lovelace Gardens

Surbiton, KT6 6SE

£1,475 Per Calendar Month



Floor Plan

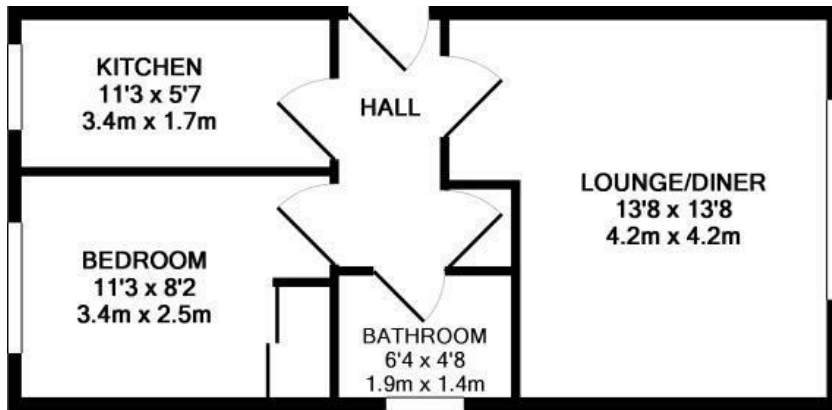

TOTAL APPROX. FLOOR AREA 393 SQ.FT. (36.5 SQ.M.)

Whilst every attempt has been made to ensure the accuracy of the floor plan contained here, measurements of doors, windows, rooms and any other items are approximate and no responsibility is taken for any error, omission, or mis-statement. This plan is for illustrative purposes only and should be used as such by any prospective purchaser. The services, systems and appliances shown have not been tested and no guarantee as to their operability or efficiency can be given

Made with Metropix ©2015

Area Map



Energy Efficiency Graph

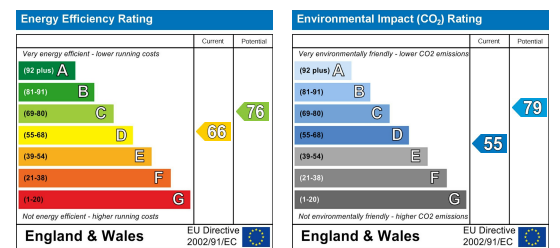

Viewing

Please contact our HJC Surbiton Office on 020 8390 0404 if you wish to arrange a viewing appointment for this property or require further information.

- New kitchen
- Freshly decorated
- Double bedroom with built in wardrobes
- New bathroom
- Garage
- Council tax band C



A newly decorated top floor apartment, enjoying a convenient location on a tree lined road close to the town centre and station. The accommodation includes a bright lounge/dining room, double bedroom with fitted wardrobes, a newly fitted modern kitchen and a smart, newly refurbished bathroom suite. The property also benefits from a garage and communal garden. Available now!



These particulars, whilst believed to be accurate are set out as a general outline only for guidance and do not constitute any part of an offer or contract. Intending purchasers should not rely on them as statements of representation of fact, but must satisfy themselves by inspection or otherwise as to their accuracy. No person in this firm's employment has the authority to make or give any representation or warranty in respect of the property.