



The Bungalow, Skivier's Lane, Durley, SO32 £900,000
Detached Extended Bungalow, Set on 0.87 Acre

CONTACT

- 📞 02382 519295
- ✉ Claire@veestates.co.uk
- 🌐 www.veestates.co.uk



**3 Double Bedroom Extended Bungalow | Skivier's Lane
Driveway, Garage and Outbuilding | Set on 0.78 Acre | Extension Potential (STP)**



INTRODUCTION

Asking Price £900,000



VC Estates are excited to offer to this extended detached bungalow offered chain free and marketed for the first time, having been kept in the same family occupation since being built in the late 1940s. Set within the ever-popular village of Durley, this extended detached bungalow sits proudly on an impressive plot of approximately 0.78 acres — offering space, privacy, and a lifestyle that's hard to match.

KEY FEATURES

AGENT ID: 9295

- Chain Free
- Sought after Durley Village Location
- Set on 0.78 Acre
- Extended Detached Bungalow
- Driveway, Garage and Outbuilding
- Extension Potential STP
- EPC Ordered



AREA INFORMATION: Skivier's Lane Durley

Skiviers Lane is a charming semi-rural setting in the sought-after village of Durley, offering a peaceful lifestyle while remaining well-connected. Surrounded by beautiful countryside, this location is ideal for those who appreciate scenic walks, open green spaces, and a quieter pace of life.

Despite its tranquil feel, Durley provides a strong sense of community, with a local primary school, village hall, and traditional pubs nearby. Everyday amenities can be found in the neighbouring areas of Bishops Waltham and Fair Oak, both just a short drive away, offering a range of shops, cafés, and services.

For commuters, Skiviers Lane benefits from convenient access to Southampton, Winchester, and the M27 motorway network, making it an excellent choice for those looking to balance countryside living with accessibility.

This location perfectly combines rural charm with modern convenience, making it particularly appealing to families and those looking to enjoy a more relaxed Hampshire lifestyle.

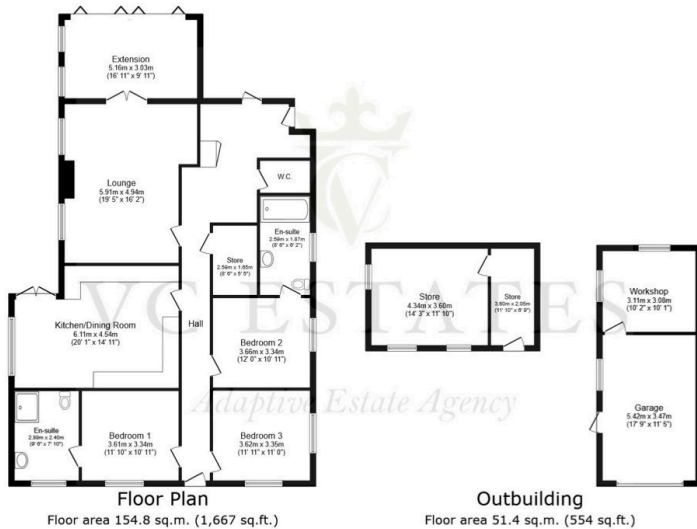

Total floor area: 206.3 sq.m. (2,220 sq.ft.)

This floor plan is for illustrative purposes only. It is not drawn to scale. Any measurements, floor areas (including any total floor area), openings and orientations are approximate. No details are guaranteed, they cannot be relied upon for any purpose and do not form any part of any agreement. No liability is taken for any error, omission or misstatement. A party must rely upon its own inspection(s). Powered by www.propertybox.io

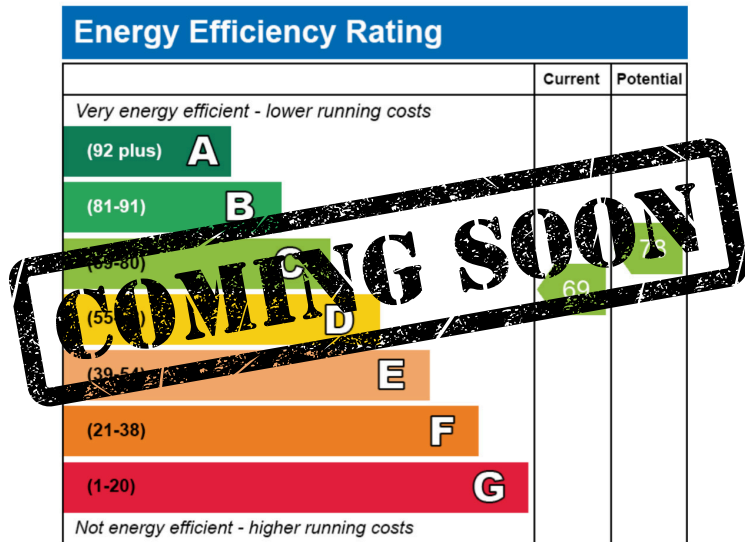

KEY INFORMATION

- Local Authority: Winchester
- Council Tax Band: F
- EPC Rating: EPC Ordered
- Freehold
- Catchment School: Durley Primary School
- Catchment Secondary School: Wyvern Technology College
- Windows: Double glazed
- Heating: Gas central heating and log burner
- Parking: Driveway parking and garage
- Viewing: By appointment only





DISCLAIMER

All dimensions and measurements provided are approximate and intended solely as a general guide. VC Estates has not tested any fixtures, fittings, or appliances mentioned within these particulars, and therefore cannot confirm their functionality or condition. Prospective purchasers are encouraged to liaise with the relevant local authority to verify council tax bands and associated charges.

Images included in these particulars are for illustrative purposes only and should not be assumed to reflect items included in the sale. While every effort has been made to ensure accuracy, the information provided does not form part of any offer or contractual agreement. VC Estates strongly advises that solicitors thoroughly review all details—particularly property boundaries, and the results of local authority searches—during pre-contract enquiries as part of the due diligence process.

AGENT ID: 9295

/// Brambles.hikes.coil



CLAIRE FAY
023 8251 9295

✉ claire@vcestates.co.uk
🌐 www.vcestates.co.uk
📷 @vcestates

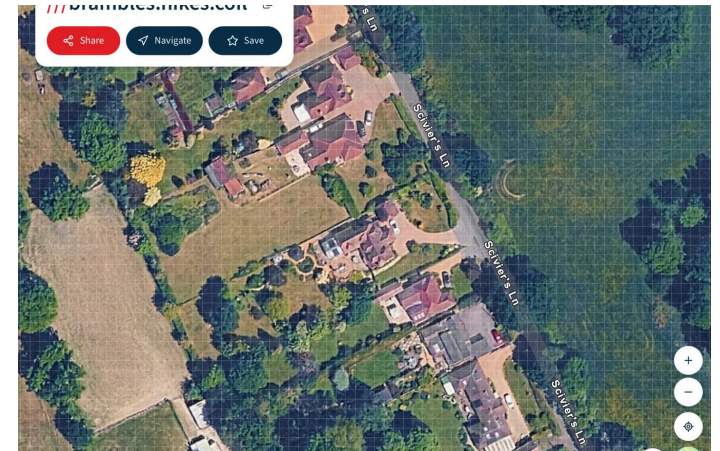

🛋️ 3 🛏️ 3 🛁 1

