

# Pembroke Road

CLIFTON

APPROXIMATE FLOOR AREA  
54.1 SQM / 582 SQFT



RAISED GROUND FLOOR  
582 sq.ft. (54.1 sq.m.) approx.

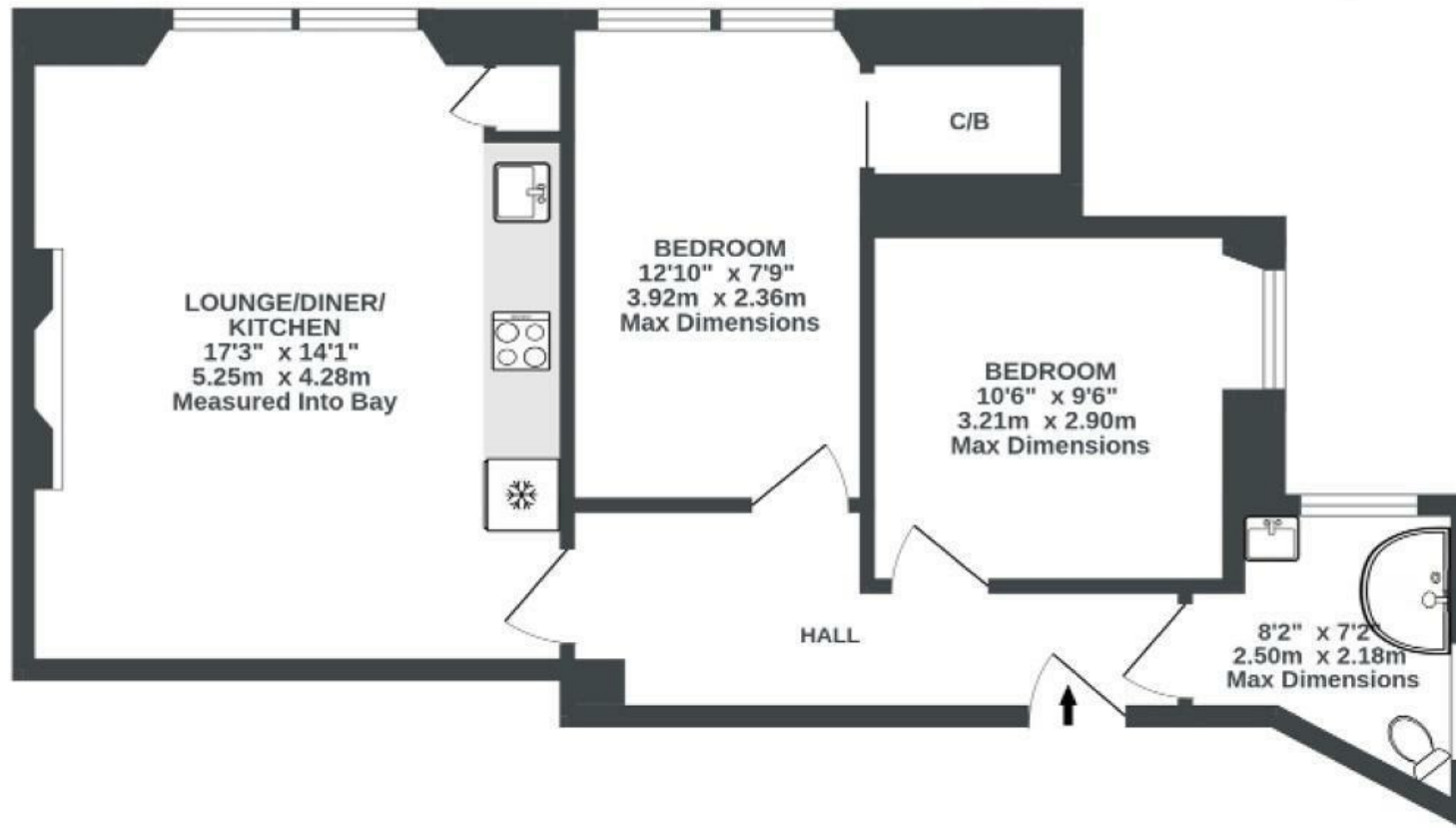

Illustrations are for reference purposes only, measurements are approximate, not to scale.

Boardwalk

# Pembroke Road

CLIFTON, BRISTOL



£375,000



2 Bedrooms



BS8 3ER



1 Bathrooms

*"The apartment has wonderfully high ceilings and feels so much more spacious than you might expect. We love waking up on a Sunday morning when the sun is shining and wandering into Clifton for a coffee, or heading up to the Downs for a breath of fresh air."*

