



THE PROPERTY EXPLORER



13 Cropmark Way

Hatch Warren, Basingstoke, RG22 4TA

£1,300 PCM



Explorer Lettings are pleased to present this newly refurbished 2 bedroom home, with an enclosed garden, and allocated parking. Conveniently located close to local schools and amenities. Regret no pets. Unfurnished. Council Tax C. AVAILABLE IMMEDIATELY. No fridge/freezer or washing machine provided!

Tenant Information: Assuming rent agreed at £1,300 per month the Holding Deposit £300 is payable once offer accepted 'Subject to contract' to go towards first months rent and 5 x weeks Security Deposit £1,500 + Remaining First months rent £1,200 payable 2 working days before check in.

NB. Applicants must earn min 30 x rental (£1,300 pcm x 30) = £39,000 per year



Full Description

- Freshly decorated
- Refurbished bathroom
- Modern Kitchen
- Allocated parking
- No fridge/freezer or washing machine provided!
- AVAILABLE IMMEDIATELY

Floor Plan

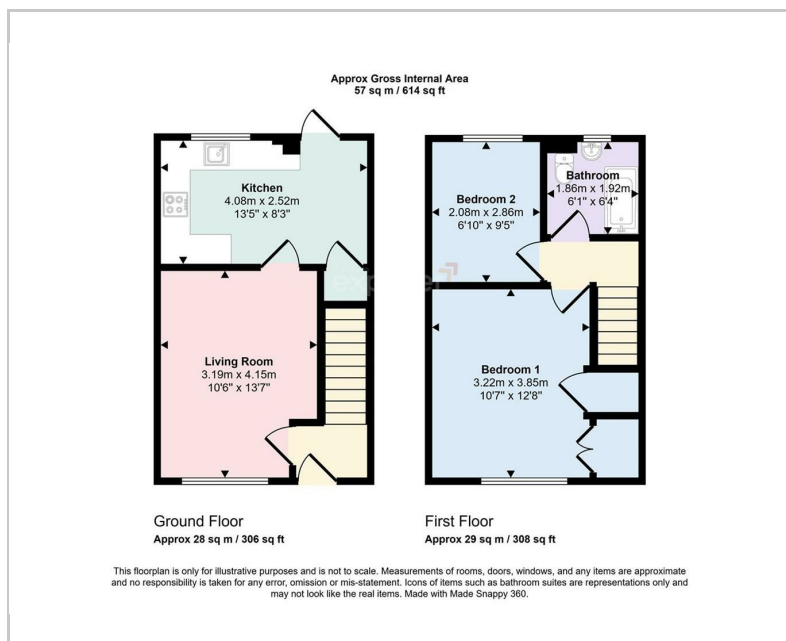

Energy Efficiency Graph

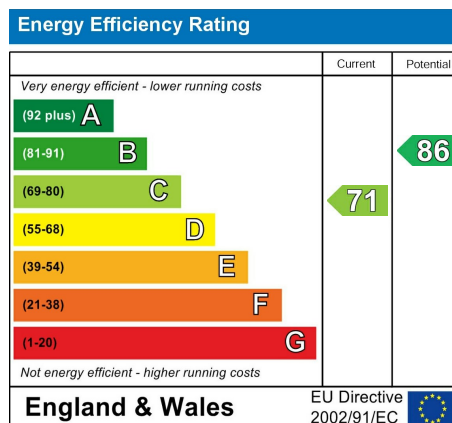

These particulars, whilst believed to be accurate are set out as a general outline only for guidance and do not constitute any part of an offer or contract. Intending purchasers should not rely on them as statements of representation of fact, but must satisfy themselves by inspection or otherwise as to their accuracy. No person in this firm's employment has the authority to make or give any representation or warranty in respect of the property.

www.thepropertyexplorer.co.uk

T 01256 321777 E hello@thepropertyexplorer.co.uk Arena Business Centre, Suite GF11 The Square, Basing View, Basingstoke, Hampshire, RG24 4EP