

Westbourne Court, Orsett Terrace, W2

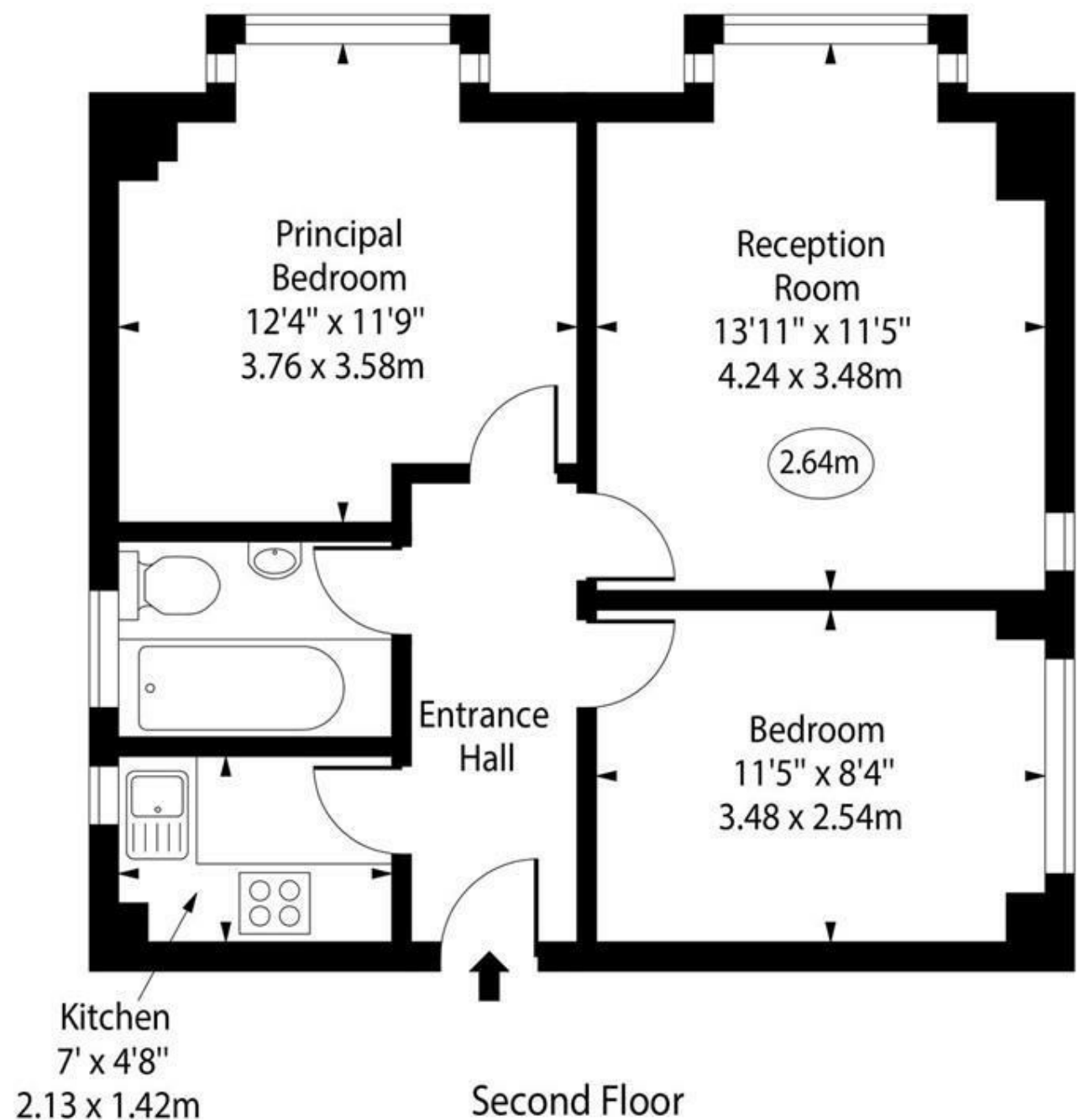

○ - Ceiling Height



Approx Gross Internal Area 520 Sq Ft - 48.31 Sq M

For Illustration Purposes Only - Not To Scale

www.goldlens.co.uk

Ref. No. 021704AN

Gravity Estates
18 Golders Green Road, London, NW11 8LL
02083570810 admin@gravity-estates.com

GRAVITY

estates

Gravity Estates
18 Golders Green Road, NW11 8LL
02083570810
admin@gravity-estates.com
www.gravity-estates.com



Orsett Terrace, London, W2 6JT

A beautiful 2 bedroom, 1 bath apartment with spacious reception room located in Westbourne Court, Orsett Terrace, W2.

The property is located on the second floor of a period building, close to Queensway area and within a 10 minute walk of Paddington Station.

The flat is accessible via the lift and the building has a day porter.

Heating costs included in the annual service charge.

Leasehold

£639,995

