

SIGNATURE

NORTH EAST

OFFICIALLY RATED THE NO.1 ESTATE AGENT IN THE NORTH EAST





📍 Simonside Terrace, Newcastle Upon Tyne NE6 5DS

Simonside Terrace, Newcastle Upon Tyne NE6 5DS

**£950 Per Calendar
Month**

We are delighted to welcome this charming two-bedroom ground floor flat to our lettings collection, offering spacious and well-balanced accommodation throughout. An inviting hallway sets the tone on arrival, leading to a bright and airy living room where a feature fireplace creates a natural focal point and a cosy setting for everyday living. The kitchen sits just beyond, providing generous worktop space, a range of wall and base units, and direct access to the rear yard, ideal for added convenience. The bathroom is accessed off the kitchen and is fitted with a bath, overhead shower, wash basin and WC. Two well-proportioned bedrooms are accessed from the hallway, with the principal bedroom enhanced by a beautiful bay window that fills the room with natural light, while the second bedroom offers versatility for guests, family or home working. On-street parking is available close by.

Situated within a popular and well-connected residential area, the property benefits from a strong sense of community and an excellent range of local amenities close by. Reputable schools, parks and green spaces are all within easy reach, while Chillingham Road Metro station is just a short walk away, providing direct access to Newcastle city centre and beyond. With key road links including the A1058 nearby, this location offers both convenience and connectivity, making it an ideal place to call home.

Available: April 2026
Tenancy Term: 12 months +
Council Tax Band: A
£950 PCM

TENANCY APPLICATION FEES:

To reserve this property, a refundable holding deposit of one week's rent is required, on move in, this will be deducted from your first months rent. A damage deposit for the property is compulsory and is equivalent to 5 week's rent.



PLEASE NOTE THAT THE VENDOR HAS CERTIFIED THE PROPERTY INFORMATION AND IMAGES.

PROPERTY FLOORPLAN

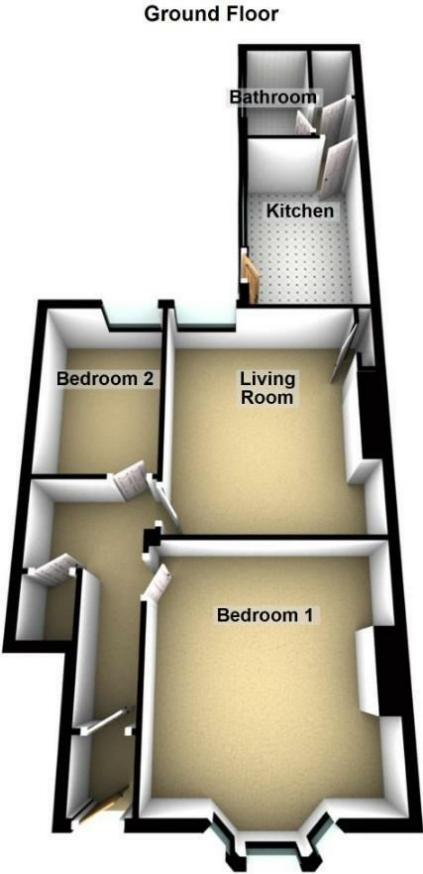

Please be advised the floorplans are not drawn to scale and are to be used to give an idea of the layout of the property.
Plan produced using PlanUp.

Measurements:

Living Room
14'6" x 12'10"

Kitchen
13'1" x 7'8"

Bedroom One
17'0" x 13'5"

Bedroom Two
10'11" x 7'3"

Bathroom
7'9" x 4'4"

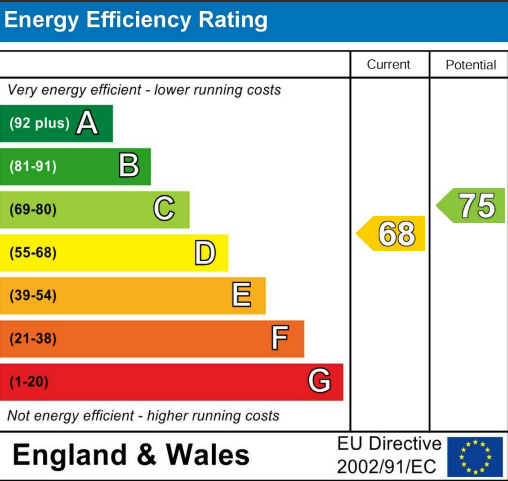





More 5 Star Customer Reviews than any other Agent based in the North East on allAgents.co.uk



SALES

LETTINGS

FINANCE

LAW

WE COVER THE WHOLE OF THE NORTH EAST

Whitley Bay
0191 251 3344

Cramlington
01670 897 213

Tynemouth
0191 296 6689

Morpeth
01670 513 966

Ponteland
01661 820 082

Wallsend
0191 432 4151

Alnwick
01665 511 800

Heaton
0191 432 4275

Forest Hall
0191 266 9966

Other locations
0191 640 3523

Newcastle
0191 640 2284

Durham
0191 303 8252

Gosforth
0191 640 3523

Sunderland
0191 543 6390

Whickham
0191 432 5102

Gateshead
0191 432 4294

Jesmond
0191 281 1037

Killingworth
0191 640 3602

Ryton
0191 413 9845

Head Office &
Lettings
0191 253 4815

*Highest recommended 5-star reviews than any other Estate Agent based in the North East on allAgents.co.uk - The UK's Largest Customer Review Website for the Property Industry & Awarded Best Estate Agency 2018 & 2019 - North East England by SME News