



# KENNINGTON PARK ROAD, SE11

£695,000

Georgian building  
High ceilings  
Moments from Kennington station.  
Close to Kennington park  
Lots of natural light  
Chain free

@marshandparsons  
marshandparsons.co.uk

MARSH &  
PARSONS



# ABOUT THE PROPERTY

Beautifully presented with abundant natural light and impressive high ceilings, this stunning flat offers stylish, spacious living moments from Kennington Park. The open-plan kitchen/reception room features large Georgian sash windows, perfect for entertaining. There are two generous double bedrooms and two modern bathrooms, including an en-suite.

Set on a popular tree-lined road, it is a short walk to Kennington station, with excellent links to the City and West End. Local cafés, shops and a farmers' market near St Mark's Church are close by. Offered chain free and with a Right to Manage (RTM).



# STEP INSIDE KENNINGTON PARK ROAD

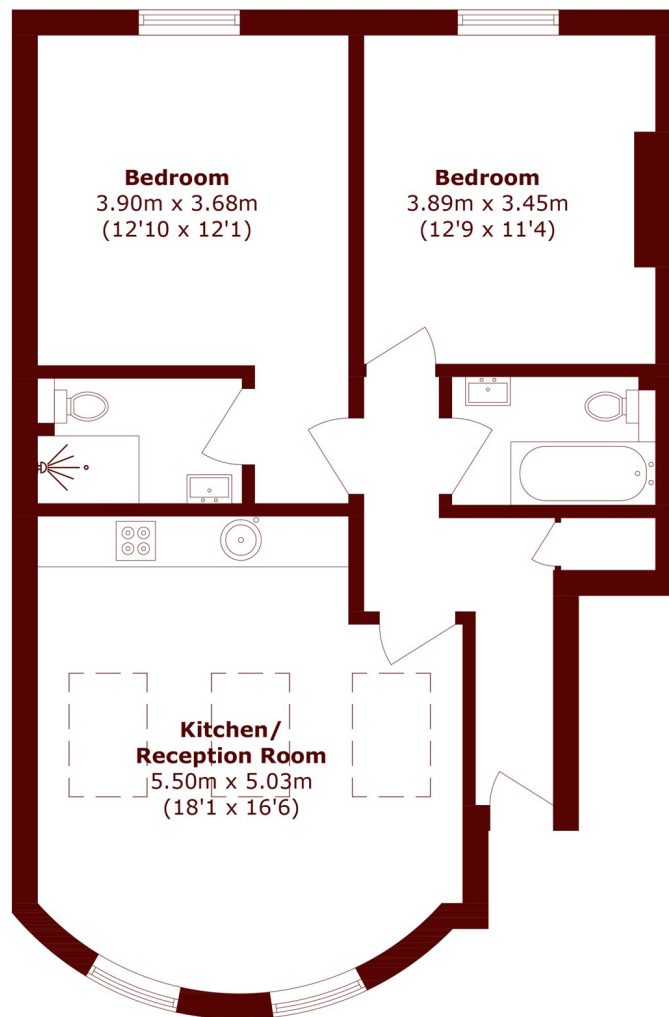

## Third Floor

Total area (approx.): 72.6 sq. m (781.5 sq. ft)

**Kennington**  
020 7587 1533

Energy Rating: C We aim to make our particulars both accurate and reliable. However, they are not guaranteed; nor do they form part of an offer or contract. If you require clarification on any points then please contact us, especially if you're traveling some distance to view. Please note that appliances and heating systems have not been tested and therefore no warranties can be given as to their good working order

**MARSH &  
PARSONS**