



4 Lamberhurst Mews

Ashford, TN23 5TT

Price £275,000

A pleasantly appointed terraced home close to local schools and amenities, offered for sale with no onward chain.

The property comprises an entrance hall, cloakroom, sitting/dining room, kitchen, three bedrooms and family bathroom. Two allocated parking spaces are available to the front of the property along with gas central heating, double glazing and an enclosed rear garden.

- MODERN TERRACED HOME
- THREE BEDROOMS
- SITTING/DINING ROOM
- GROUND FLOOR CLOAKROOM
- ENCLOSED REAR GARDEN
- ALLOCATED PARKING FOR TWO CARS
- GAS CENTRAL HEATING & DOUBLE GLAZING
- NO ONWARD CHAIN

Viewing

Please contact our Ashford Office on 01233 646411 if you wish to arrange a viewing appointment for this property or require further information.



Floor Plan

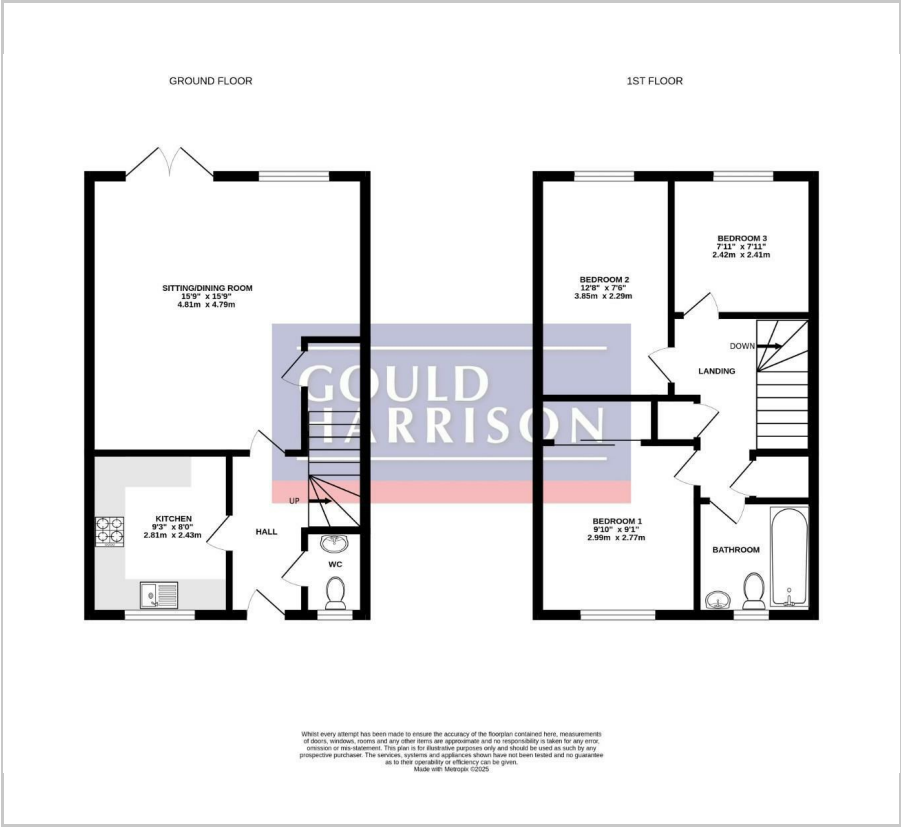

Area Map



Energy Efficiency Graph

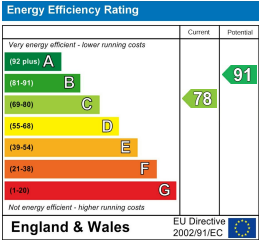

These particulars, whilst believed to be accurate are set out as a general outline only for guidance and do not constitute any part of an offer or contract. Intending purchasers should not rely on them as statements of representation of fact, but must satisfy themselves by inspection or otherwise as to their accuracy. No person in this firms employment has the authority to make or give any representation or warranty in respect of the property.