



**Torrent Lodge Merryweather Place, London SE10 8EQ**

***welcome to***

## **Torrent Lodge Merryweather Place, London**

A beautifully presented two-bedroom apartment in the prestigious Merryweather Place development. Offering open-plan living, a private balcony, and secure access, this stylish home enjoys a prime SE10 location close to Greenwich Station, DLR, and local amenities.

### **Reception Room**

15' 2" x 15' 2" ( 4.62m x 4.62m )

### **Kitchen**

14' x 6' 7" ( 4.27m x 2.01m )

### **Balcony**

### **Bedroom One**

14' 1" x 10' 2" ( 4.29m x 3.10m )

### **Bedroom Two**

15' x 9' 9" ( 4.57m x 2.97m )

### **Bathroom**

### **Ensuite**

### **Balcony 2**

# Merryweather Place, SE10 8EQ

Approx Gross Internal Area = 81.2 sq m / 874 sq ft

Balconies = 25.4 sq m / 273 sq ft

Total = 106.6 sq m / 1147 sq ft

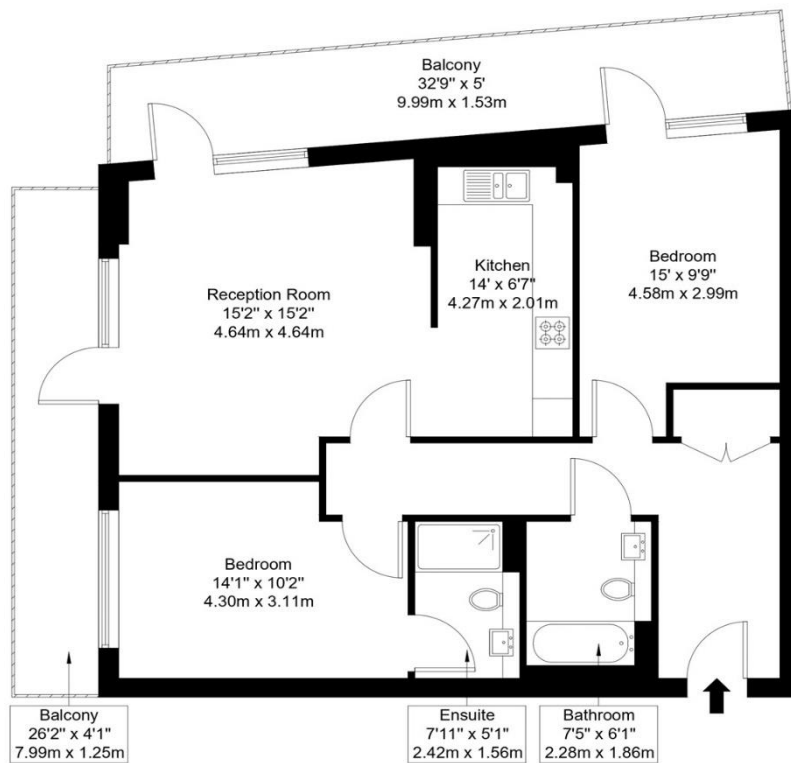

Second Floor

Ref :

Copyright **BLEU PLAN**

The Floor plan is not to scale and measurements and areas shown are approximate and therefore should be used for illustrative purposes only. The plan has been prepared in accordance with the RICS code of Measuring Practice and whilst we have confidence in the information produced it must not be relied on. Maximum lengths and widths are represented on the floor plan. If there is any aspect of particular importance, you should carry out or commission your own inspection of the property.

Copyright © BleuPlan



**welcome to**

## **Torrent Lodge Merryweather Place, London**

- CONTEMPORARY TWO-BEDROOM APARTMENT IN PRIME GREENWICH LOCATION
- PRESTIGIOUS MERRYWEATHER PLACE DEVELOPMENT
- STYLISH OPEN-PLAN LIVING AND DINING AREA
- PRIVATE BALCONY PROVIDING OUTDOOR SPACE
- SECURE ENTRY SYSTEM, LIFT ACCESS AND OFF STREET PARKING AVAILABLE TO RENT - ASK AGENT

Tenure: Leasehold EPC Rating: B

Council Tax Band: D Service Charge: Ask Agent

Ground Rent: 350.00

This is a Leasehold property with details as follows; Term of Lease 999 years from 01 Jan 2007. Should you require further information please contact the branch. Please Note additional fees could be incurred for items such as Leasehold packs.

# £440,000



**view this property online** [barnardmarcus.co.uk/Property/PKM103543](https://barnardmarcus.co.uk/Property/PKM103543)



Property Ref:  
PKM103543 - 0006

1. MONEY LAUNDERING REGULATIONS Intending purchasers will be asked to produce identification documentation at a later stage and we would ask for your co-operation in order that there is no delay in agreeing the sale. 2. These particulars do not constitute part or all of an offer or contract. 3. The measurements indicated are supplied for guidance only and as such must be considered incorrect. Potential buyers are advised to recheck measurements before committing to any expense. 4. We have not tested any apparatus, equipment, fixtures or services and it is in the buyers interest to check the working condition of any appliances. 5. Where an EPC, or a Home Report (Scotland only) is held for this property, it is available for inspection at the branch by appointment. If you require a printed version of a Home Report, you will need to pay a reasonable production charge reflecting printing and other costs. 6. We are not able to offer an opinion either written or verbal on the content of these reports and this must be obtained from your legal representative. 7. Whilst we take care in preparing these reports, a buyer should ensure that his/her legal representative confirms as soon as possible all matters relating to title including the extent and boundaries of the property and other important matters before exchange of contracts.

Barnard Marcus is a trading name of Sequence (UK) Limited which is registered in England and Wales under company number 4268443, Registered Office is Cumbria House, 16-20 Hockliffe Street, Leighton Buzzard, Bedfordshire, LU7 1GN. VAT Registration Number is 500 2481 05.



barnard marcus



**020 7635 8641**



[peckham@barnardmarcus.co.uk](mailto:peckham@barnardmarcus.co.uk)



152 Rye Lane, Peckham, LONDON, SE15 4NB



**[barnardmarcus.co.uk](https://barnardmarcus.co.uk)**