



9 Marriotts Walk, Witney OX28 6GX

Draft details - may be subject to alterations.

A spacious and light first floor 1 bedroom apartment situated at the Marriotts Walk development, with accommodation to include an entrance hall, living/dining room, kitchen and a bathroom, double glazing and electric heating. There is the added benefit of easy access to the external terrace; offering a shared communal area, plus a car parking space in the secure lower section of the adjacent multi storey car park. Available for sale with no onward chain.

**THOMAS
MERRIFIELD**

SALES LETTINGS

e. witney@thomasmerrifield.co.uk

t. 01993 772000

Price £165,000

www.thomasmerrifield.co.uk



9 Marriotts Walk, Witney, Oxfordshire OX28 6GX

- Entrance Hall
- Kitchen
- Living/Dining Room
- Bedroom
- Bathroom
- Communal Terrace Area
- Parking In The Secured Gated Area
- No Onward Chain

Material Information - source Ofcom:
All mains connected except gas. Ultrafast broadband is available. Mobile & Data Signals - Good for EE, O2, Three & Vodafone.

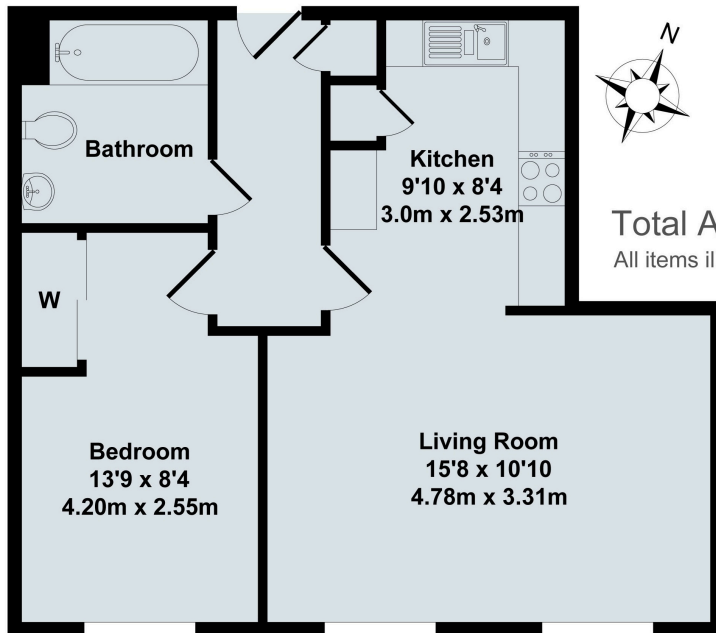

9 Marriotts Walk, Witney

Total Approx. Floor Area 465 Sq.Ft. (43.20 Sq.M.)

All items illustrated on this plan are included in the "Total Approx Floor Area"

First Floor

Local Authority:

WODC Tax Band B/ EPC Rating: 69/C

Contact:

52 Market Square, Witney,
Oxfordshire, OX28 6AF

Tenure:

Leasehold Service Charge + Insurance Tel: 01993 772000
£689.35p.a. Ground Rent: £300 p.a. for 2026 Email: witney@thomasmerrifield.co.uk

Important Notice

Thomas Merrifield for themselves and their clients give notice that:-

1. They are not authorised to make or give representation or warranty in relation to this property, either on their own behalf or on behalf of the Seller. They assume no responsibility for any statement made in these particulars. These particulars do not form part of any offer or contract and must not be relied upon as statements or representations of fact.
2. Whilst every attempt has been made to ensure the accuracy of the floorplan contained here, measurements of doors, windows, rooms and any other items are approximate and no responsibility is taken for any error, omission, or mis- statement.
3. All areas, measurements or distances are approximate. The particulars are intended for guidance only and are not necessarily comprehensive. A wide angle lens may have been used in photography. Thomas Merrifield have not tested appliances or services and it should not be assumed that the property has all necessary planning, building regulation and other consents. Buyers must satisfy themselves with the property by inspection or otherwise.
4. Reference to any mechanical or electrical equipment does not constitute a representation that such equipment is capable of fulfilling its function and prospective Buyers must make their own enquiries.
5. They have no responsibility for any expenses or costs incurred by prospective Buyers in inspecting properties which have been sold, let or withdrawn. Applicants are advised to contact the Agent to check availability and any other information of particular importance to them, prior to inspecting the property, particularly if travelling some distance.