

HENDERSON CONNELLAN

ESTATE AGENTS

Castle Hill, Rothwell, NN14

"Urban Cottage"

"Urban Cottage"

With a lovely street side appearance, situated on this tree lined hill, this fabulous cottage combines period living with an ultra-convenient setting within a conservation area. The local butchers, coffee shops, fabulous restaurants, the bakery, and a whole range of amenities are literally a moments' walk away. The cosy interior features a living room with period fireplace and a free flowing Kitchen/Breakfast room. Upstairs there are two bedrooms and a principal bathroom with separate WC. Outside there is a walled foregarden and a lovely courtyard garden to be the back. A unique cottage in a very convenient setting.

Living Room - 3.35m x 3.33m (11'0" x 10'11")

Kitchen - 3.68m x 2.79m (12'1" x 9'2")

Bedroom One - 3.48m x 3.33m (11'5" x 10'11")

Bathroom - 1.73m x 1.6m (5'8" x 5'3")

Bedroom Two - 2.9m x 1.93m (9'6" x 6'4")

- Rothwell Town
- Mid Terrace
- Two Bedrooms
- EPC RATING D
- Council Tax: A
- Tenure: Freehold





Ground Floor

Approx. 17.0 sq. metres (182.7 sq. feet)



First Floor

Approx. 25.5 sq. metres (274.3 sq. feet)

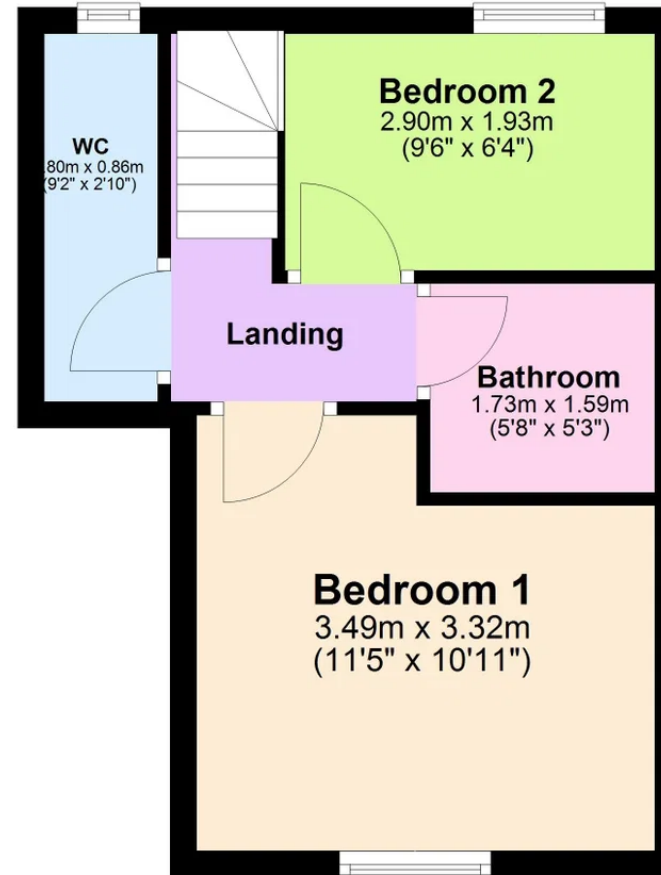

Total area: approx. 42.5 sq. metres (457.0 sq. feet)



Henderson Connellan Kettering office 01536 417888 ketteringsales@hendersonconnellan.co.uk

Disclaimer: These particulars do not form part of any offer or contract and should not be relied upon as statements or representations of fact. Any areas, measurements of distances are approximate. The text, photographs and plans are for guidance only and are not necessarily comprehensive.

