

MUNDAY'S

Dingley Lane, Streatham Hill

£339,950



Delightful one bedroom ground floor purpose-built ex-LA flat of 493 square feet, with a private courtyard garden plus a large and secure brick-built shed.

Find your new home within a well-designed, low-rise estate in the leafy Streatham Hill locale, winning-at-life close to Tooting Bec Common and its fab Lido. You are a five minute walk from Streatham Hill Station (17 mins to London Victoria) and the SH end of Streatham High Road. Balham tube is a 20 minute walk. Bus routes (to Brixton and beyond) are great in these parts, too.

Munday's Estate Agents Ltd.
2 Mary Boast Walk
London SE5 8SP
020 3318 8900

www.mundays.com

MUNDAY'S



Munday's Estate Agents Ltd.
2 Mary Boast Walk
London SE5 8SP
020 3318 8900

www.mundays.com

MUNDAY'S

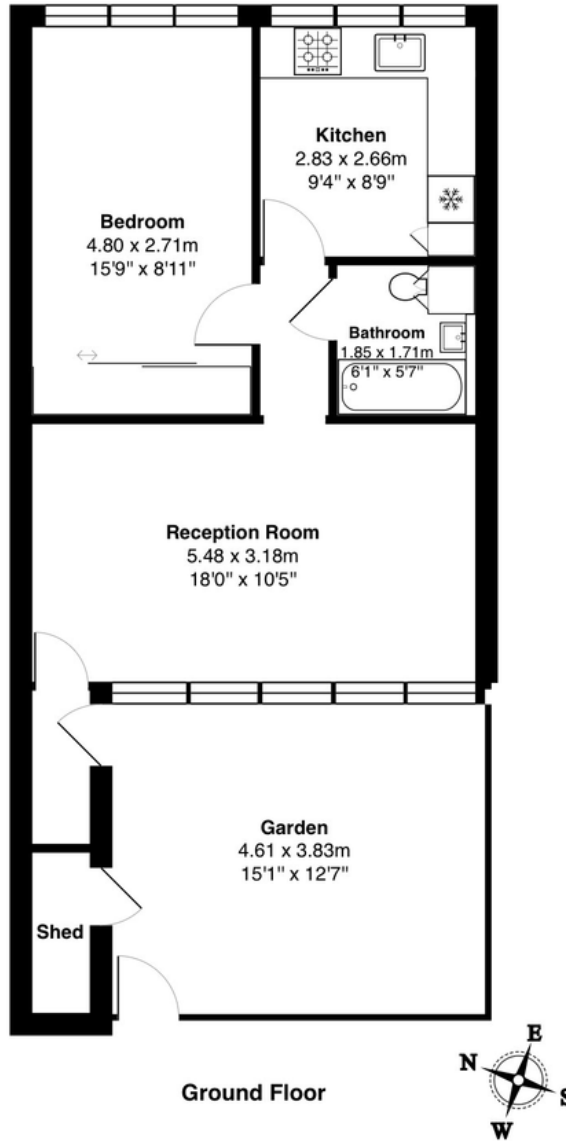

Total Area: 45.8 m² ... 493 ft² (excluding garden, shed)

All measurements are approximate and for display purposes only

Munday's Estate Agents Ltd.
2 Mary Boast Walk
London SE5 8SP
020 3318 8900

www.mundays.com