

Location:

Shaa Road is located close to the amenities of Acton Central and Shepherd's Bush. Both Acton Central and Acton Main Line stations are close by for links to and from central London.

Key points:

- 2 Bedrooms
- Communal gardens
- Modern apartment
- Designated parking
- Period building
- Available now

Do Better:

Acton
sales@astonrowe.co.uk

57-59 Churchfield Road,
Acton, London, W3 6AY

020 8992 3600

Aston Rowe

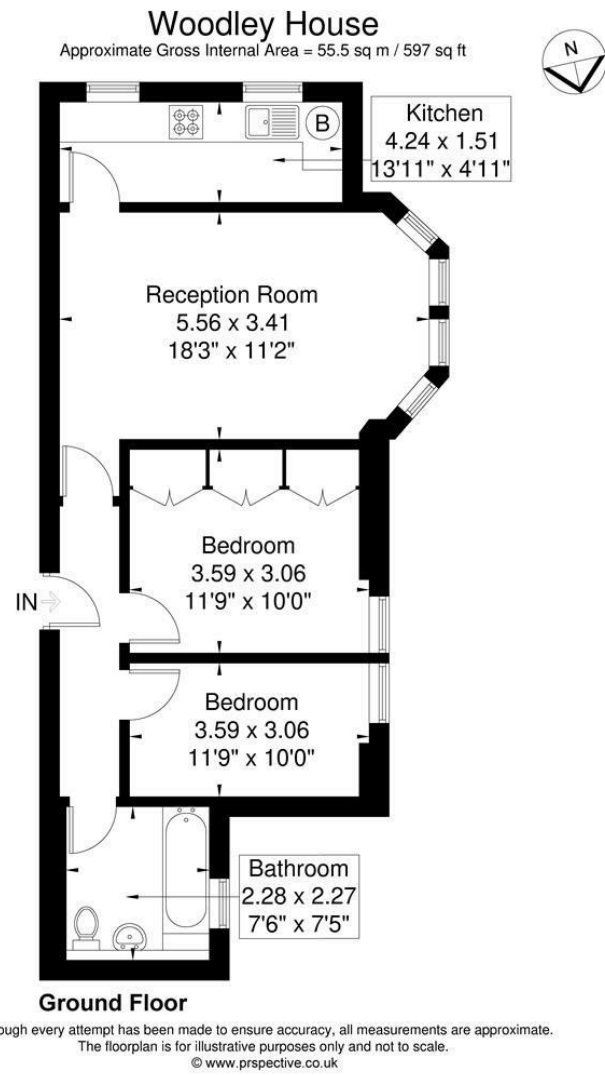

£2,400 Per Month

Shaa Road, London W3 7LN

Energy Efficiency Rating		Environmental Impact (CO ₂) Rating	
Current	Potential	Current	Potential

Energy Efficiency Rating scale (A-G) and Environmental Impact (CO₂) Rating scale (A-G) are shown. Legend: A (92+), B (81-91), C (69-80), D (55-68), E (39-54), F (21-38), G (1-20).

- 1 Reception Rooms
- 2 Bedrooms
- 1 Bathrooms

The current owner says:

Available now

An impressive and well presented two double bedroom, set within an attractive period building situated on a popular residential road. This property boasts an impressive reception room and separate kitchen, two generous double bedrooms and family bathroom. The apartment has the use of a large communal rear garden and off street parking. Ideally located within easy reach of Acton Central Station, this property is also walking distance to East Acton and Acton Town tube stations.



What's better:

A two bedroom ground floor flat in W3.

