



## White City Estate, W12

£275,000

A modern, bright, purpose-built flat ideally situated on the edge of the White City Estate. The accommodation features a spacious open-plan living kitchen. The property is offered with no onward chain, making it an excellent opportunity for a first timer buyer or investor.

The property is less than half a mile away from White City Station (Central Line) and Wood Lane Station (Hammersmith & City Line) and is within walking distance to Westfield Shopping Centre.

### Features

- No Onward Chain
- One Bedroom Apartment
- Unrestricted Views
- Westfield Shopping Centre
- Great Transports Links
- Wormholt Park

White City Estate,  
London, W12

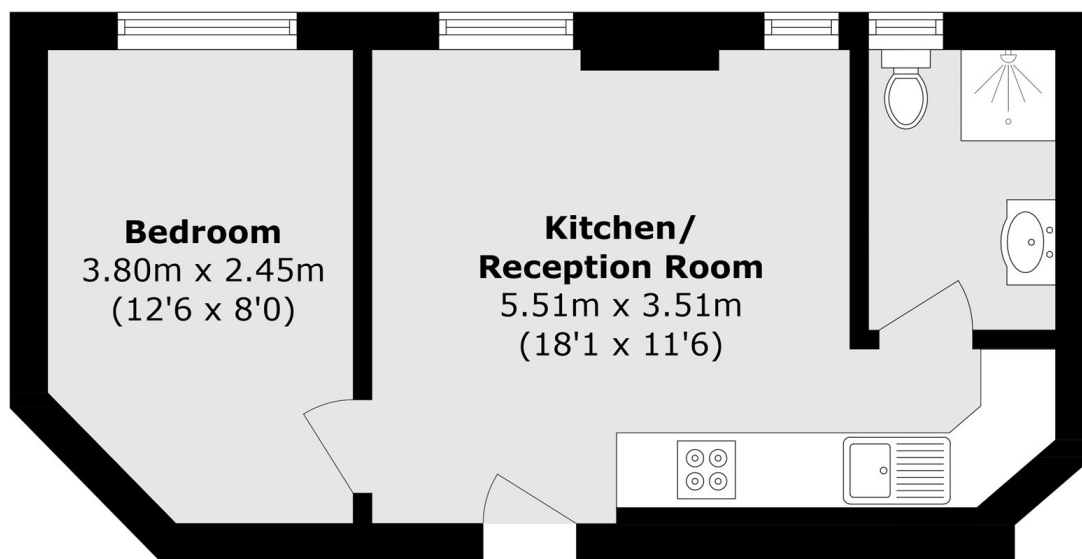

Total area (approx.): 29.9 sq. m (321.8 sq. ft)