

## 10 Park Drive, Canary Wharf, E14

£2,400PCM (Deposit: £2,769)

🛏 0 🚿 1 🛋 1



Tax Band: E Furnished: Furnished

Quote MG1175 for all enquiries.

7th Floor

Almost 400 sqft

Underfloor Heating & Comfort Cooling

Close to Elizabeth Line, Jubilee & DLR

• Large Studio

• East View

• Third Space Membership Included

• 24 Hour Concierge & Security

• Modern Fittings Throughout

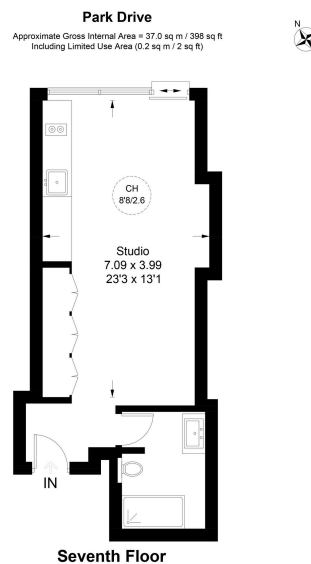

Illustration for identification purposes only, not for valuation purposes, measurements are approximate, not to scale. IPMS2

Situated on the 7th floor of the prestigious 10 Park Drive development, this beautifully presented east-facing studio apartment is offered fully furnished and finished to an exceptional standard.

The apartment features a bright open-plan living space with floor-to-ceiling windows, a contemporary fitted kitchen with integrated appliances and a luxurious modern bathroom.

Residents benefit from outstanding facilities including a 24-hour concierge, exclusive residents' lounge and terrace, plus access to a 40,000 sq ft health and fitness club with gym, swimming pool, jacuzzi, sauna and steam rooms.

Located in the heart of Canary Wharf, you'll have an excellent choice of shops, cafés, bars and restaurants on your doorstep, with the Elizabeth Line, Jubilee Line and DLR all within easy reach, making this an ideal home for professionals seeking luxury living in a prime London location.