



## 5 Stroud Park Avenue

, Christchurch, BH23 3HQ

**Guide price £340,000**



# 5 Stroud Park Avenue

, Christchurch, BH23 3HQ

**Guide price £340,000**



A two double bedroom semi-detached bungalow located in a quiet cul-de-sac in Christchurch.

Entry to the property is via the front door located on the side of the bungalow and it leads in to the entrance hall. The hallway benefits from a storage cupboard and access to the loft via a hatch.

The lounge diner benefits from french doors that lead on to the rear garden as well as an electric fireplace and surround.

The kitchen benefits from a range of wall mounted and base units with work surface over. There is an integrated oven, gas hob and extractor fan with space for further appliances that include a washing machine, dishwasher and fridge/freezer. The kitchen also houses the gas combi boiler and a door leads out to the driveway.

To the front of the property are two double bedrooms, both of which face the front aspect as well as benefiting from fitted wardrobes.

The shower room benefits from part tiled walls, frosted UPVC double glazed window, walk-in shower with sliding glass shower door, WC, wash hand basin and heated towel rail.

To the front of the property there is driveway providing off road parking which in turn leads to the detached garage. The rear garden is enclosed via a fence surround with a slabbed patio area, shrub borders and a greenhouse. The detached garage measures 2.53m (8'3) x 4.49 (14'7) and benefits from an up and over door, power and light.

The property is offered with no forward chain.

The property is located close to Stanpit, Mudeford and Somerford. The town centre of Christchurch is a short drive away and has a plethora of shops, restaurants, pubs and cafes. For the commuters, Christchurch or Hinton Admiral train stations provide regular services to Bournemouth, Southampton and London. Bournemouth International airport is a short drive away. Primary and secondary schools are within close proximity.

Copyright: - All photos, videos, and drone footage are copyrighted by Stour Estates. All rights reserved.

Any redistribution or reproduction of part or all of the contents in any form is prohibited other than the following:

1. You may print or download to local hard disk extracts for your personal and non-commercial use.
2. You may copy the content to individual third parties for their personal use, but only if you acknowledge Stour Estates as the source of the material.

You may not, except with our express written permission, distribute or commercially exploit the content. Nor may you transmit it or store it on any other website or another form of the electronic retrieval system.



## Road Map

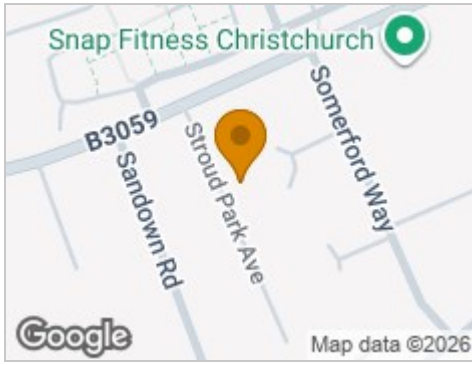

## Hybrid Map



## Terrain Map



## Floor Plan

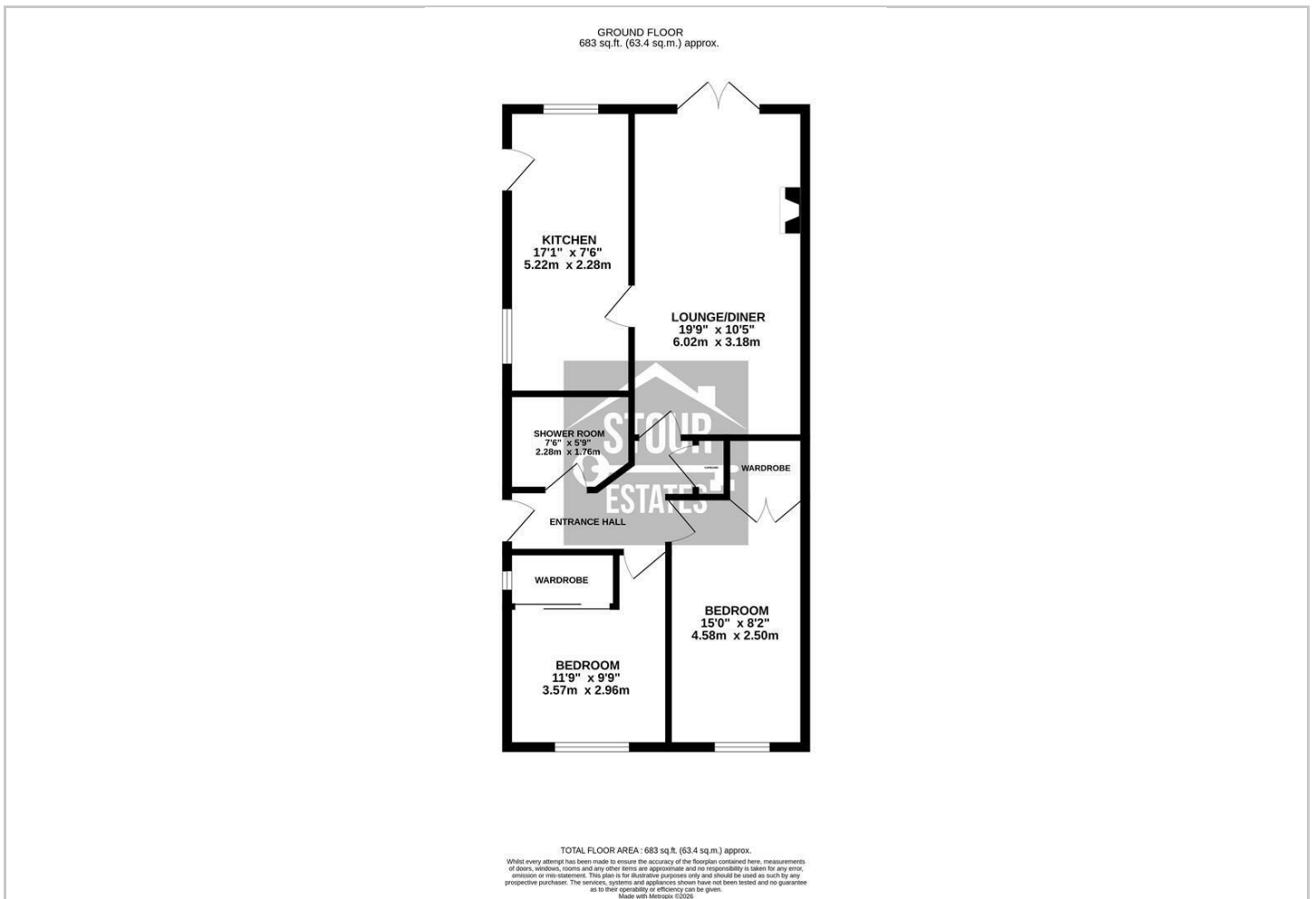

## Viewing

Please contact our Stour Estates Office on 01202 287847 if you wish to arrange a viewing appointment for this property or require further information.

## Energy Efficiency Graph

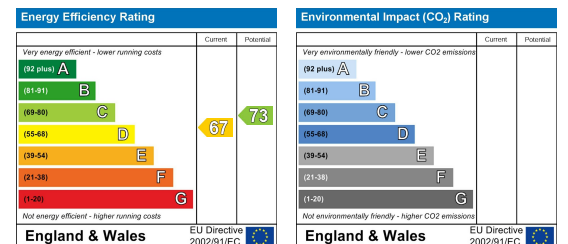

These particulars, whilst believed to be accurate are set out as a general outline only for guidance and do not constitute any part of an offer or contract. Intending purchasers should not rely on them as statements of representation of fact, but must satisfy themselves by inspection or otherwise as to their accuracy. No person in this firm's employment has the authority to make or give any representation or warranty in respect of the property.