



Harrowdene Gardens, TW11

£319,950

Dexters



Harroldene Gardens, TW11

Located in this popular development opposite Royal Bushy Park, this newly renovated, spacious first floor apartment has access to communal gardens, a garage and is within easy reach to Teddington Station and benefits from a new 149 year lease.

Harroldene Gardens is off Sandy Lane, an excellent spot for transport, with a well lit private footpath directly leading to Teddington mainline station and Teddington High Street within minutes. Royal Bushy Park, Kingston town centre is within easy reach along with the River Thames.

Features

- Double Bedroom
- No Onward Chain
- Garage
- Excellent Condition
- Communal Gardens
- Parking



Harrowdene Gardens, Teddington, TW11

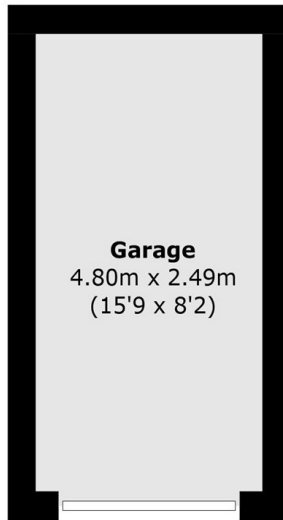

(Not Shown In Actual
Location / Orientation)

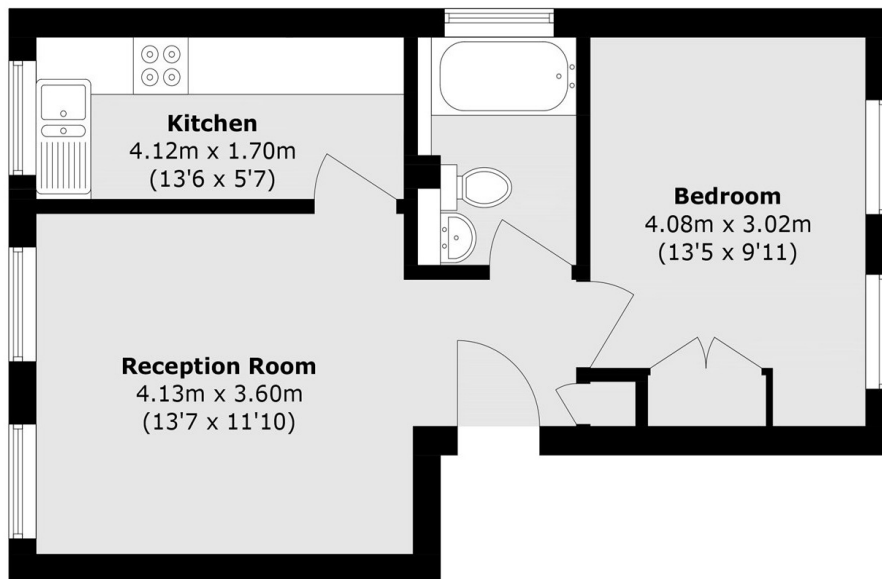

Total area (approx.): 42.6 sq. m (458.5 sq. ft)

Garage area (approx.): 11.9 sq. m (128.0 sq. ft)