



Whitemill Road, Chatteris, Cambs, PE16 6PG

No Upward Chain! - Semi- Detached Bungalow - 2 Bedrooms - Kitchen - Lounge & Conservatory - Shower Room
- Front & Rear Garden - Driveway & Garage - Call To View (01354) 696700

Offers In Excess Of

£220,000



Entrance Hall
Radiator, Built in airing cupboard and boiler cupboard.

Lounge
4.93m (16'1") x 3.31m (10'8")
Two radiators and door to:

Kitchen
2.93m (9'6") x 2.74m (8'9")
Fitted with a matching base and eye level units with worktop space over, composite sink with tiled splashbacks, double glazed window to side, double glazed window to rear, radiator, cooker, washing machine, fridge/freezer and dishwasher.

Bedroom 1
3.87m (12'6") x 3.32m (10'8")
Double glazed window to front, built in wardrobes and radiator.

Bedroom 2
2.79m (9'1") x 2.75m (9')
Double glazed window to front, double glazed window to side and radiator.

Conservatory
Part brick and UPVC construction with double glazed windows.

Shower Room
Fitted with three-piece suite comprising shower cubicle, wash hand basin and low-level WC, part tiled walls, double glazed window to side and radiator.

Outside
The property offers a block tarmac driveway which provides access to the garage. There is a small front lawn which is mainly laid to lawn and planted with a few shrubs.

A side gate allows access to an enclosed rear garden which consists of lawn and patio, there are also many planted shrubs and bushes.

EPC- TBC

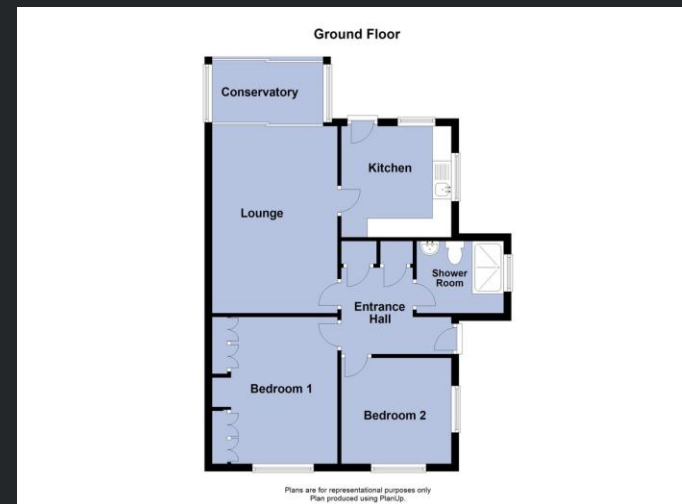

Call to arrange a viewing 01354 696700

T Payne & Co
SALES & LETTINGS

Agents Notes: Whilst every care has been taken to prepare these sales particulars, they are for guidance purposes only. All measurements are approximate and for general guidance purposes only and whilst every care has been taken to ensure their accuracy, they should not be relied upon and potential buyers are advised to recheck the measurements.

