



15 Howbury Street

, Bedford, MK40 3QU

£345,000



Floor Plan

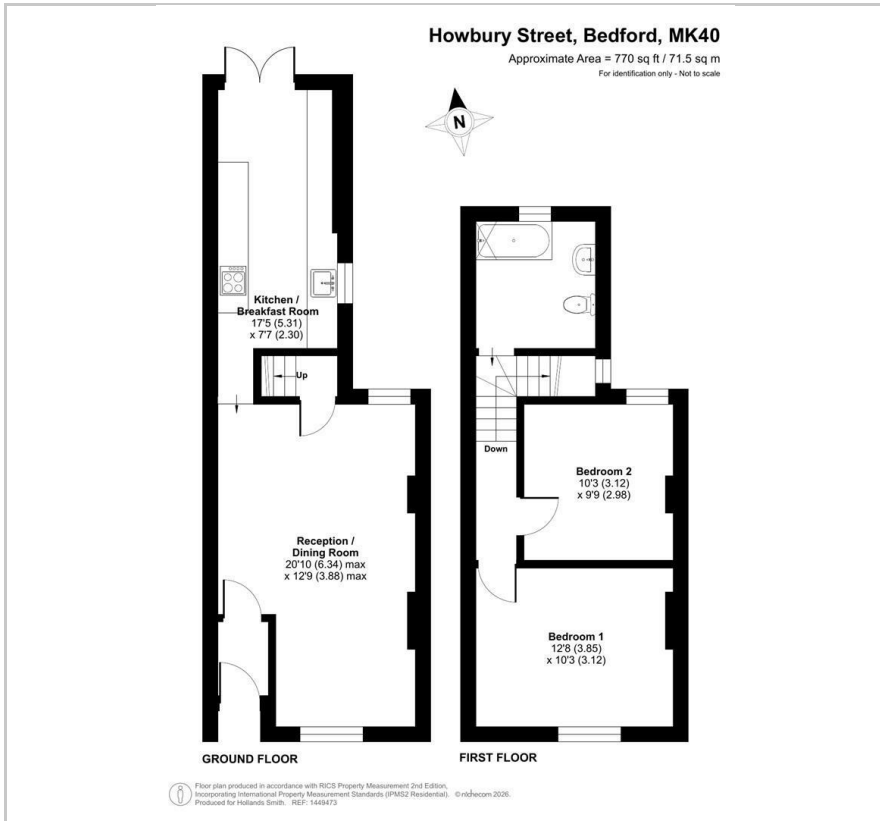

Area Map



Energy Efficiency Graph

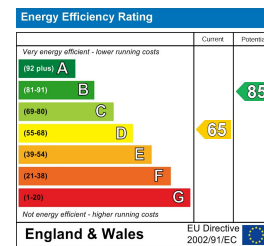

Viewing

Please contact our Bedford Office on 01234 216612 if you wish to arrange a viewing appointment for this property or require further information.



This Victorian terraced cottage is situated just a few steps away from Russell Park and is offered for sale with no upward chain. The accommodation features a spacious living room, a kitchen/breakfast room with French doors opening to the garden and there are two double bedrooms. The large first floor bathroom has a modern refitted suite. Period features are in evidence and there are double glazed windows throughout, predominantly in the heritage sash style. There is also gas to radiator heating from a combination boiler. New carpets and fresh décor mean that the property is ready to move into. Outside, there is a larger than usual low maintenance garden. Located in the heart of the 'Castle Quarter', there are a number of cafes and restaurants to choose from as well as popular pubs and specialist shops such as a butchers, Italian deli and home improvement stores. In addition to the park, The Embankment is very close by for riverside walks, Bedford town is just a short walk away and the mainline rail station offers fast links into London St Pancras. EER: D



163 Castle Road, MK40 3RT

Tel: 01234 216612

www.hollandsmith.co.uk