



## Blackthorn Avenue, N7

### £500,000

An immaculately presented one bedroom flat within a modern development overlooking Arundel Square. This home features contemporary finishes throughout with an open plan kitchen and living area, perfect for entertaining.

Highbury & Islington Station is under half a mile away, providing access to the Victoria, Overground & National Rail lines. Additionally, the trendy bars, shops and restaurants of Upper Street are all within easy reach.

### Features

- One Bed
- Modern Development
- Chain Free
- 236 Year Lease
- Concierge

# Blackthorn Avenue, London, N7

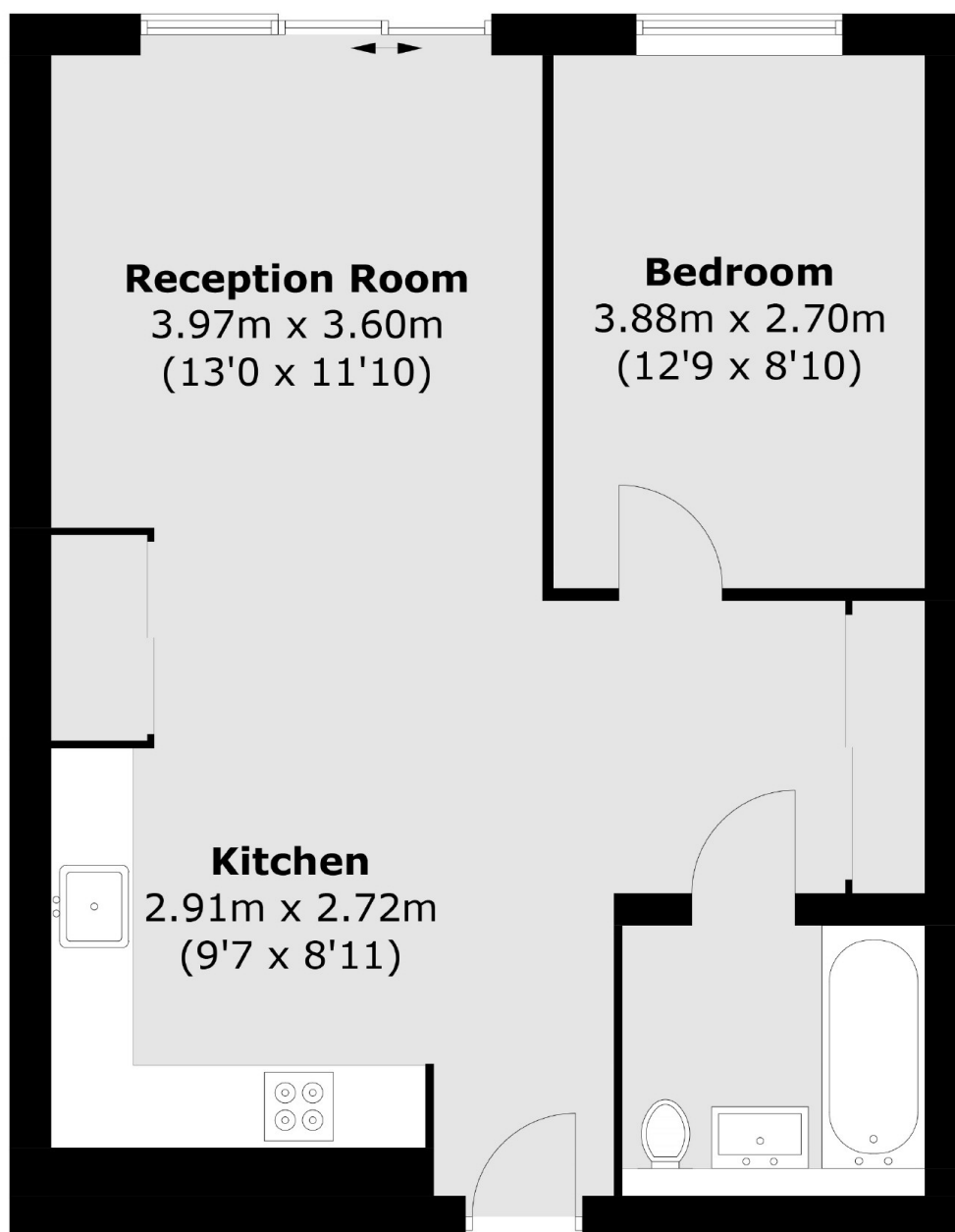

Total area (approx.): 53.2 sq. m (572.6 sq. ft)