

CHURCHILL PLACE, HARROW



Two Bedroom Purpose Built Flat

Asking Price £325,000

Description

Set within a stones throw from Harrow and Wealdstone Station, this modernised two double bedroom apartment is the perfect opportunity for first time buyers looking to get on the property ladder and equally for Investors looking for a buy to let opportunity, you can be in Euston from your door in 14 minutes! Based on the second floor of this popular development and accessible via entryphone, the apartment boasts two large double bedrooms, a recently updated separate kitchen, renovated bathroom and matching separate W.C and a lounge with wooden flooring. Other benefits include being close to the well respected Marlborough Hill School, double glazed windows throughout and a current lease of around 180 year.



Location: Churchill Place is situated 0.1 miles from Harrow & Wealdstone station which provides access to both the Bakerloo and Overground lines. From the station you are a short walk to the amenities of Wealdstone High Street including supermarkets, chemist and the local gym. The property is also within the catchment area to the Marlborough Primary School which is rated Outstanding by OFSTED.





- *Two bedroom top floor purpose built flat*
- *Gas central heating and Double glazed windows*
- *Residents parking permits available*
- *Offered for sale in very good order throughout*
- *Modern kitchen and bathroom fittings*



Additional Information

TENURE. LEASEHOLD

LOCAL AUTHORITY. LONDON BOROUGH OF HARROW

ENERGY EFFICIENCY RATING. D

Ground Floor

Approx. 77.1 sq. metres (830.3 sq. feet)

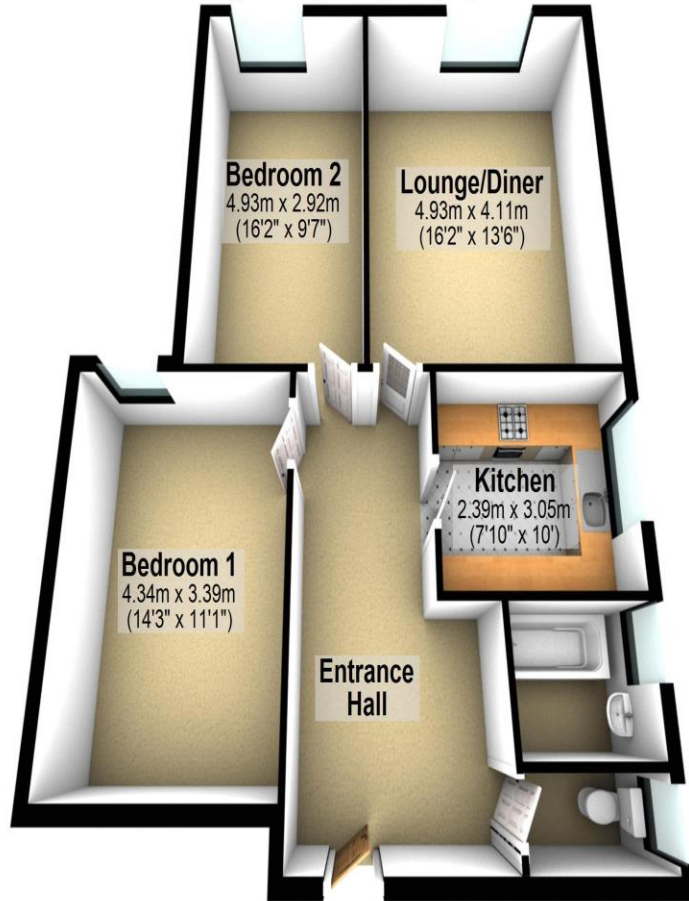

Total area: approx. 77.1 sq. metres (830.3 sq. feet)



We have not sought to verify the legal title of the property, the existence of planning permissions and/or building regulation approvals and have been unable to check the working condition of any services or appliances.

Property layouts are for general guidance and are not drawn exactly to scale. Measurements are taken at the widest points and bays, alcoves, wardrobes etc. may not be shown.