

Road Map



Hybrid Map



Terrain Map

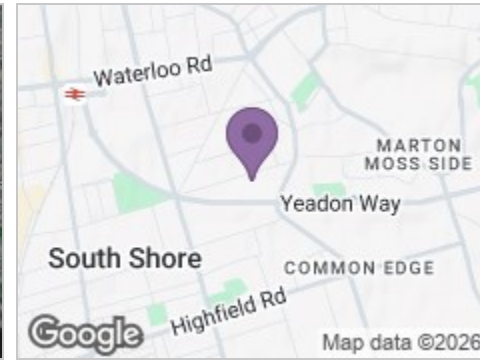

Floor Plan

Ground Floor

Approx. 31.3 sq. metres (337.0 sq. feet)

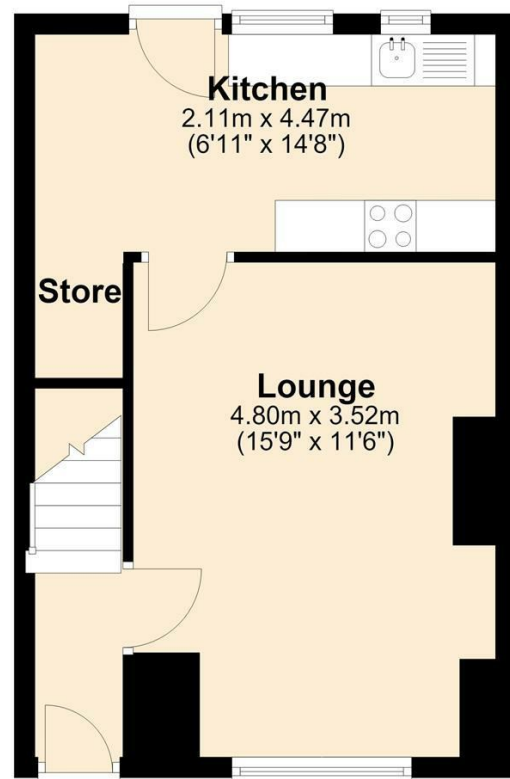

First Floor

Approx. 28.2 sq. metres (303.9 sq. feet)

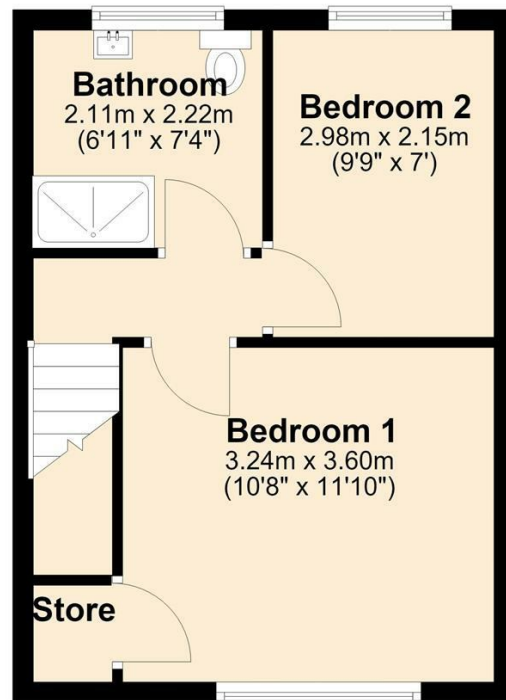

3 Sowerby Avenue

, Blackpool, FY4 3EH

£825 Per Month



Viewings

Please contact our iMove Sales & Lettings Office on 01253 883311 if you wish to arrange a viewing appointment for this property or require further information.

These particulars, whilst believed to be accurate are set out as a general outline only for guidance and do not constitute any part of an offer or contract. Intending purchasers should not rely on them as statements of representation of fact, but must satisfy themselves by inspection or otherwise as to their accuracy. No person in this firm's employment has the authority to make or give any representation or warranty in respect of the property.

Energy Efficiency Graph

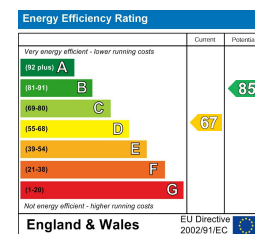

Make your next move with... **imove**

Call us now on **01253 883311**

hello@imove.today.co.uk



3 Sowerby Avenue

, Blackpool, FY4 3EH

£825 Per Month



Porch

Living room

UPVC double glazed window to front. Carpet, radiator, wall and ceiling lights

Kitchen

UPVC double glazed window to rear. UPVC door to rear leading to rear garden. Range of wall and base units with worktops above. Electric oven and hob. Stainless steel sink unit with mixer tap above. Plumbed for washing machine. Space for Fridge/Freezer

Bedroom 1

UPVC double glazed window to front. Carpet, radiator and ceiling light.

Bedroom 2

UPVC double glazed window to rear. Carpet, radiator and ceiling light.

Bathroom

Shower room with basin and W.C

External

Paved garden with shrubs and raised borders

Other information

iMove Lettings (Fylde) Ltd are members of The Property Ombudsman for Residential Lettings redress scheme
Please note a holding deposit of £50 per applicant will be required to reserve the property. The terms of the holding deposit will be set out in writing before payment of this is requested.

Central Heating
Council Tax Band A - Blackpool Council
EPC - D

