



16 Denbeck Wood, Eastleaze, Eastleaze, SN5 7EL
£210,000

SWINDON
HOMES 
sales, lettings & mortgages

**** CALLING ALL INVESTORS AND FIRST TIME BUYERS ****

Swindon Homes are pleased to market this two double bedroom, mid -terraced property situated in a quite cul-de-sac in Eastleaze, Swindon.

The accommodation comprises; living room, kitchen, two double bedrooms and bathroom. Further benefits include gas central heating, double glazed windows and doors, an enclosed rear garden and allocated parking to the front of the property.

The property is close to local bus routes , shops and schools.

Front Garden

Path to front door with lawn either side, open porch with storage cupboard housing gas and electric meters, front door.

Lounge / Diner

15'9" x 13'2" (4.80m x 4.01m)

Part glazed uPVC front entrance door, storage cupboard, double glazed window to front aspect, radiator, wall mounted flame effect electric fire, spiral staircase, door to kitchen.

Kitchen

7'4 x 13'2" (2.24m x 4.01m)

Double glazed window and half glazed uPVC door to rear aspect. A modern fitted kitchen with a selection of white units to both eye and base level, matching work tops and part tiled walls, stainless steel sink unit with mixer tap over, washing machine, fridge/ freezer, table top dishwasher. stand alone cooker with gas hob and extractor over.

Stairs to first floor.

From lounge spiral staircase to first floor landing, doors to both bedrooms and bathroom.





Bedroom One

8'22" x 13'2" (2.44m x 4.01m)

Double glazed window to front aspect, radiator, wardrobe and chester draws, sliding door to landing.

Bedroom Two

7'5" x 13'2" into 10'3" (2.26m x 4.01m into 3.12m)

Double glazed window to rear aspect, radiator, storage cupboard, sliding door to landing.

Bathroom

7'2" x 4'5" (2.18m x 1.35m)

A modern white suite comprising low level WC, panelled bath with mixer tap and shower attachment, shower screen, pedestal wash basin, radiator, extractor fan, wall cabinet, part tiled walls., access to insulated loft space.

Rear Garden

a low maintenance rear garden consisting small patio with step up to stepping stones to storage sheds, cotswold stones to either side. enclosed by wooden fencing.

Parking

Allocated paring to the front of the property plus on street parking if needed.



GROUND FLOOR

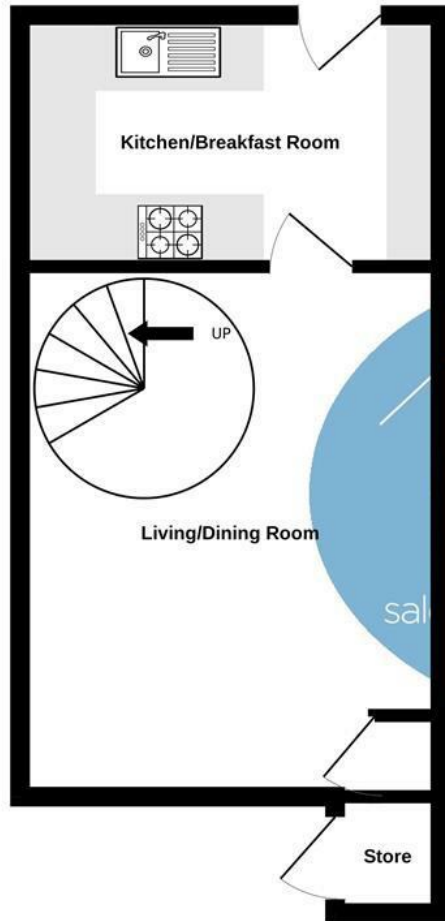

1ST FLOOR

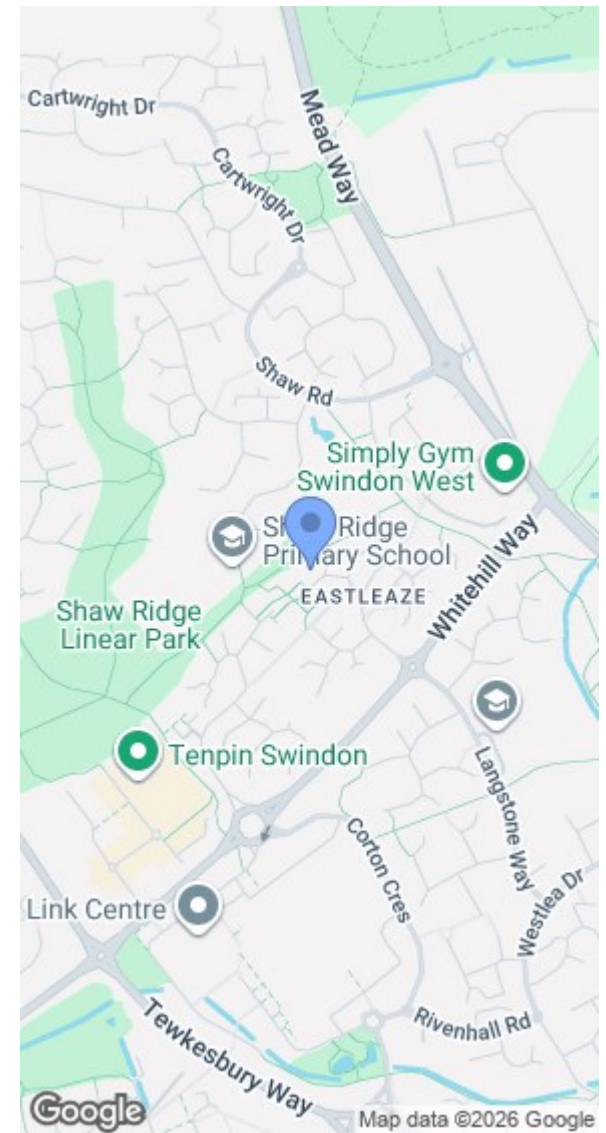
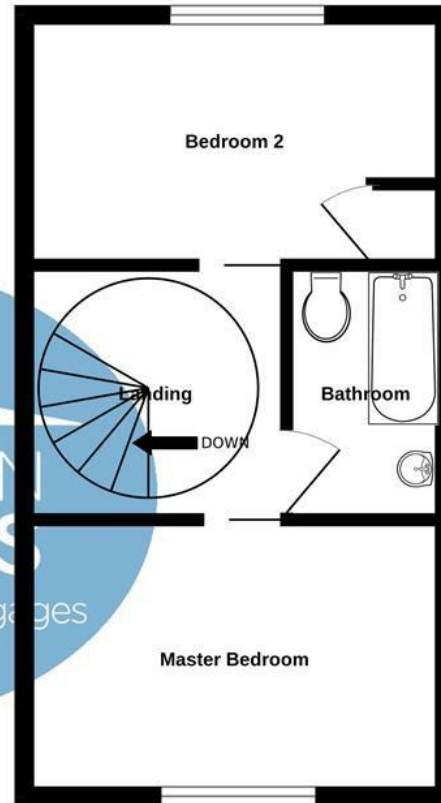

Whilst every attempt has been made to ensure the accuracy of the floorplan contained here, measurements of doors, windows, rooms and any other items are approximate and no responsibility is taken for any error, omission or mis-statement. This plan is for illustrative purposes only and should be used as such by any prospective purchaser. The services, systems and appliances shown have not been tested and no guarantee as to their operability or efficiency can be given.
Made with Metropix ©2024

Energy Efficiency Rating		Environmental Impact (CO ₂) Rating			
	Current	Potential		Current	Potential
Very energy efficient - lower running costs			Very environmentally friendly - lower CO ₂ emissions		
(92 plus) A			(92 plus) A		
(81-91) B			(81-91) B		
(69-80) C			(69-80) C		
(55-68) D			(55-68) D		
(39-54) E			(39-54) E		
(21-38) F			(21-38) F		
(1-20) G			(1-20) G		
Not energy efficient - higher running costs			Not environmentally friendly - higher CO ₂ emissions		
England & Wales		EU Directive 2002/91/EC		England & Wales	
				EU Directive 2002/91/EC	