



**POOLE
TOWNSEND**

Margate Street, Walney, Barrow-in-furness, LA14 3AF

£159,950

🛏️ 2 🚿 1 🚗 1



- 2 Bed Terraced House
- In A Sought-After Residential Area
- Close To Local Amenities
- Access To A Rear Garden
- Featuring A Spacious Kitchen
- A Cosy Lounge
- Glazed Doors Leading To A Conservatory Extension
- Two Generously Sized Double Bedrooms
- A modern Family Shower Room
- Offering Naturally Bright And Comfortable Living Space



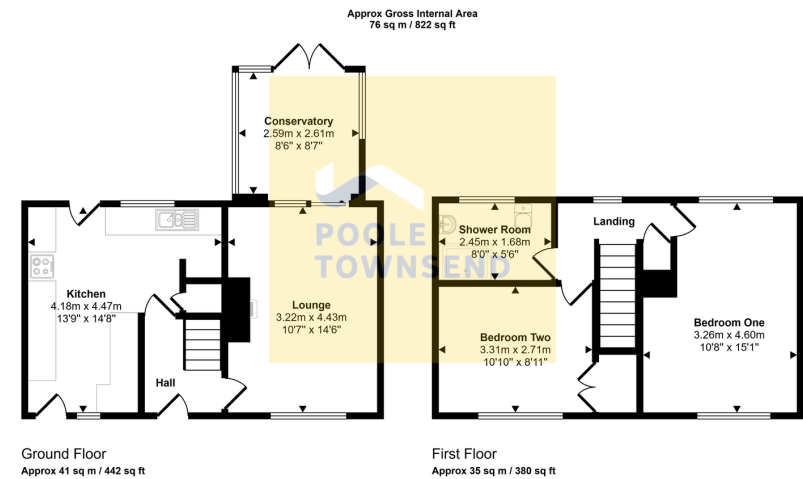

This floorplan is only for illustrative purposes and is not to scale. Measurements of rooms, doors, windows, and any items are approximate and no responsibility is taken for any error, omission or mis-statement. Icons of items such as bathroom suites are representations only and may not look like the real items. Made with Made Snappy 360.

NEW! This well-presented mid-terraced home is located in a sought-after residential area, ideally positioned for a range of local amenities. These include St Columba's School just across the road, convenient bus links, Vickerstown Park, as well as a nearby health centre and pharmacy. The property offers naturally bright and comfortable living space, featuring a spacious kitchen and a cosy lounge with a gas fire. Glazed doors lead through to a charming conservatory extension, which enjoys views over and direct access to the rear garden. Upstairs, there are two generously sized double bedrooms along with a modern family shower room. Externally, the home benefits from a large lawned garden with established planted borders, along with a patio seating area, perfect for alfresco dining and relaxation.

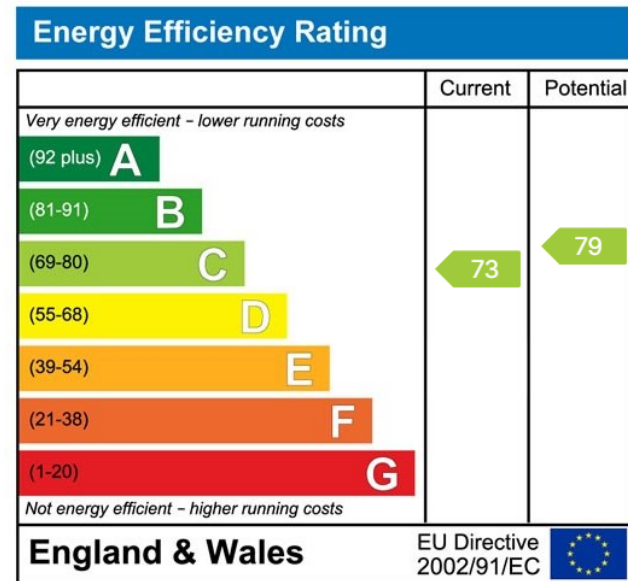

Visit us at
www.pooletownsend.co.uk
enquiries@pooletownsend.co.uk

We are open
 Monday – Friday 9.00 – 5.00
 Saturday 9.00 – 1.00

Barrow 01229 811811
 Ulverston 01229 588111
 Grange 015395 33316
 Kendal 01539 734455
 Milnthorpe 015395 62044