

Coed Derw, Rhuddlan Road, Bodelwyddan, Denbighshire, LL18 5UN

£310,500

 2  1  2



A detached bungalow with lovely views from the rear, overlooking open countryside. Available with no forward chain. The property offers plenty of potential with spacious accommodation including lounge, separate dining room, kitchen plus utility, conservatory, two double bedrooms and a large bathroom. It is understood that some rooms may have original Parquet flooring, hidden by carpeting. The generous plot comprises lawns to front and rear, a wide driveway, a detached garage and two timber sheds, all benefitting from a rural outlook. Situated on the outskirts of Bodelwyddan village and accessed via a private road, the bungalow is set back from the main road and enjoys seclusion, yet is only moments from Glan Clwyd Hospital, local shops, regular bus services and the A55 Expressway.

Key Features

- Detached bungalow
- Rural views
- Kitchen and utility room
- Ample parking and garage
- Council tax band - E
- No forward chain
- Two double bedrooms
- Lawn gardens
- EPC rating - E
- Freehold

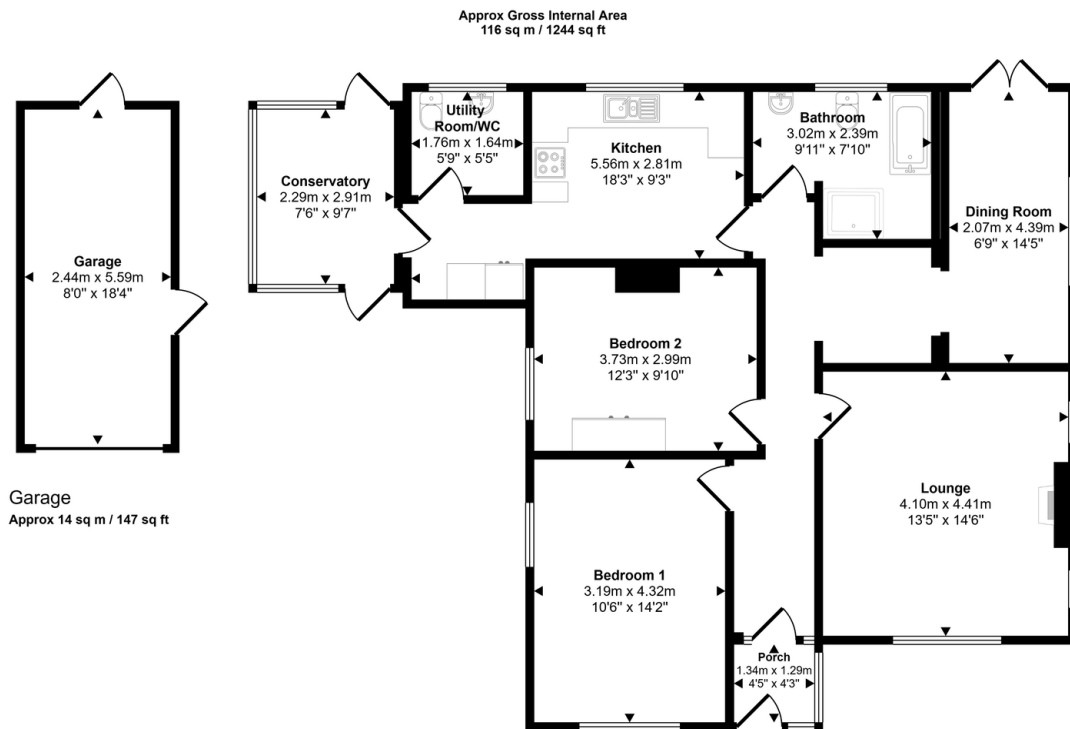

Floorplan
Approx 102 sq m / 1098 sq ft

This floorplan is only for illustrative purposes and is not to scale. Measurements of rooms, doors, windows, and any items are approximate and no responsibility is taken for any error, omission or mis-statement. Icons of items such as bathroom suites are representations only and may not look like the real items. Made with Made Snappy 360.