



Breakspears Road, SE4

£3,600 Per calendar month

**Dexters**



## Breakspears Road, SE4

A beautifully presented three bedroom, two bathroom, ground floor Victorian conversion. The property has been refurbished to a high specification throughout and benefiting from off-street parking, side access and a landscaped private garden. The property is located within the sought-after Brockley Conservation Area.

Offering a balance of period character and contemporary design, the property comprises a spacious open-plan kitchen/reception room with bi-folding doors leading directly onto the private landscaped garden, creating an ideal space for entertaining. Further benefits include underfloor heating, bespoke storage and off-street parking.

Breakspears Road is a highly sought after road in the Brockley Conservation area with excellent transport links from Brockley, St Johns and Ladywell train stations.

### Features

- Ground Floor Flat
- High Specification
- Victorian Conversion
- Off-Street Parking
- Private Landscaped Garden
- Brockley Conservation Area







Breakspears Road,  
London, SE4

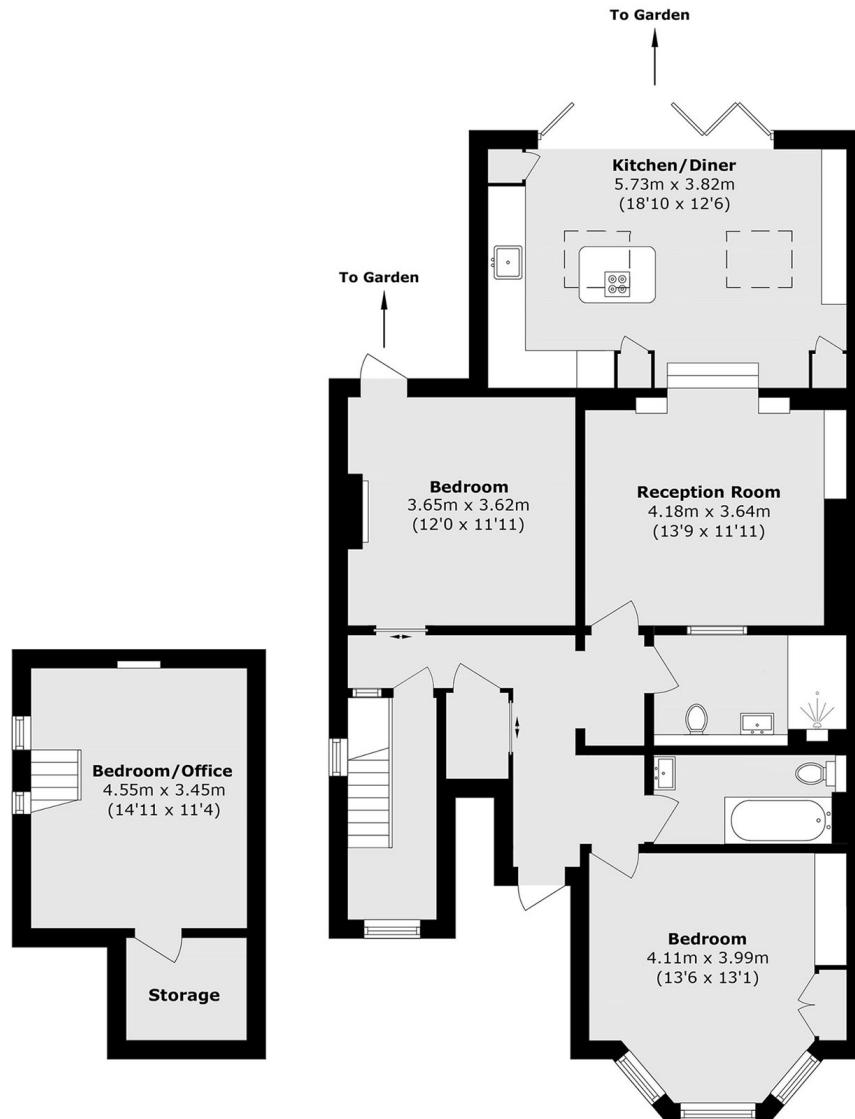

**Lower Ground Floor**

**Ground Floor**

Total area (approx.): 113.5 sq. m (1221.7 sq. ft)