



Halsnead Hall Close, Whiston, Knowsley

£1,350 PCM

Welcome to Fox Wood Garden Village, a brand-new community offering a stylish collection of 3 & 4 bedroom homes to rent in the charming village of Whiston.

The Gosford is a well-proportioned 3-bedroom, 2-bathroom home that blends space, style and smart design, ideal for modern living.

Step into a welcoming entrance foyer, where stairs lead to the first floor. Continue through to the heart of the home and you'll find a bright, front-facing living room, perfect for cosy evenings or relaxed weekend downtime. A central hallway connects the living space to the rear, complete with a handy under-stairs storage cupboard and a convenient downstairs WC.

At the back of the property, a contemporary kitchen and dining area spans the full width of the home. With French doors opening onto the turfed rear garden and patio, it's the ideal spot for entertaining or enjoying a bit of sunshine.

Upstairs, a central landing leads to three well-sized bedrooms. The main bedroom sits at the front and benefits from its own en-suite for that added touch of comfort. A sleek family bathroom sits in the centre, finished with modern white sanitaryware and chrome fittings, while to the rear you'll find a double bedroom and a versatile single room, ideal for a nursery, dressing room or home office.

Externally there is a rear garden, plus a private driveway with electrical vehicle charging point already installed! The property also benefits from solar panels to help keep those energy bills down!

Location wise, you can't go wrong! Families will appreciate the excellent choice of nearby schools, including Whiston Willis Primary Academy and Halsnead Primary School, both within easy reach. For retail therapy, Cables Retail Park and Liverpool Shopping Park are just a short drive away, offering a great mix of high street brands and everyday essentials. Alder Hey, Broadgreen, St Helen's and Whiston Hospitals are also close by.



3 Halsnead Hall Close, Whiston, Knowsley, L35 3AG

For those commuting, the M62 is nearby and Whiston train station is less than a mile from your door, giving you direct links to Liverpool, Manchester and beyond, perfect for work or weekend plans.

Fox Wood Garden Village is more than just a place to live, it's a growing, well-connected neighbourhood. With green spaces, walking trails and local attractions like Stadt Moers Park and Blundell Hill Golf Course close by, you can enjoy the great outdoors without going far.

Images and floorplan are demonstrative of this property type. The images and floorplan are therefore not plot or site specific and spec may vary slightly. Properties are let unfurnished.



GROUND FLOOR
411 sq.ft. (38.2 sq.m.) approx.

1ST FLOOR
411 sq.ft. (38.2 sq.m.) approx.

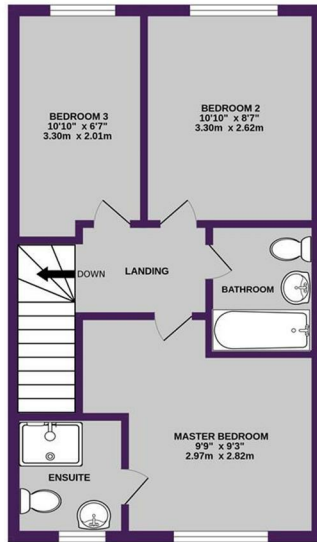
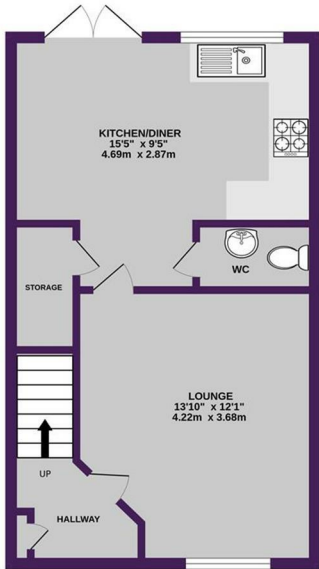

TOTAL FLOOR AREA : 821 sq.ft. (76.3 sq.m.) approx.

Whilst every attempt has been made to ensure the accuracy of the floorplan contained here, measurements of doors, windows, rooms and any other items are approximate and no responsibility is taken for any error, omission or mis-statement. This plan is for illustrative purposes only and should be used as such by any prospective purchaser. The services, systems and appliances shown have not been tested and no guarantee as to their operability or efficiency can be given.
Made with Metropix v2025

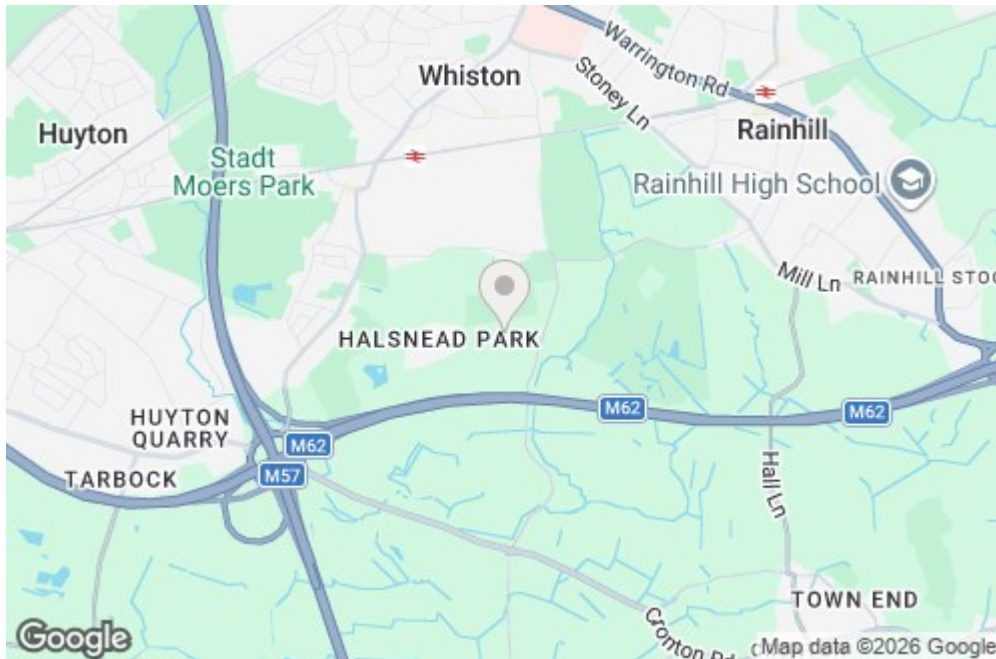

Energy Efficiency Rating		Environmental Impact (CO ₂) Rating	
Current	Potential	Current	Potential
90	90	B	B
85	85	C	C
80	80	D	D
75	75	E	E
70	70	F	F
65	65	G	G