



BOWEN DRIVE, SE7

£450,000

Flat
Two bedrooms
Two bathroom
Modern
Balcony
Energy rating: B



ABOUT THE PROPERTY

Spacious two bedroom top floor apartment, neutrally decorated and offering modern living throughout. Features include a private west facing balcony with panoramic London views, two generous bedrooms with en suites, an open plan living/kitchen area, a modern bathroom, and ample built-in storage. The property also benefits from approximately five years remaining on its NHBC warranty for added peace of mind.

London Bridge is 15 minutes by train from Westcombe Park, with North Greenwich (Jubilee Line) a 10 minute bus ride away. Greenwich town centre and Greenwich Park are also about a 25 minute walk.



STEP INSIDE BOWEN DRIVE

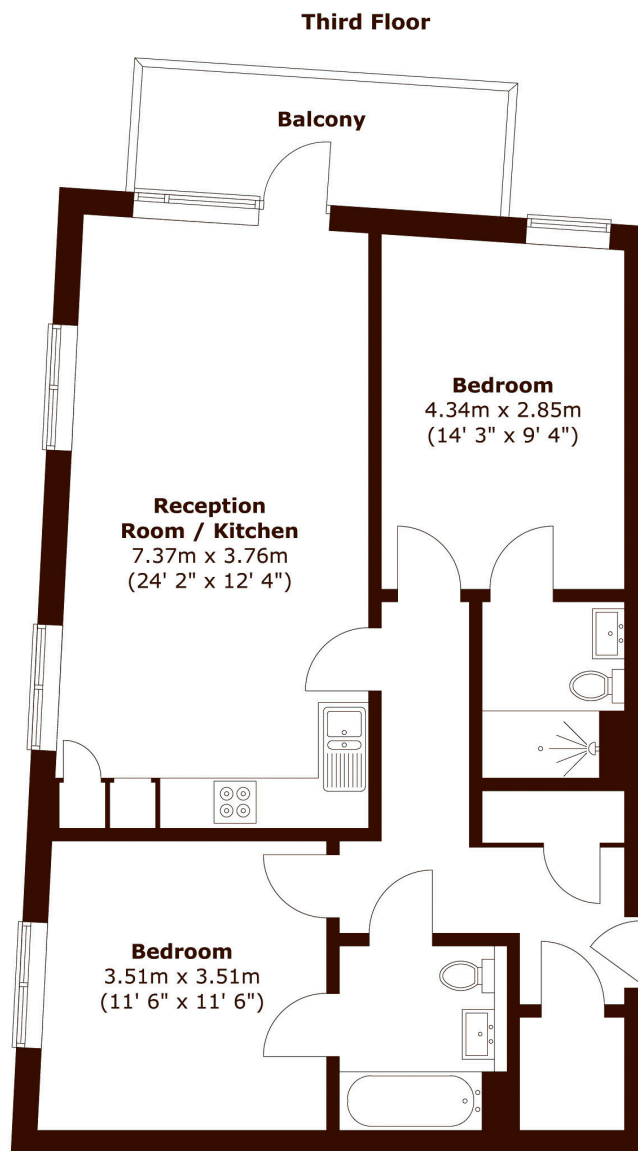

Total area (approx.) : 74.7 sq. m (804 sq. ft)
Total balcony area (approx.) : 6.8 sq. m (73 sq. ft)

Charlton
020 8293 0454

Energy Rating: B We aim to make our particulars both accurate and reliable. However, they are not guaranteed; nor do they form part of an offer or contract. If you require clarification on any points then please contact us, especially if you're traveling some distance to view. Please note that appliances and heating systems have not been tested and therefore no warranties can be given as to their good working order

**MARSH &
PARSONS**