



SIBLEY PARES

CHARTERED SURVEYORS & ESTATE AGENTS

Poplar Grove

Allington, Maidstone, Kent, ME16 0AE

£450,000 No Onward Chain

Poplar Grove

Allington, Maidstone, Kent, ME16 0AE

Key Features

- Three Bedroom Semi-Detached Family Home
- Two/Three Reception Rooms
- Downstairs Shower Room
- Large Private Rear Garden
- Sought After Location
- Prime Residential Location

Description

Rare opportunity to purchase this exceptionally spacious three bedroom family home in a sought after established residential area, with no onward chain.

The property comprises large entrance hall, fitted kitchen, spacious living room with feature fireplace opening through to a dining room with patio doors to the rear garden, a second reception room with bay window, downstairs shower room, primary bedroom with bay window, 2nd double bedroom, a third double bedroom and family bathroom.

Externally the property has a driveway with parking for multiple vehicles and double tandem garage, private rear garden featuring a greenhouse and shed.



Poplar Grove

Allington, Maidstone, Kent, ME16 0AE

Location

Situated in Allington, the area features a range of local amenities including a Waitrose supermarket, Post Office and Library and is in the catchment area for a number of well-regarded primary and secondary schools.

The M20 motorway is approximately a mile away and Maidstone town centre approximately two miles, which offers the benefit of three mainline rail stations.

■ EPC Rating TBC

■ Council Tax Band D

■ Maidstone Borough Council

■ For Broadband Speed Refer to Ofcom Website

For all Viewings and Enquiries contact:



Mr Mitchell Bourner
mitchell.bourner@sibleypares.co.uk



Mr Marcus Monger
marcus.monger@sibleypares.co.uk



SIBLEY PARES

CHARTERED SURVEYORS & ESTATE AGENTS

01622 673086

sibleypares.co.uk





Floorplan and Dimensions

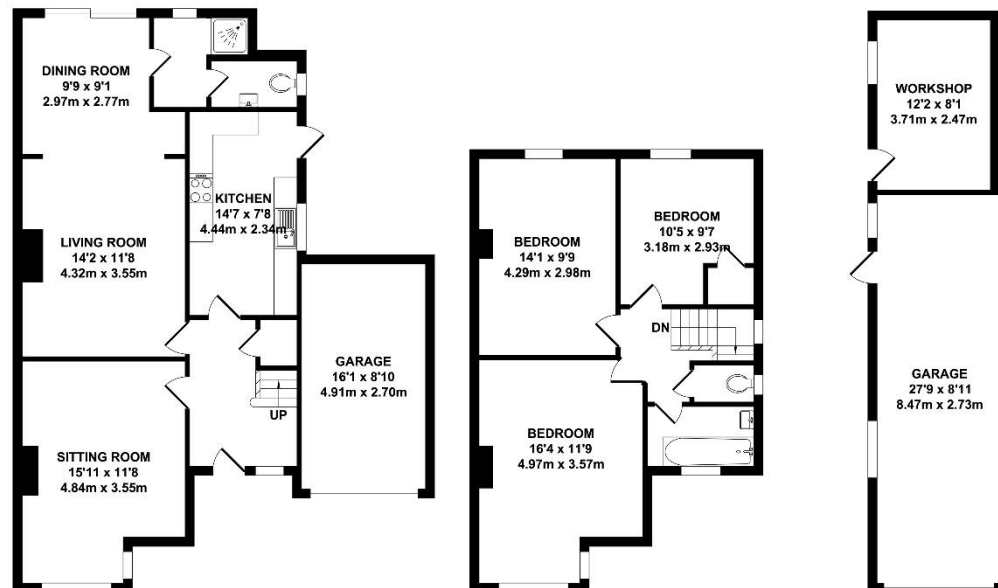

GROUND FLOOR
APPROX. FLOOR AREA
851 SQ.FT.
(79.02 SQ.M.)

FIRST FLOOR
APPROX. FLOOR AREA
516 SQ.FT.
(47.91 SQ.M.)

OUTBUILDING
APPROX. FLOOR AREA
350 SQ.FT.
(32.53 SQ.M.)

TOTAL APPROX. FLOOR AREA 1716 SQ.FT. (159.46 SQ.M.)

Whilst every attempt has been made to ensure the accuracy of the floor plan contained here, measurements of doors, windows, rooms and any other items are approximate and no responsibility is taken for any error, omission or mis-statement. This plan is for illustrative purposes only and should be used as such by any prospective purchaser. The services, systems and appliances shown have not been tested and no guarantee as to their operability or efficiency can be given.

Zome Media ©2025

NOTE: Rental, prices or any other charges are inclusive of VAT unless otherwise stated.

MISREPRESENTATION ACT 1967. These particulars are believed to be correct, their accuracy cannot be guaranteed and are expressly excluded from any other contract. Any intending purchaser must satisfy himself by inspection or otherwise as to the correctness of each of the statements contained in these particulars. No fittings, appliances or services mentioned have been tested by Sibley Pares. Please note that In accordance with Money Laundering Regulations, we are now required to obtain proof of identity for purchasers.



1 Ashford Road, Maidstone, Kent ME14 5BJ
sibleypares.co.uk | Maidstone (01622) 673086 | Ashford (01233) 629281

Partners: Sarah Raggett, BSc (Hons) MRICS | Phillip Hubbard, BA (Hons) MRICS
Sibley Pares Chartered Surveyors is a trading name of Sibley Pares LLP

Registered in England and Wales No: OC400776. | Registered as above. | VAT Reg No: 218 5130 30.