



Hanstone Close, Cirencester, Gloucestershire.

£160,000 Leasehold



43a, Hanstone Close, Cirencester, Gloucestershire.

Directions

Please use the postcode GL7 1WX or call the office at any time for detailed directions from your location.

Summary

A smart, well-presented first floor apartment with a lovely leafy outlook, generous proportions and the kind of practical benefits that make day-to-day living easy. With allocated parking for two, a long lease and low running costs, this is a home that makes just as much sense on paper as it does in person. Light, calm and quietly tucked away, yet moments from Cirencester town and local amenities, it strikes that rare balance between convenience and feeling a little removed from it all.

Step inside

The entrance hall offers a warm welcome and a natural flow through the apartment. To one side, the dining area sits open to the kitchen, creating a sociable space that works well whether it's everyday living or hosting. The kitchen itself is neatly fitted with a good range of storage, appliance space and an integrated NEFF dishwasher, everything where you need it without overcomplicating things.

The living room is a particularly appealing space, well proportioned and centred around a box bay window that frames a green, leafy outlook. The apartment is said to enjoy sunshine throughout the day, and this room really makes the most of it, feeling bright, comfortable and easy to settle into.

The bedroom is a generous double, complete with built-in storage, keeping things simple and uncluttered. The bathroom has been refitted to a high standard and adds a touch of quality, with a clean, contemporary finish that lifts the whole feel of the home.

Underfloor heating continues from the hall, giving this already smart space a welcome sense of everyday luxury.



Step outside

Externally, the property continues to deliver. There is allocated parking for two vehicles, along with a designated bin storage area, all practical and well thought through. While there is no formal garden, the current owner has created a charming planted area with pots and greenery, a lovely little touch that adds personality and could easily be continued or enhanced. Beyond that, a nearby green space and park just the other side of the trees offers an easy escape outdoors whenever you need it.

Area insight

Positioned in Chesterton, this is a location that continues to be popular for good reason. You have straightforward access into Cirencester town centre, along with a range of local amenities close by, making everyday life easy.

At the same time, the surrounding green spaces and quieter residential setting give it a more relaxed feel, ideal for those wanting convenience without the constant pace of the town centre itself. It's a spot that works just as well for first-time buyers as it does for downsizers or investors looking for a solid, well-located home.

Additional services

As a local family business, we have built relationships with many other local companies and are therefore happy to provide referrals for conveyancing, financial advisor, contractors, and anything else you may require.

Agents Note

We wish to inform prospective purchasers that we have prepared these sales particulars as a general guide. We have not carried out a survey, nor have we tested any services, appliances or any specific fittings at the property. Room sizes should not be relied upon for carpets and furnishings.

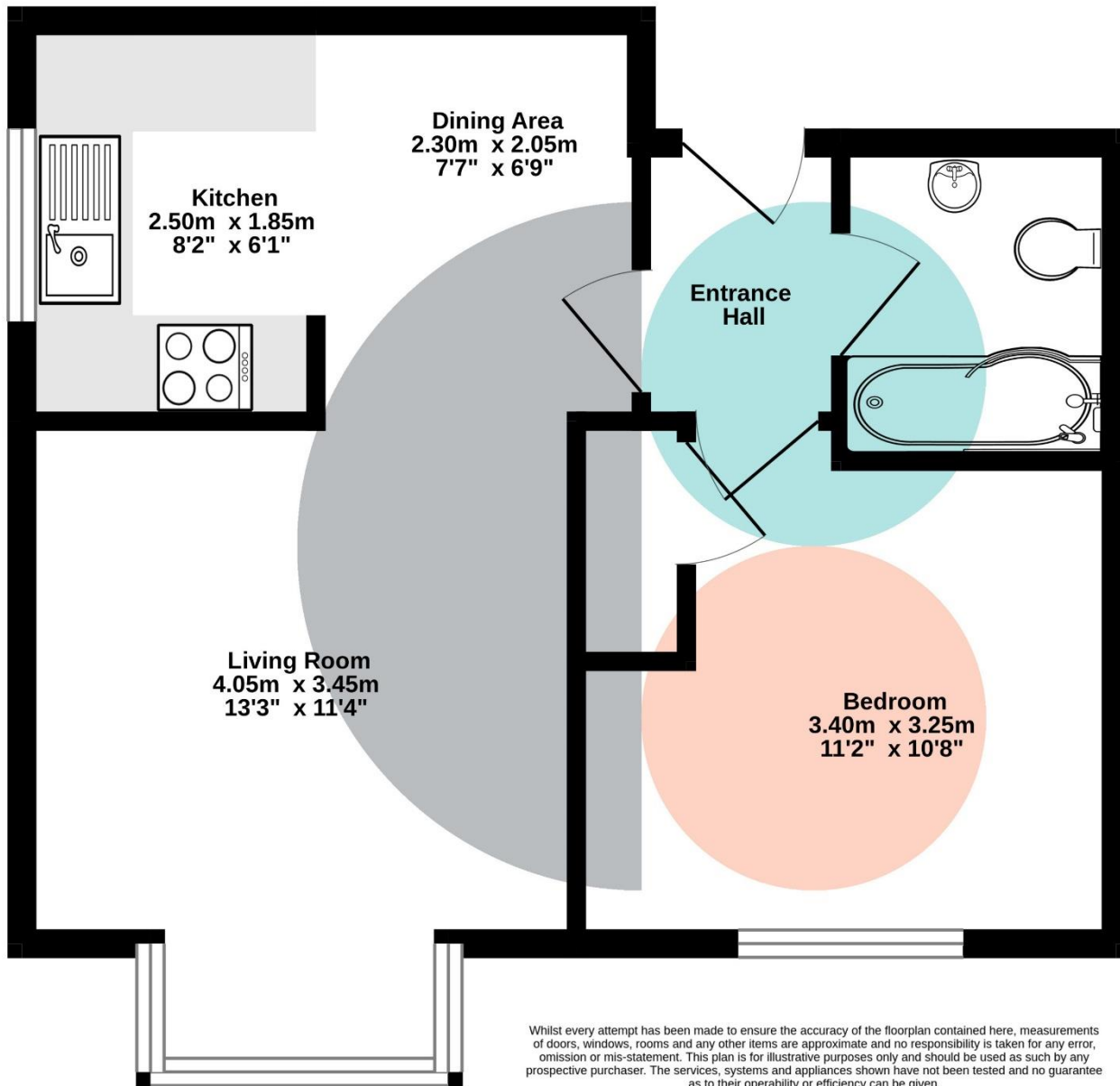

Whilst every attempt has been made to ensure the accuracy of the floorplan contained here, measurements of doors, windows, rooms and any other items are approximate and no responsibility is taken for any error, omission or mis-statement. This plan is for illustrative purposes only and should be used as such by any prospective purchaser. The services, systems and appliances shown have not been tested and no guarantee as to their operability or efficiency can be given.
Made with Metropix ©2026





01285 885555 01793 750793
hello@christianbenjamin.property

ChristianBenjamin.Property