



jordan fishwick

Lea Road Hayfield High Peak



Lea Road Hayfield High Peak SK22 2HE

£340,000



The Property

Backing onto fields with a glorious open aspect to both front and rear, a lovely three bedroom semi-detached family home. Located in popular Hayfield with large gardens, detached double garage and off road parking for two cars, this extended property must be viewed. Well presented throughout and improved by the current owners to include a stunning new dining kitchen. Comprising: entrance porch, hall, living room, open plan dining kitchen with quartz worktops, conservatory, three first floor bedrooms with built in wardrobes and a modern white bathroom.



- Lovely Three Bedroom Semi Detached Property
- New Open Plan Modern Dining Kitchen with Quartz Worktops
- Stunning Open Views to Front and Rear
- Detached Double Garage and Driveway Parking for Two Cars
- Living Room and Conservatory
- Good Sized Enclosed Rear Garden with Large Lawn and Patio Area
- Popular Location in Hayfield Village
- Modern White Bathroom

Postcode SK22 2HE

EPC Rating E

Local Authority High Peak

Council Tax C

| Energy Efficiency Rating | | |
|---|---|-----------|
| | Current | Potential |
| Very energy efficient - lower running costs | | |
| (92 plus) A | | |
| (81-91) B | | 85 |
| (69-80) C | | |
| (55-68) D | | |
| (39-54) E | 43 | |
| (21-38) F | | |
| (1-20) G | | |
| Not energy efficient - higher running costs | | |
| England & Wales | EU Directive 2002/91/EC  | |



GROUND FLOOR
813 sq.ft. (75.6 sq.m.) approx.



1ST FLOOR
378 sq.ft. (35.1 sq.m.) approx.

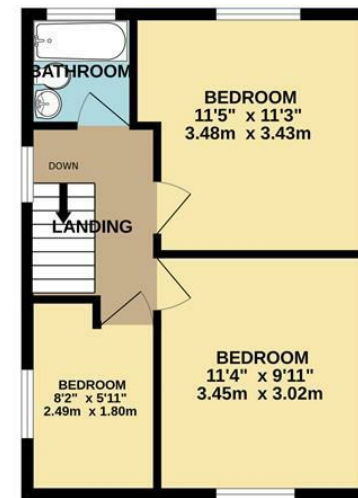

TOTAL FLOOR AREA : 1191 sq.ft. (110.7 sq.m.) approx.

Whilst every attempt has been made to ensure the accuracy of the floorplan contained here, measurements of doors, windows, rooms and any other items are approximate and no responsibility is taken for any error, omission or mis-statement. This plan is for illustrative purposes only and should be used as such by any prospective purchaser. The services, systems and appliances shown have not been tested and no guarantee as to their operability or efficiency can be given.
Made with Metropix ©2026



These particulars are believed to be accurate but they are not guaranteed and do not form a contract. Neither Jordan Fishwick nor the vendor or lessor accept any responsibility in respect of these particulars, which are not intended to be statements or representations of fact and any intending purchaser or lessee must satisfy himself by inspection or otherwise as to the correctness of each of the statements contained in these particulars. Any floorplans on this brochure are for illustrative purposes only and are not necessarily to scale.

Offices at: Chorlton, Didsbury, Disley, Hale, Glossop, Macclesfield, Manchester Deansgate, Manchester Whitworth Street, New Mills, Sale, Wilmslow and Withington

14 Market St, Disley, Cheshire, Stockport SK12 2AA

01663 767878

disley@jordanfishwick.co.uk

www.jordanfishwick.co.uk